

SL-FLEX-DUO17W-*
Silicon Stripe for LED Stripes

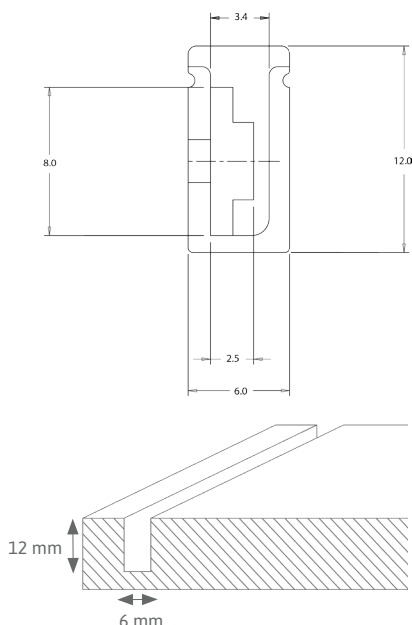

Because of the complex production process of LED products the shown values are only statistical representations which deviate from lamp to lamp but not in a significant manner.



PRODUCT PROPERTIES

- » silicon profile for SIRO LED stripes with 8 mm width
- » can be milled into or built onto solutions
- » continuous and soft light
- » light is emitted from the side
- » variation of color temperature from 2700K to 6000K
- » soldered input cable (500 mm) with SIRO MONO plug
- » controllable and dimmable with SIRO SL-REC02DUO receiver as well as SIRO SL-REC01 // SL-REC03DUO receiver

TECNICAL SPECIFICATIONS

- » nominal power:..... 16,8 W/m
- » nominal voltage:..... 24V DC
- » beam angle (non-directional):..... 110°
- » operating temperature:..... -25° - +60° C
- » storage temperature:..... -40° - +80° C

PHOTOMETRIC SPECIFICATIONS

- » rated luminous flux:..... 1450 lm/m
- » nominal luminous flux:..... 1450 lm/m
- » flux with silicon profile:..... 484 lm/m
- » color temperature:..... 2700 - 6000K
- » color rendering index Ra:..... >95
- »LED-type..... SMD Microchip
- »LED per meter:..... 196

DIMENSIONS

- » width: 6 mm
- » height:..... 12 mm
- » installation width: 6 mm
- » installation depth: 12 mm

AVAILIABLE LENGHTS

- » SL-FLEX-DUO17W-450:..... 450 mm
- » SL-FLEX-DUO17W-600:..... 600 mm
- » SL-FLEX-DUO17W-900:..... 900 mm
- » SL-FLEX-DUO17W-1200:..... 1200 mm
- » SL-FLEX-DUO17W-1500:..... 1500 mm
- » SL-FLEX-DUO17W-2000:..... 2000 mm
- » SL-FLEX-DUO17W-2500:..... 2500 mm
- » SL-FLEX-DUO17W-3000:..... 3000 mm

SL-NT24CV20W-DB1

Power supply 20 watt white



PRODUCT FEATURES

- „Power supply 20 Watt incl. 2 m connection cable
- „Short circuit protection
- „Over load protection
- „ 6 compartment distribution box for connection of 24V DC SIRO Receiver and 24V DC MONO Led products without control

TECHNICAL DATA

- » Light type: LED
- » Input voltage: 220 - 240 VAC
- » Output voltage: 24V DC
- » Output current: 0,83 A
- » Power: 20 Watt
(10% reserve recommended)
- » Efficiency:
- » Standby P:
- » No-load power P_{no}:
- » Networked standby power P_{net}:
- » Protection class: IP20
- » Power frequency input: 50Hz bis 60Hz
- » Housing color: weiß
- » Ambient temperature: -20° - +45° C
- » Safety: Short circuit protection, overload protection

DIMENSIONS & WEIGHT

- » Length: 140 mm
- » Width: 48 mm
- » Height: 14,5 mm
- » Weight in G:

SL-NT24CV60W-DB1
Power supply 60 Watt

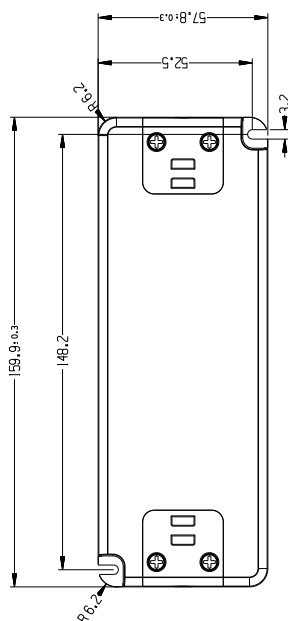
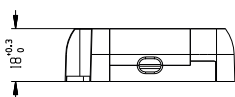

PRODUCT FEATURES

- „Power supply 60 Watt incl. 2 m connection cable
- „ low stand-by consumption < 0,5 W
- „Short circuit protection
- „Over load protection
- „ 6 compartment distribution box for connection of 24V DC SIRO Receiver and 24V DC MONO Led products without control

TECHNICAL DATA

- » Light type: LED
- » Input voltage: 220 - 240 VAC
- » Output voltage: 24V DC
- » Output current: 2,5 A
- » Power: 60 Watt
(10% reserve recommended)
- » Efficiency: 88 %
- » Standby P: 0,44 W
- » No-load power P_{no}: 0,46 W
- » Networked standby power P_{net}: 0,46 W
- » Protection class: IP20
- » Power frequency input: 50Hz bis 60Hz
- » Housing color: white
- » Ambient temperature: -20° - +45° C
- » Safety: Short circuit protection, overload protection

DIMENSIONS & WEIGHT

- » Length: 159,9 mm
- » Width: 57,8 mm
- » Height: 18,0 mm
- » Weight in G: 260,0 g

2 AREA CONTROLLER

Product Data Sheet

SL-SZ2DUO

Controller for SIRO REC02DUO Receiver



PRODUCT PROPERTIES

- » 2 area controller for SIRO DUO LED products
pro area the you need one SL-REC02MONO receiver
- » dim function (10 - 100%)
- » battery powered type CR 3032
- » can be combined with SIRO sensory products
- » assembled by screws or glue pads
(glue pads are included in delivery)

TECNICAL SPECIFICATIONS

SL-SZ2DUO-K60
weiß // white

SL-SZ2DUO-K1
schwarz // black



battery powered CR 3032



RoHS  

Can **not** be disposed into domestic waste.

SIRO Beschläge- und
Metallwarenfabrik
Ges.m.b.H.
Spielfeldstraße 12

4452 Ternberg
Austria
Tel . +43 (0)7256.6020.0
Fax . +43 (0)7256.8932

E-Mail office@siro.at
Web . www.siro.at
© 2019 Alle Rechte
vorbehalten.

SL-REC02DUO

RF Receiver for DUO light products

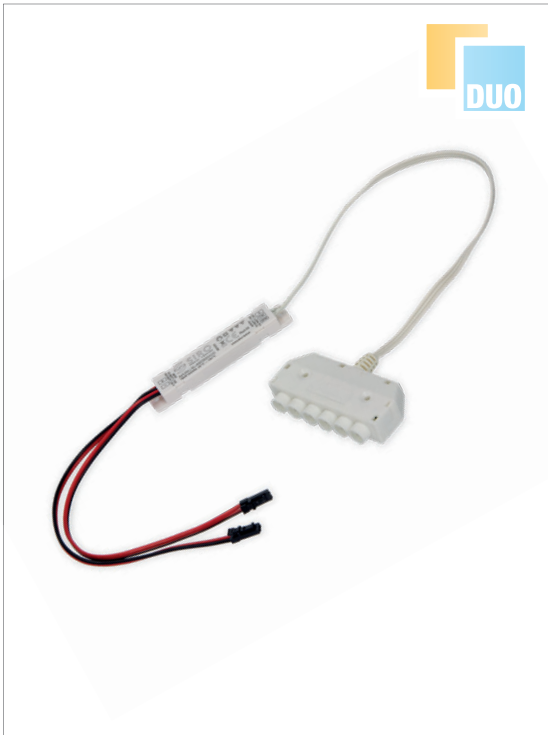

PRODUCT PROPERTIES

- » control of SIRO DUO LED light products with 2 area controller (SL-SZ2DUO)
or sensors (SL-MAG35 // SL-PIR35 // SL-TOUCH35)
- » can be controlled by up to 8 controllers
- » small, compact construction, ideal for furniture lighting
- » quick and simple installation through ready to plug system
- » wireless range up to 10 meters

TECNICAL SPECIFICATIONS

- » Input:..... 12-24 VDC
2 x 300 mm connection cable with SIRO Mono plug
max 3 A per cable
- » output:..... 144 W / 24V DC
6-socket distributor box with 300 mm
connection cable for SIRO DUO light products

DIMENSIONS

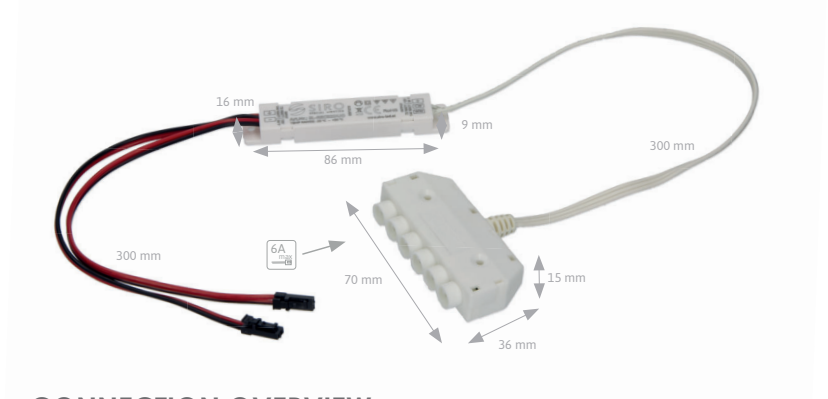

CONNECTION OVERVIEW

