

**FITTING, USAGE AND MAINTENANCE INSTRUCTIONS**  
**IMPORTANT** Please read carefully

**PART: 3588**

**PRODUCT** 3.5T UNIVERSAL COUPLING

**D Value**

**S Value**

**Approval number**

17.5kN

250kg

E11\*7768\*00

**WARNING** 

**Accessories which are not properly fitted can be dangerous, with the potential for serious injury or damage. All accessories must be fitted and maintained by professionally competent persons.**

It is the responsibility of the vendor to ensure compatibility between all approved products i.e ensures that the towing vehicle, tow bar and coupling device have the correlating S Value, D Value and requisite class designation. If in doubt, contact the manufacturer of the respective product.

**EU Approved Products - Legal Requirements**

- Only fit EU type approved products to European type approved towing brackets (see approval no. above) and ensure that their S & D Values are equal to or greater than the S & D Value of the towing bracket.
- This is a European type approved accessory (see approval no. above). If fitting to a European type approved towing bracket ensure that the S & D Value of the towing bracket is equal to or less than the accessories S & D Value.
- When fitting an accessory, whether EU approved or not, to a non-EU type approved towing bracket, refer to the towing bracket manufacturer's instructions and adhere to the towing capacities as stated in the vehicles manufacturer's handbook.

**FITTING INSTRUCTIONS**

**Torque Settings**

| Bolt Size | Bolt Length | Bolt Grade  | Nut Grade | Torque Setting    |
|-----------|-------------|-------------|-----------|-------------------|
| M8 ( )    |             |             |           |                   |
| M10 ( )   |             |             |           |                   |
| M12 ( )   |             |             |           |                   |
| M16 ( X ) |             | 8.8 minimum | 8 minimum | 240Nm recommended |

**A calibrated torque wrench must be used.**

**Warning** 

**Before fitting, ensure that all bolt/nut/washer contact surfaces are free from excess paint, dirt, under-seal, weld splatters etc.**

GWAZA LTD  
New House Farm, Shoothill, Shrewsbury, Shropshire, SY5 9NR  
Tel: 01743 850761 Fax: 01743 850601 Email: sales@gwaza.co.uk



**Warning** 

When fully tightened, the equivalent of half the bolt diameter must protrude through the nut. Use fasteners with vibration proof washers under the nut or use self-locking nuts.

**Fitting:**

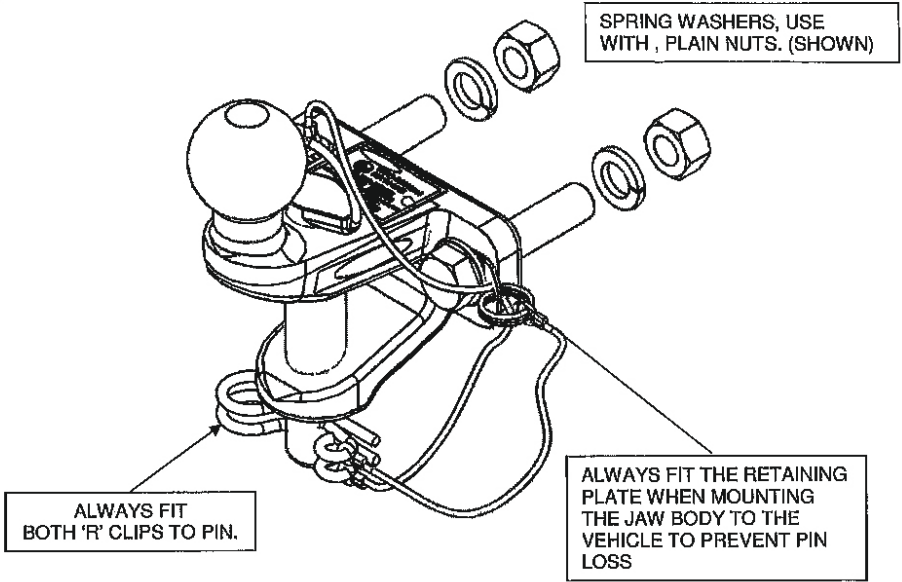

**Towing Capacity**

“D” Value 17.5kN                      “S” Value 250kg  
GTM: 3500kg.  
Applies to tow ball and jaw.

**USAGE, MAINTENANCE, SAFETY**

- Using a calibrated torque wrench, check tightness of all bolts/nuts initially after the first 500 miles (800km) of towing, and then at 1000 mile (1600km) intervals.
- Check regularly all moving/contact parts for signs of wear and replace if necessary.

**USER RESPONSIBILITY**

It is your responsibility to ensure that you have been instructed in the safe usage, operation, and maintenance of this product. Please ensure that these instructions are passed to subsequent owners/users of this product.

GWAZA LTD  
New House Farm, Shoothill, Shrewsbury, Shropshire, SY5 9NR  
Tel: 01743 850761 Fax: 01743 850601 Email: sales@gwaza.co.uk

