

BMBS 220 x 250 H-G / BMBS 220 x 250 CNC-G

Hydraulic swivel frame metal-cutting band saw for mitre cuts of up to +60°. CNC-G: Fully-automatic

Manual

Automatic

- ▶ For sawing, e.g., stainless steel, tool steel, hollow sections and full materials
- ▶ Horizontally swivelling saw arm
- ▶ 2-pole saw band motor with saw band speeds of 30 and 65 m/min.
- ▶ Saw band tension monitoring - electro-mechanically via micro-switches
- ▶ When the saw arm lifts, the solenoid valve locks the lowering cylinder in top position, thus removing the need for additional locking on the cylinder
- ▶ Saw arm tilted by 25° for a longer saw band service life
- ▶ Precise and sturdy band guides with adjustable tungsten carbide plates
- ▶ After completing the cutting action, the saw band automatically stops in the bottom end position.
- ▶ Saw arm lowering through gravity or manually (H-G only)
- ▶ With continuously variable, constant saw arm lowering speed via hydraulic cylinder (H-G only)
- ▶ A fully-hydraulic system controls both vices, the material feed movement and the saw arm work steps (CNC-G only)

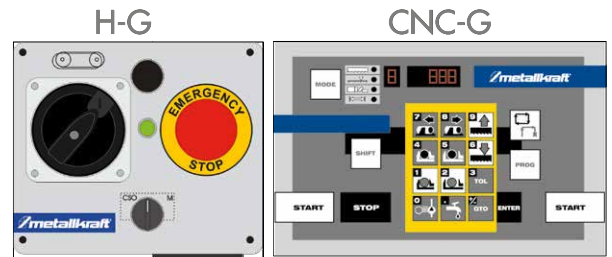

! For an exhaustive explanation of the controls, see pages 205 – 209

! For an exhaustive explanation of the controls, see pages 205 – 209



BMBS 220 x 250 H-G

Scope of supply

- ▶ Saw band
- ▶ Coolant pump
- ▶ Operating tool
- ▶ Adjustable stop (for H-G only)
- ▶ Swarf clearing brush (for CNC-G only)



BMBS 220 x 250 CNC-G

! We are always happy to perform sample cutting for your material. Call us for details!

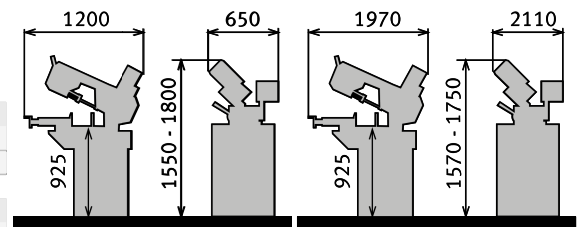

BMBS 220 x 250 H-G

BMBS 220 x 250 CNC-G

Model	BMBS 220 x 250 H-G	BMBS 220 x 250 CNC-G
Art. no.	3680001	3690066
Technical specifications		
Motor output 3 x 400 V/50 Hz	0.75-1.1 kW	0.75-1.1 kW
Speed stages	2	2
Saw band speeds	30/65 m/min.	30/65 m/min.
Saw band dimensions	2450 x 27 x 0.9 mm	2450 x 27 x 0.9 mm
Dimensions (L x W x H) in mm	1200 x 650 x 1800	1970 x 2110 x 1800
Table height material feed	925 mm	925 mm
Weight	270 kg	550 kg
Max. feed length for 1 x feed unit	-	500 mm
Min. remaining workpiece length CNC operation	-	250 mm**
Transport packaging flat rate*	TPFR 4 = € 79.00	

* Please turn over for descriptions of the packaging surcharges, data on TPFR excluding VAT. ** Recommended minimum value. This value can change depending on the weight of surface of the material to be cut.

Clamping range

mm	0°	45°	60°	^b / _a x ^b / _a
	220	160	90	X
	120 *	85 *	55 *	X
	230 x 190	160 x 90	90 x 90	230 x 120

* recommended values

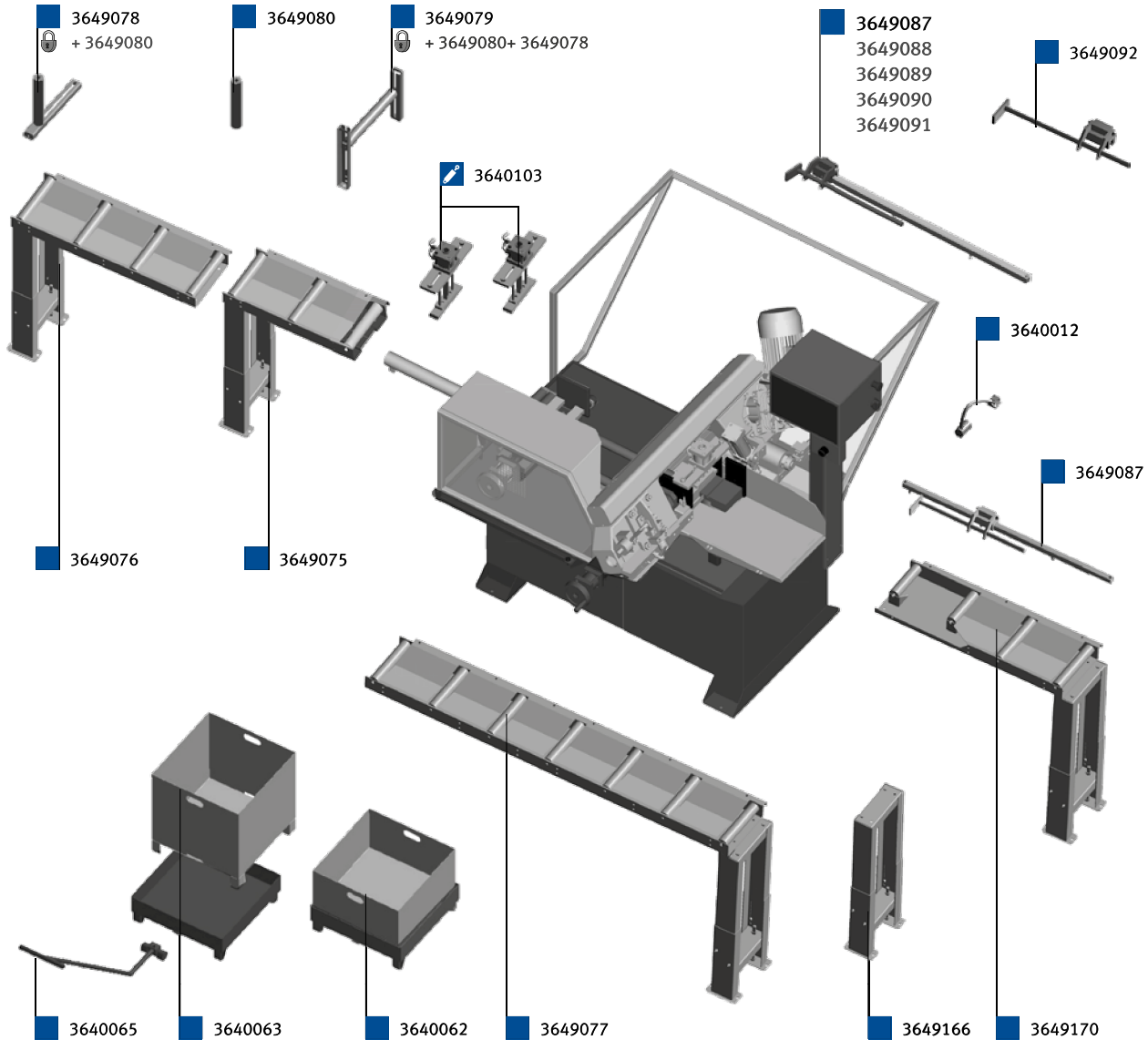
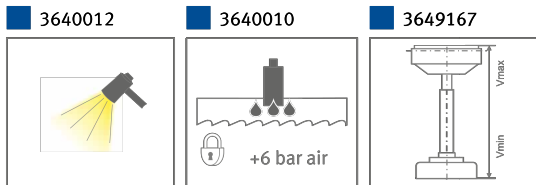

Optional accessories (only available from factory)	Art. no.
Micro-spraying system	3640010
Workplace lighting (for CNC-G only)	3640012
Motor + gearbox for cutting stainless steel (23/46 m/min.)	3640076
Accessories for CNC-G	
Workpiece container	3640062
Swarf container	3640063
Trolley for swarf container and workpiece container	3640065
Roller conveyors 290 mm (incl. legs)	
1000 x 290 mm, roller conveyor 200 kg/m	3649076
2000 x 290 mm, roller conveyor 200 kg/m	3649077
Connecting roller conveyor f. 60° cuts between saw and roller conveyor incl. connecting parts	3649170
700 x 290 mm feed roller conveyor (for CNC-G only)*	3649075

Accessories, roller conveyors 290 mm	Art. no.
lateral Steering roll 200 mm, mobile (requires: 3649080*)	3649078
lateral Guide roller 200 mm, rigid	3649080
Horizontal bundle clamping roller 290 mm (requires: 3649080* + 3649078*)	3649079
Additional leg for increasing the load bearing capacity	3649166
Roller support, height-adjustable, width 290 mm, load-bearing capacity 200 kg	3649167
1m folding stop with measuring scale (H-G only)	3649087
2m folding stop with measuring scale (H-G only)	3649088
3m folding stop with measuring scale (H-G only)	3649089
4m folding stop with measuring scale (H-G only)	3649090
5m folding stop with measuring scale (H-G only)	3649091
additional stop (H-G only)	3649092

M42 saw bands	Art. no.
2450 x 27 x 0.9 mm 5-8 tpi Sprint	3655122
2450 x 27 x 0.9 mm 10-14 tpi Sprint	3655123
2450 x 27 x 0.9 mm 3-4 tpi Sprint Plus	3655120
2450 x 27 x 0.9 mm 2-3 tpi Sprint Plus	3655121
2450 x 27 x 0.9 mm 4-6 tpi Sprint-Medium-VS	3655119

* must be ordered with your order!

More saw bands and info on page 283

When ordering a roller conveyor, always state whether you need a feed or discharge conveyor