

### General Warnings

- Before use inspect the climbers as per the section Before Use
- Use equipment for its intended purpose only
- Inspect your pads and straps for any cuts or abrasions which could cause a failure during use, any worn pads and/or straps should be replaced immediately.
- The gaffs are sharp and can cause serious injury, always keep body parts, loose clothing, and climbing systems (Ropes, Lanyards, Textile Products) away from the gaffs.
- Always use appropriate hand protection when handling the climbers.
- Kicking or jamming gaffs will cause unnecessary stress to the climber and should be avoided.
- Do not take large steps when ascending or descending. Doing so creates unnecessary stress to the climber.
- When not in use, the Climbers should be stored safely with gaff guards attached to avoid accidental injury
- Keep climber sets together. Fasten them together when they are stored or transported.
- Never climb with a mix matched set of climbers.
- Avoid walking on hard surfaces whilst wearing the Climbers. Doing so increases wear on the bottom of the climber which will decrease the life expectancy.
- Climbers should never be worn when working on ladders, in aerial lifts, while driving a vehicle or walking on rocky, hard, frozen, brushy or hilly terrain
- Bending in anyway will cause a weakening of the alloy which could lead to serious injury or death!
- Never alter the Climbers in any way or scratch or etch this product, doing so could result in weakening of the alloy.
- If this product is bent or damaged due to extended use or misuse, remove from service immediately and retire. DO NOT try to bend climbers back to their original position.
- Although climbers are not deemed as Personal Protective Equipment (PPE) The manufacturer recommends this product should be inspected prior to every use along with periodically independent inspection every 6-months.

Do not hesitate to retire a product showing signs of wear which might affect the strength, or restrict its operation. For your own safety we advise you adopt an inspection criteria for this product by a competent person. If you are not able, or not in a position to assume this responsibility, seek professional advice.

A record card should be kept for this product. This card should show the details of the product, its identification, model (SKU), serial number (If applicable), date of first use, date of purchase, date of manufacture, frequency of use, history of periodic examinations, who conducted examination, due date for periodic examination, and applications for which it is suitable with the name and contact details. We would advise to record the basic product details below incase the Product Identification Label is lost or damaged.

### Before Each Use

Climbers should be checked for but not be limited to the following before each use:

- Shanks are not cracked or damaged
- Gaffs are properly attached and not loose, cracked, or broken.
- Both gaff attachment screws are in place and are properly tightened.
- Gaff length, width, thickness, point profile, and sharpness of cutting edges should be inspected
- Climber straps are properly attached and in good condition.
- Check for cuts, kinks, abrasions, burns, excessive swelling, excessive wear, discoloration, charring, broken fibers, loose stitching, elongated holes, loose or damaged buckles or rivets or chemical or physical exposures, etc.
- Climber pads are properly attached and in good condition, inspect the hook and loop fastening to ensure that the hook and loop is not worn or excessively dirty and that it properly adheres to itself. Check the Pad & Strap Retainer fixings are tight and not loose.

If any evidence of excessive wear or deterioration as outlined is observed, immediately cease use and replace it with new equipment. Should any unusual conditions not outlined above be observed, or you have reasonable doubt about a particular condition, remove the equipment from service.

### Adjustment & Fitting

Properly adjusted climber pads should extend to roughly 50mm below the knee joint, this is not exact as each climber has their own preference to the correct position for comfort. The climber pad can also be slightly angled to change the comfort and feel. If the climbers don't fit correctly or are uncomfortable re-position the pad.  
To re-position the pad remove the inner comfort pad, unscrew the two retaining screws with the Hex Tool provided and re-position the threaded inserts into one of the other setting.  
**IMPORTANT:** Do not bend, cut drill or otherwise alter the shank, mountings or gaffs.

Carry the climbers to the base of the pole or tree. Remove gaff guards from the climbers and place them near the base of the pole or tree for attachment. Step each foot into the climbers with gaffs on the instep side of the foot. Adjust climber straps securely for optimum fit around your feet and legs. Straps should be snug but never so tight as to restrict circulation. After dismantling the pole or tree, immediately remove your climbers and re-place gaff guards over the gaffs. To minimize the danger of personal injury and / or damage to the equipment, never walk around while wearing climbers. Always store your climbers separately from other climbing equipment

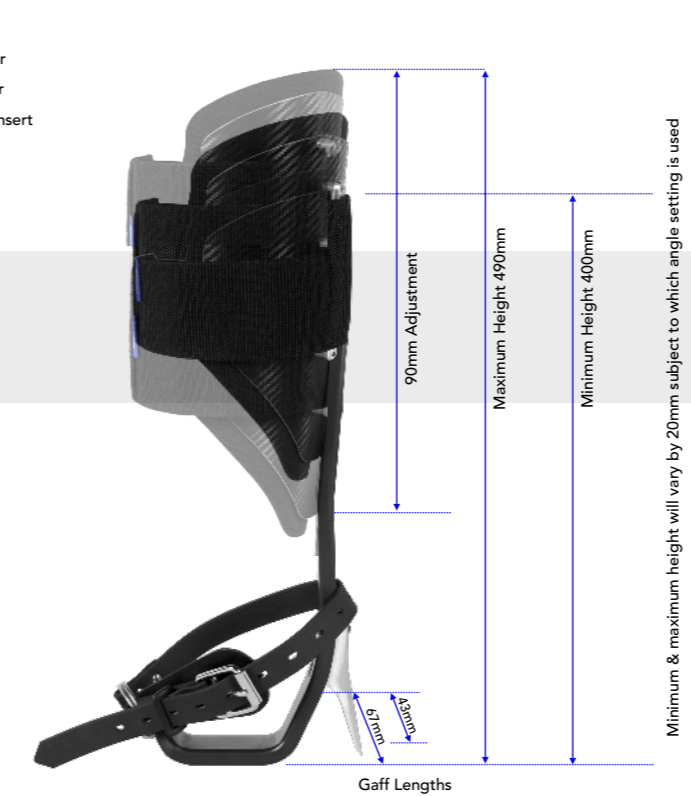
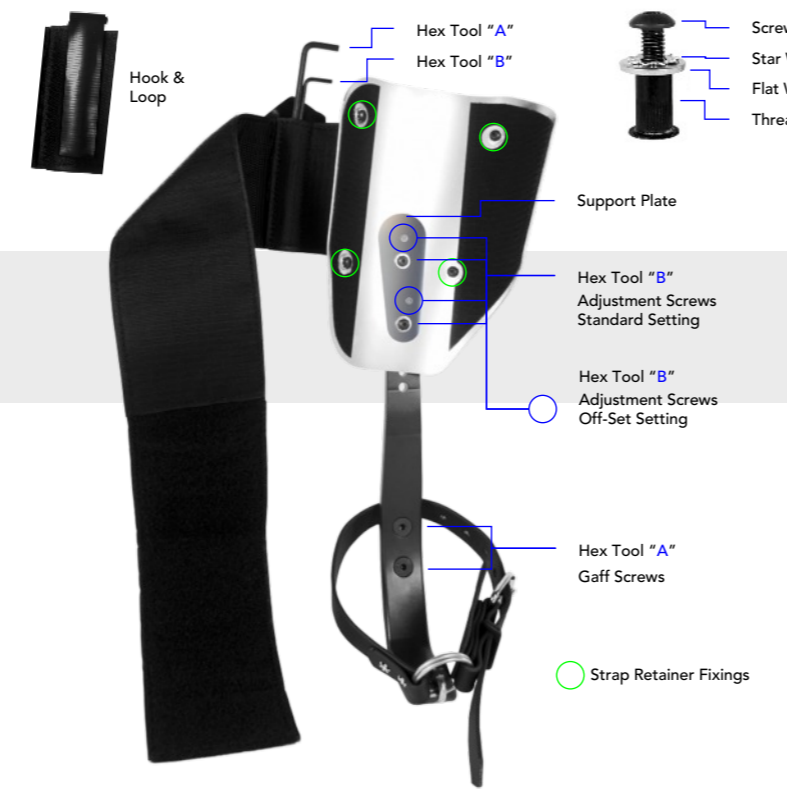
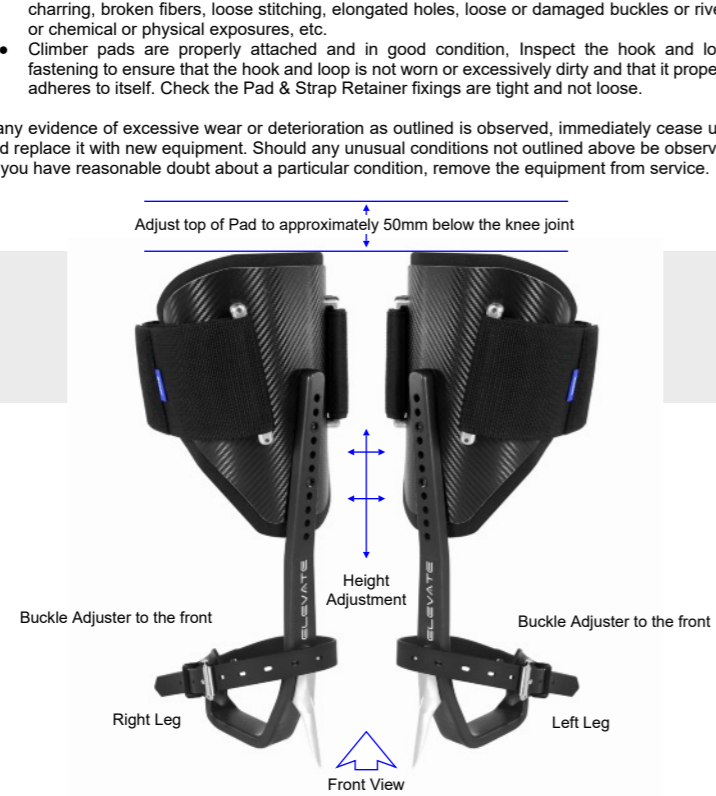

Minimum & maximum height will vary by 20mm subject to which angle setting is used

### Gaffs

Wear protective gloves as gaffs can be sharp  
To replace the gaffs secure the shank in a Bench Vice ensuring you do not over tighten the vice and damage the shank. Always use Vice Protection Grips to protect the shank. Using the supplied Hex Tool remove both the gaff screws.  
To fit new gaffs place the gaffs on the shank locating the lug into the corresponding hole on the shank. Hand tighten the bottom gaff screw (nearest the gaff tip). Repeat hand tightening on the top gaff screw. Tighten equally using the supplied Hex Tool ensuring both screws are sat level in the recessed holes of the shank. The length of the supplied Hex Tool allows you to achieve the recommended torque setting of 15nm.  
Note: use of a longer tool can exceed the 15nm recommendation and result in stripping and / or fracture of the screw head.  
Gaff attachment screws should be replaced after the first time removal, but if re-using, apply a low to medium strength thread sealant to prevent the screws from loosening. Screws may not be removable if a permanent type thread sealant is used.  
Sharpening: when re-sharpening the gaffs use a Flat File ensuring the original shape and angles are retained and not altered.



## GENERAL INSTRUCTIONS FOR USE

This User Instruction Manual contains valuable information which must be read and understood before the product is used. Failing to follow these guidelines for the correct use and care of the product may give rise to a situation that could endanger the user's life. The manufacturer cannot be liable for the abuse or misuse of safety equipment. All risk is the responsibility of the user.

This document must be provided to the customer by the retailer in the respective country's language and must be kept with the equipment whilst it is in service.

Before use, a detailed risk assessment must be carried out by a competent person to establish that this is the correct product suitable for the type of work being undertaken. The risk assessment must ascertain that this product configures with and is appropriate to the work being undertaken and that your anchor point conforms to industry standards and meets the requirements of EN795:2012, and that potential fall distance, obstructions, and rescue systems have been addressed. It is essential the appropriate Anchor Device is positioned above the user and the user should never ascend above the position of the Anchor Device.

Purchasers and users should seek professional training from a fully qualified and competent instructor prior to engaging in any activity using this equipment. If you are not able, or not in a position to assume this responsibility, do not use this product. The manufacturer its distributors and retailers do not accept any liability if users do not follow the instructions correctly.

### Important Notes:

- THIS PRODUCT SHOULD ONLY BE USED IN CONJUNCTION WITH A FULLY CONFIGURED CLIMBING SYSTEM AS PER INDUSTRY GOOD PRACTICE AND NOT BE USED FOR FREE CLIMBING
- This product is intended for use as part of a work positioning system and should not be used for fall arrest applications.
- Before use, the user must be suitably qualified to carry out a pre-use check
- It is essential that these instructions are read and followed
- This product should only be used by trained and/or otherwise competent persons or the user should be under the direct supervision of such a person.
- Users are warned that certain medical conditions such as heart disease, high blood pressure, vertigo, epilepsy, drug or alcohol dependence, could affect the safety of the user in normal and emergency use.
- Ensure before use that there is a suitable rescue plan to enable the retrieval of the user to a place of safety in the event of a fall or injury
- Never use this product for any other purpose other than that for which it is intended.
- This product is a personal item and is not recommended to be used by more than one user.
- Maximum weight limit of this product should not exceed 140kgs.
- Be aware of any possible dangers, which may arise through use of combinations of items of equipment in which the safe function of any one item is affected by or interferes with the safe function of another.
- It is essential for safety that the equipment is withdrawn from use immediately should: any doubt arises about its condition for safe use or if the equipment shows excessive wear or damage to any part or if it has been used to arrest a fall
- Dynamic loading or shock loading constitutes excessive wear and voids normal working loads. Retire from use immediately should this occur.
- Do not operate or carry this device near electrical power lines as it conducts electricity. Contact with power lines may result in injury or death. Never use in weather where there is a risk of lightning strikes. It should never be re-sold or re-distributed to any other users. The manufacturer cannot be held liable if the equipment has been abused or used incorrectly.

### Anchoring:

The system that incorporates this product should include a reliable anchorage point. It is essential the appropriate Anchor Device is positioned above the user and the user should never ascend above the position of the Anchor Device and that potential fall distance, obstructions, and rescue systems have been addressed. Anchors should meet EN795:2012 or be able to sustain a force of 12kN.

### Environment:

This product is intended for use in the human environment where the working temperature ranges from minus 10 Centigrade to 40 Centigrade. Working outside these temperatures and even within them brings certain risks. For example, wet webbing can freeze and become stiff. Heat can damage the webbing fibres externally these fibres will be melted or welded together, and visual inspection will reveal the damage.

### Cleaning:

Contamination can damage the physical properties of this product and all contamination should be avoided. Dilute reagents or dirt and effluent encountered in the human environment if contacting the product should be washed out by repeated immersion in clean water. If necessary, the product can be disinfected using a neutral proprietary textile disinfectant applied by using a lukewarm solution with agitation followed by rinsing in clean water and air drying in a naturally warm environment exceeding 20°C.

### Storage and Transport:

This product should be stored in a relaxed state. Dry the product or store it in free air circulation at room temperature. If stored in a dirty condition it can take on a smell, it is best to wash it first. Sunlight can degrade the product over time therefore ensure the webbing is protected. Long term exposure to strong sunlight should be avoided and the product stored under shelter. Any change in the fibres due to the effect of sunlight will appear as wear when visually inspected. During transportation the product should be protected in a bag to prevent contamination, protected from mechanical damage, extremes of temperature and other factors documented in this leaflet known to adversely affect the products condition.

### Product Care:

This product has been tested to conform to requirements of the Manufacturers Standards but once in use, it is the user's responsibility to ensure the on-going integrity of the product and to decide the correct time for obsolescence. Products containing wedding elements are susceptible to wear and tear and can be weakened to some extent by various agencies such as chemicals, heat and light. The following care notes must be read and understood so that the user has an appreciation of what can damage the integrity of the product and what to inspect for.

### External Wear and Repeated Loading:

Over-time the product will become worn from load holding, rubbing over abrasive surfaces. Typically, the higher the load the more wear will occur to the point of fixing and the result will be seen as damage to the fibres. This wear will appear as a matt finish to the area where fibres become broken. This is acceptable wear and will not initially diminish the products safe holding capacity. As wear increases the yarns may become broken. Before wear reaches this stage the integrity of the webbing is compromised, and it should be replaced. This visual inspection is a reliable procedure for webbing wearing in a normal safe load holding situation. Any mechanical damage to the webbing, crushing, cutting, burning, melting or pinching that has caused trauma to the construction may have compromised the integrity of the product. In this case the product should be retired from service immediately.

### Heat & Chemicals:

Heat may, in extreme cases, cause fusing. Any signs of this should merit rejection but the product may be damaged by heat without any such obvious warning. The best safeguard is proper care in use and storage. This product should never be dried in front of a fire or stored near a stove or other source of high heat. Acidic and alkali contamination should be avoided as it will over time reduce the strength of the fibres possibly leading to early discarding of the product.

### Inspection and Obsolescence:

This product should be checked before and after use by an experienced person to ensure continued serviceability. Use visual and tactile inspection to identify cuts, tears, abrasion damage and powdering due to ageing, contact with heat, acids, alkalis and other corrosives. If the product has been subjected to a fall, contamination, damage or abrasion and there is any doubt about the integrity of the product it should be taken out of use. Periodic examinations, taking account of such factors as legislation, equipment type, frequency of use, and environmental conditions. This should be carried out by a competent person at least every 6-months.

A record card should be kept for each product in use. This card should show the details of the product, its identification, model (SKU), serial number, date of first use, date of purchase, date of manufacture, frequency of use, history of periodic examinations, who conducted examination, due date for periodic examination, and applications for which it is suitable with the name and contact details.

The product should be the property of only one user and the record card shall be maintained by this user to ensure they are aware of the history of the product. The record card should also be used as a log to record the user's name, the date used and application, the conditions encountered in use and any relevant comments about the condition of the product. Knowing your product is essential to ensure safe working. Only use a product that is either new or has a known working life. A product can look good but have compromised properties. Discard unknown products as unsuitable for safe working. This product has a maximum recommended shelf life of 5 years if stored correctly (from date of manufacture). It is impossible to quantify a maximum recommended life in use as the damage this product is subjected to will depend on the manner and frequency of use.

### Use of this product:

It is not possible to cover every eventuality relating to the use of this product. Purchasers and users of these products should seek professional training from a fully qualified and competent instructor prior to use. If you are not able, or not in a position to assume this responsibility, do not use this product. The manufacturer its distributors and retailers do not accept any liability for its improper use.

Further copies of these User Instructions can be downloaded from our website [www.fletcherstewart.com](http://www.fletcherstewart.com)

### Manufacturer or authorized representative:

**Address & Contact Details**  
 Fletcher Stewart (Stockport) Ltd  
 Unit 8E, Newby Road Industrial Estate, Hazel Grove,  
 Stockport, Cheshire, SK7 5DA UK  
 Tel: +44 (0)161 483 5542

Web address : [www.fletcherstewart.com](http://www.fletcherstewart.com) - Email: [info@fletcherstewart.co.uk](mailto:info@fletcherstewart.co.uk)

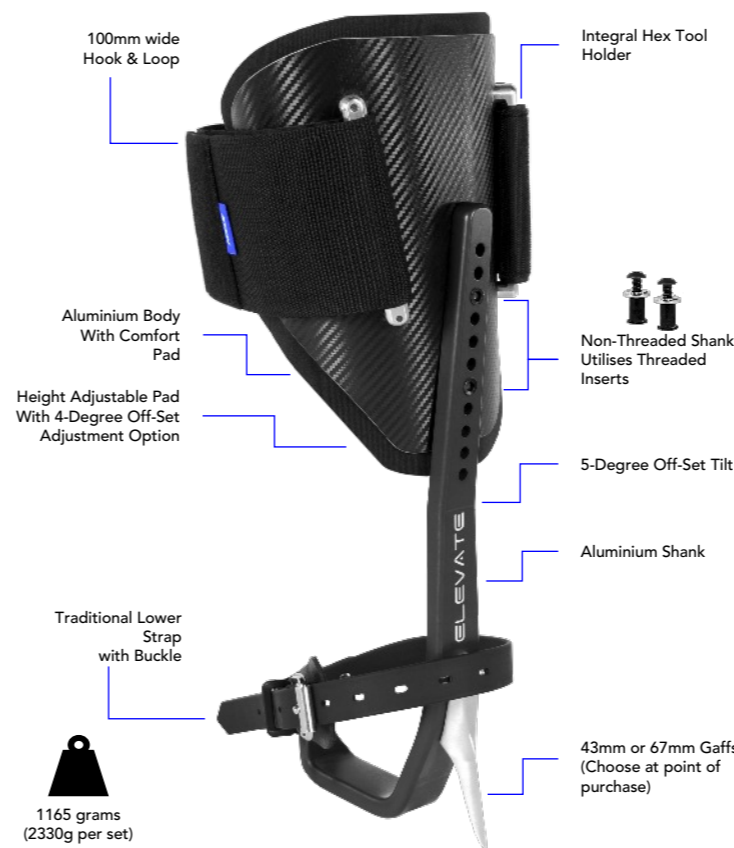

## Replacement Parts

Only genuine replacement parts should be used. These are available from STEIN Retailers. The manufacturer its distributors and retailers do not accept any liability should non-genuine parts be use.

Climbers   Spurs		
SS-46302K2043	ELEVATE Climber Kit - Fitted with 43mm Gaffs & Velcro Pads	BLUE
SS-46302K2067	ELEVATE Climber Kit - Fitted with 67mm Gaffs & Velcro Pads	BLUE
SS-46302K1043	ELEVATE Climber Kit - Fitted with 43mm Gaffs & Velcro Pads	BLACK
SS-46302K1067	ELEVATE Climber Kit - Fitted with 67mm Gaffs & Velcro Pads	BLACK
Climbers   Spurs Accessories		
SS-4630200010	ELEVATE - Lower Straps (x2)	Fit ELEVATE & X2 Climbers
SS-4630200012	ELEVATE - Inner Pads (x2)	
SS-4630200013	ELEVATE - Fixing Kit (x5)	
SS-4630200015	ELEVATE - Pad Set Blue (x2)	
SS-4630200016	ELEVATE - Pad Set Black (x2)	
SS-4630200043	ELEVATE - Gaffs 43mm (x2)	Fit ELEVATE & X2 Climbers
SS-4630200067	ELEVATE - Gaffs 67mm (x2)	Fit ELEVATE & X2 Climbers
SS-4610122115	ELEVATE - Gaff Guards	

## Notes

## Inspection Record

It is recommended that this product undergoes an in-depth inspection before it is used, periodically during use, and after each use. Do not hesitate to retire a product showing signs of wear which might affect the strength, or restrict its operation. For your own safety we advise you adopt an inspection criteria for this product by a competent person. If you are not able, or not in a position to assume this responsibility, seek professional advice.

A record card should be kept for this product. This card should show the details of the product, its identification, model (SKU), serial number (if applicable), date of first use, date of purchase, date of manufacture, frequency of use, history of periodic examinations, who conducted examination, due date for periodic examination, and applications for which it is suitable with the name and contact details.

We would advise to record the basic product details below for your Inspector.

Issued To (User Name)
Purchase Date
Date first used
Purchased from
Product Name
Gaff Size
Serial Number (if applicable)