



# euroscreen® Sesame 2.1

## SCREEN SURFACES



### Arctiq

Matt white front surface, fibre glass support, black-backed. Gain 1.0



### GreyLight

Grey front surface, fibre glass supported, black-backed. Gain 0.75



### Xpert

White front surface, black-backed. PVC free. Flame retardant (B1). Excellent surface flatness and colour temp. Gain 1,0.

## PROJECTION FORMATS

1:1

The screen format is 1:1. No black borders.

4:3

The screen has 5 cm wide black borders. The format of the viewing area is 4:3.

16:10

The screen has 5 cm wide black borders. The format of the viewing area is 16:10.

16:9

The screen has 5 cm wide black borders. The format of the viewing area is 16:9.

## CONTROL OPTIONS

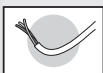

### Installation

5m cable. Needs to be installed by electrician. This is included as standard.

Euroscreen® Sesame 2.1 is an upgrade from the award winning, sophisticated recessed projection screen designed for installation in suspended or plastered ceilings. The model has a clever design of the bottom dowel which closes the case flush when the screen is not used, and the white aluminium case is equipped with unique removable end flanges for quick access and installation. The distinctive feature with a concealed drop function of screen section allows for installation in prepared ceiling cut-out later on during the construction process. The screen is stylish in its appearance with external flange profiles which are integrated with the case. Optional brackets for trouble-free installation in recessed ceilings are available.

## SCREEN DIMENSIONS

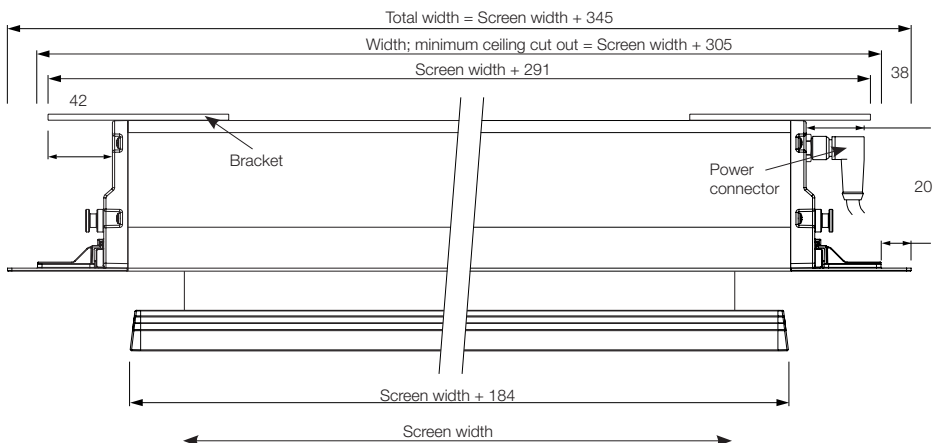

### Considerations regarding cut out width

Minimum cut out width: screen width + 305

Maximum cut out width: screen width + 343

Recommended cut out width: screen width + 325

## CASE DIMENSIONS

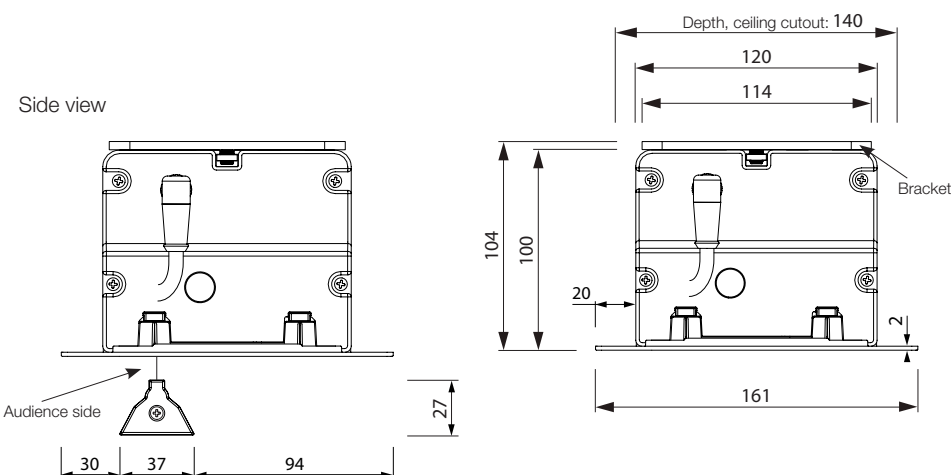

## ELECTRICAL SPECIFICATIONS

### Cable Specifications

Thickness:  $\varnothing$  7 mm  
 Cable area: 4x0,5mm<sup>2</sup> , motor to control  
 3x0,75mm<sup>2</sup> , control to plug  
 Wires: Black - Up  
 Brown - Down  
 Blue - Neutral  
 Green/Yellow - Ground

### Installation cable

Part no: 210673  
 Enclosed with the screen.  
 Weight: 0.40kg

### Motor Specifications

Voltage: 220 V      Frequency: 50 Hz  
 Power: 121 W      Momentum: 6Nm  
 Speed: 28 rpm      Protection: IP44

The motor is grounded.

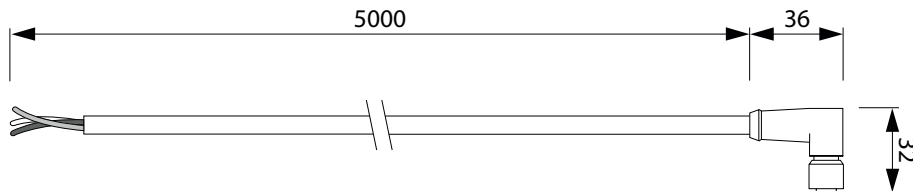

## BRACKET DIMENSIONS

Brackets are included in all Sesame products.

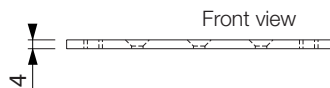
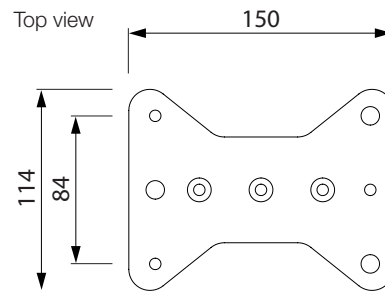
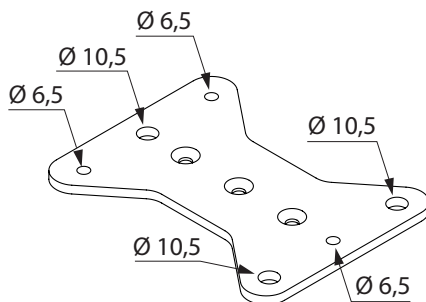

## PACKAGING DIMENSIONS

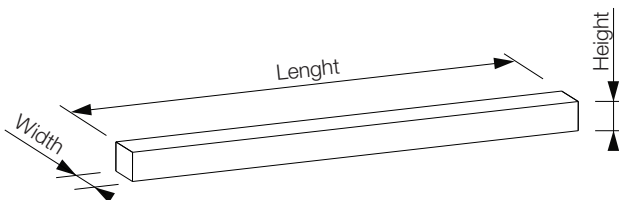

Screen width	Box length	Box width	Box height
1600	2040	245	250
1800	2240	245	250
2000	2440	245	250
2200	2640	245	250
2400	2840	245	250
2700	3140	245	250
3000	3440	245	250