

VLFL922000 Instruction Manual

1

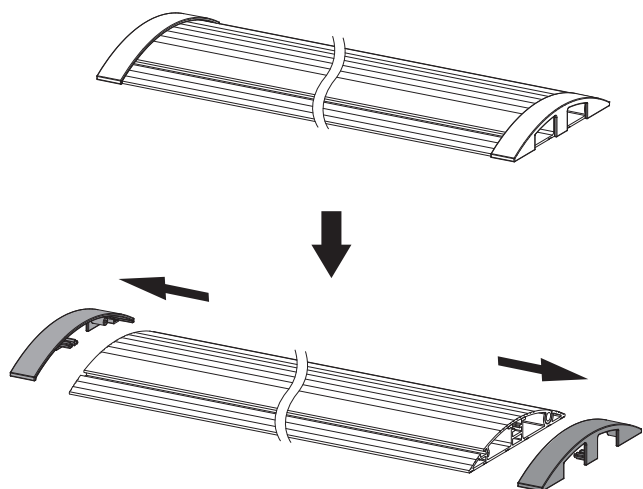

Remove the plastic end caps on each side of the ducting.

2

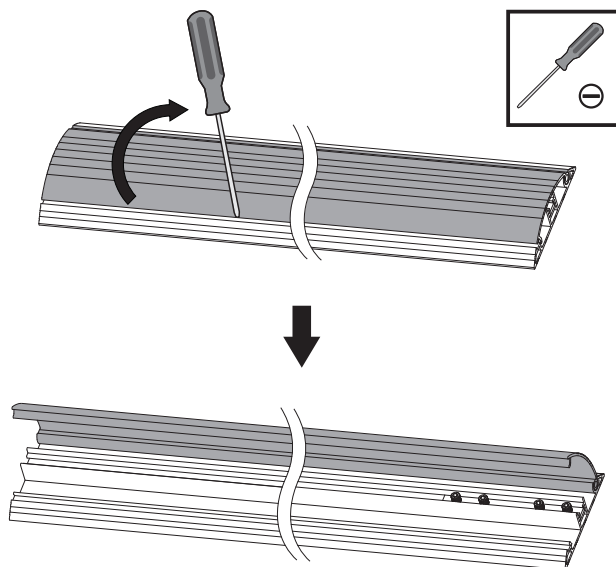

Using a flat tipped screwdriver gently pry open the cover as shown.

3a

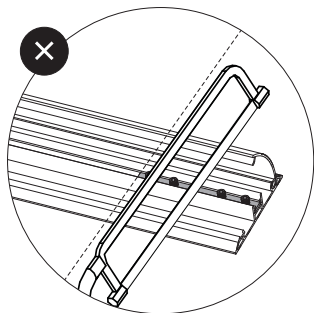
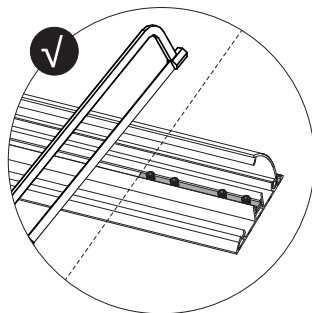
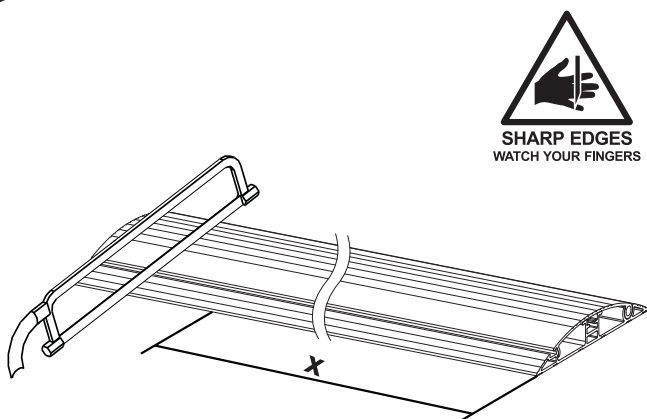

Using a hacksaw cut the ducting to desired length (Keep the Lid Closed).
NOTE: Avoid cutting the joining piece.

3b

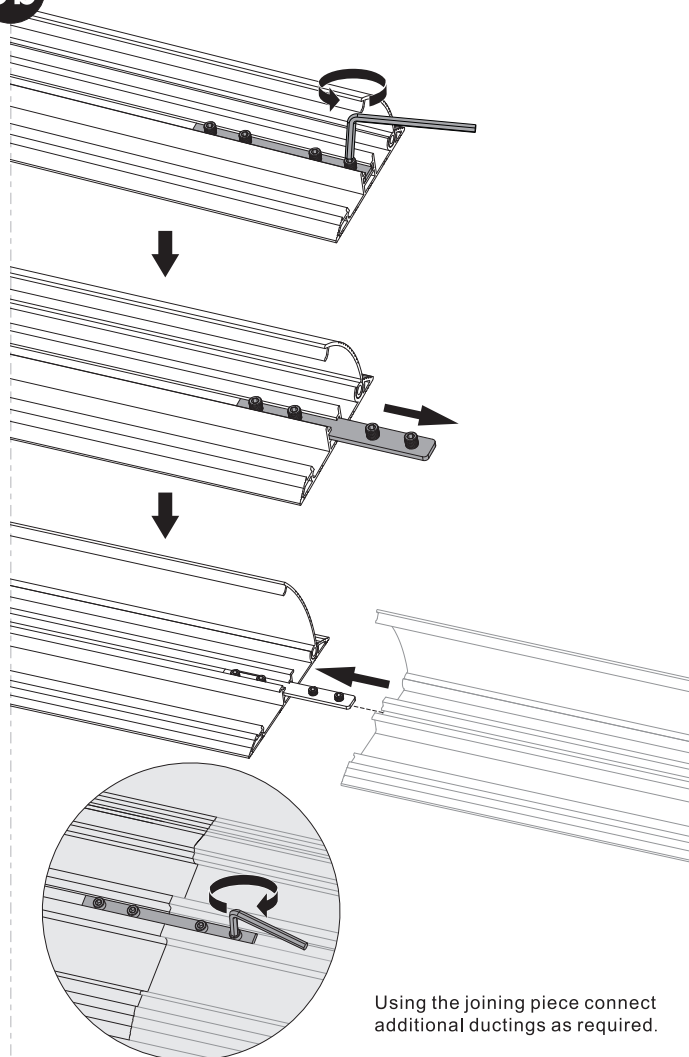

Using the joining piece connect additional ductings as required.

4

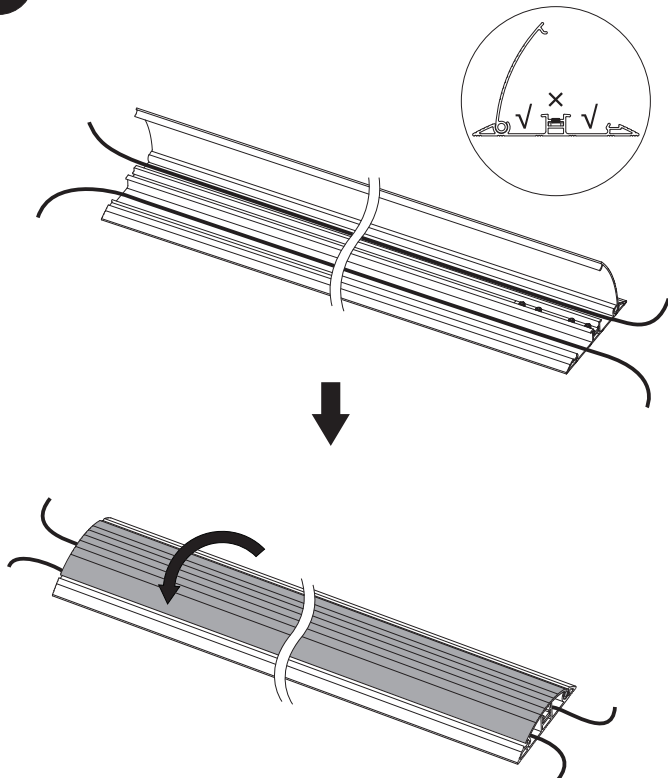

Insert the wires.

NOTE: Route wires within the grooved channels inside the ducting.

5

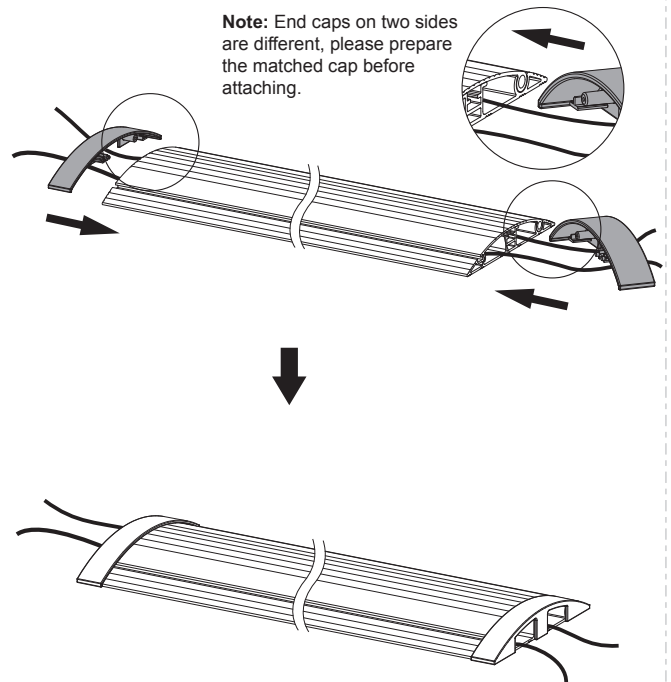

Note: End caps on two sides are different, please prepare the matched cap before attaching.

Re-attach the plastic end caps on each side of the ducting.

6

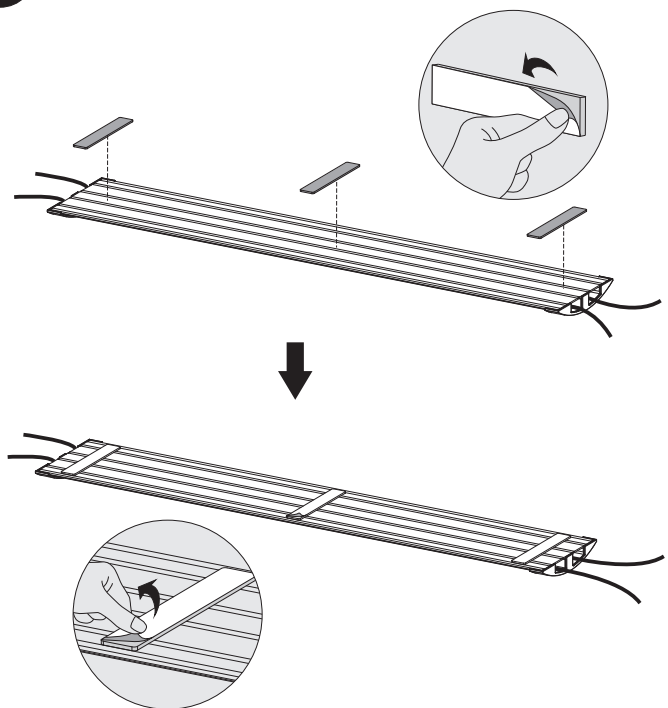

To prevent the ducting from moving, attach double-sided tape as required.

NOTE: Double-sided tape is recommended when using the ducting on hard floors.

7

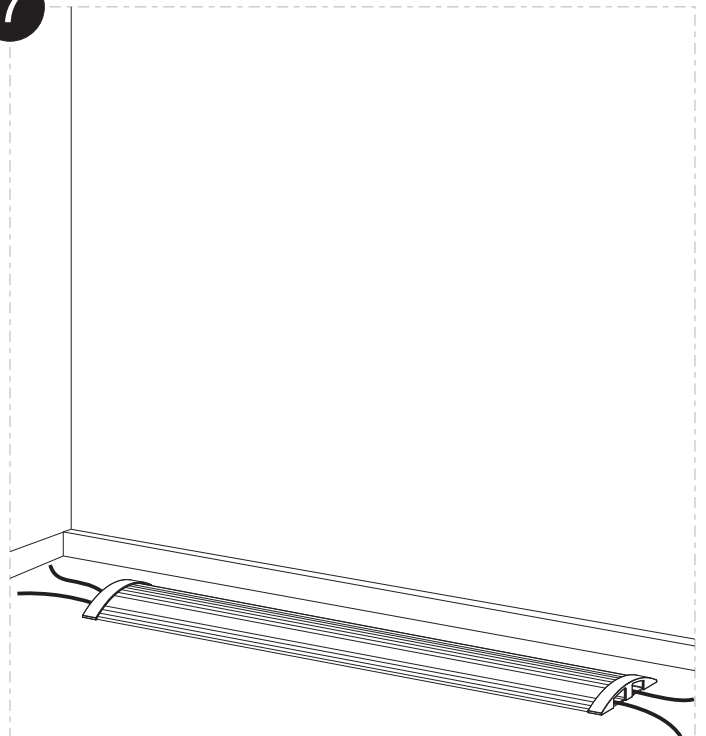

Position your ducting in the desired location.