

MANUAL MANUAL MANUAL M
NUAL MANUAL MANUAL MA

PRO BEACH SET

Art.-Nr. / Item No.:

111107(8,5 m) · 111107B · 111107B25 · 111107B50 · 111104(9,5 m)

SPORTARTEN / SPORTS



BEACHVOLLEYBALL

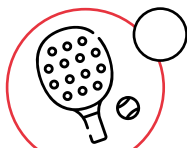

BEACHTENNIS

QUALITÄT & SPIELNIVEAU / QUALITY & SKILL LEVEL



FUNTEC

BEACH VIBES HIGH FIVES

WITH FUNTEC



BASESPORT.SE

VI ÄR BEACHVOLLEY

MADE IN GERMANY
HENNEF
Pe

— SETUP MANUAL

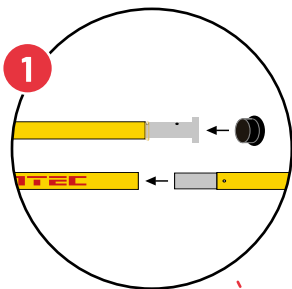

Assemble the net posts from three parts and place the black plastic base piece under the aluminium base part.

The lower section has a height-adjustable foot piece.

Put the two parts of the yellow straps together as shown. Make sure the loops are positioned at the end of the straps and not near the metal clip lock. Slip the small loops over the sand anchors.

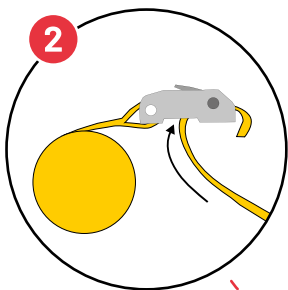

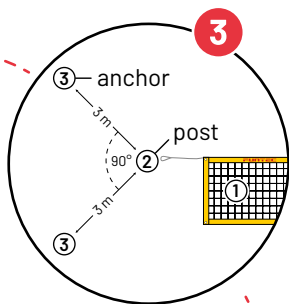

To obtain the ideal position for the sand anchors, unfold the net completely **(1)**. The loops of the top cable mark the positions of the net posts **(2)**. Knock the anchors into the ground at a distance of approx. 3 m from the post position **(3)** with an approx. 90° angle.

Make sure that you have placed the small loops of the tension straps over the anchor heads beforehand. Knock the anchors into the ground at a slight angle away from the posts to aid tensioning.

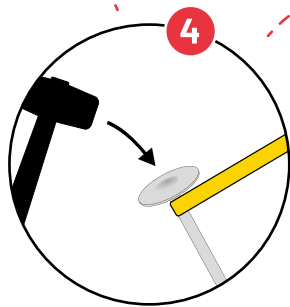

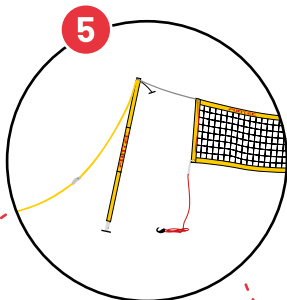

Put the large loops of the tensioning straps and the loops of the net tensioning rope over the top of the net posts and set them up at an angle towards the playing field.

Slip the loop of black bungees over the top of the net post. Then connect the black plastic tube to the red line at the top of the net. The black elastic cords will automatically center the net between the posts.

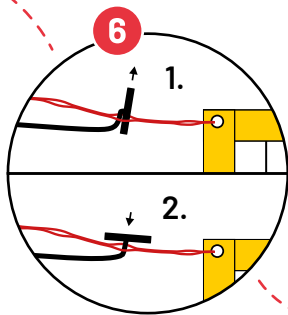

7

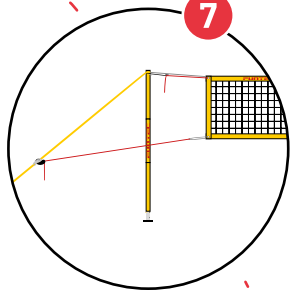

Tighten the yellow straps and adjust the position of the post to set them up vertically. The net should now align midway between the poles automatically. Adjust the lower red ropes to length at the black hook end and attach them to the metal clip locks on the yellow tension straps.

8

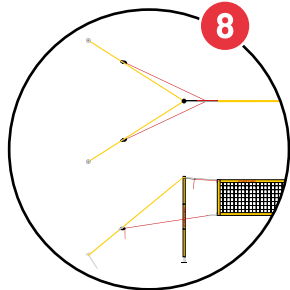

The net tension and net height can be altered to achieve the perfect net by adjusting the tension of the red ropes at the bottom corners of the net.

TIPS

BASESPORT^{SE}
VI ÄR BEACHVOLLEY

- Wipe the sand off the posts before storing them.
- Store all anchors together in one single pole section so they cannot drop out inside the bag.

RECOMMENDATION

We recommend the Beach Basic courtline with 50 mm wide black strapping as suitable for this portable Beachvolleyball set.

Item No.: 111306

