

Induction Heating Dent Repair Kit

SPECIFICATIONS

Power supply: 230V/50Hz
Input current: 1.8A
Output power: 400W
Output voltage: 170V 50kHz
Output current: 7A

PACKING LIST

Control unit
Induction head
Main cable 3 m
Power cable 1.5 m



ATTENTION

Read the operating instructions and all safety informations contained therein carefully before using the product. Use the product correctly, with care and only according to the intended purpose. Non-compliance of the safety instructions may lead to damage, personal injury and to termination of the warranty. Keep these instructions in a safe and dry location for future reference. Enclose the operating instructions when handing over the product to third parties.

SAFETY INFORMATIONS

- Keep children and other persons away from the working area.
- Do not allow children to play with this tool or its packaging.
- Do not use the tool if parts are missing or damaged.
- Use the tool for the intended purpose only.
- Before using this device, you must wear a safety mask, safety gloves, and safety clothing to avoid being burned during use.
- Operators must not have any metal objects on their person during operation, including but not limited to watches, cuff links, keys, belt buckles, coins, or zippers.
- This device cannot be operated in areas with conductive particulate matter, areas used for applying paint, areas housing or handling chemical fuels, areas of high temperature, and areas of high humidity.
- Once the device is powered on, flammable objects must be kept away from the device.
- Before you power on the device, make sure that you have a fire extinguisher on hand in case any misoperation causes a fire
- Do not use this device in the vicinity of safety airbags.
- Once the device is powered, there must be personnel on site to watch over the device. When the device is not in use, unplug the device's power cable.
- This device should be stored at temperatures between 0 and 50°C. When transporting the device, avoid vibrations or shocks.

SAFETY INFORMATIONS

- While the restoration head is restoring a damaged car body, the temperatures of both the restoration head and the body will rapidly increase. Do not touch either the restoration head or the car body before they have had time to cool down.
- While the restoration head is in the process of restoration, the temperatures of both the restoration head and the damaged area will rapidly increase. Using the restoration head on one area for too long may increase temperatures to the point of damaging the car's paint job (it is recommended that every 1-1.5 seconds, the operator wipes down the damaged area with a wet rag in order to keep the temperature manageable).
- During the restoration process, the temperatures of both the restoration head and the damaged area will rapidly increase and the body of the car will immediately become softer. During restoration, make sure the restoration head is not applying pressure to the car, otherwise the restoration process itself might further dent the car.

COMPONENTS

CONTROL UNIT

- 1 Display
- 2 Rotary knob
- 3 Main cord
- 4 Switch button (restoration head)
- 5 Contact surface (restoration head)
- 6 Power cord
- 7 Power ON/OFF
- 8 Fuse 10A
- 9 Power input
- 10 Exhaust port
- 11 Exhaust fan

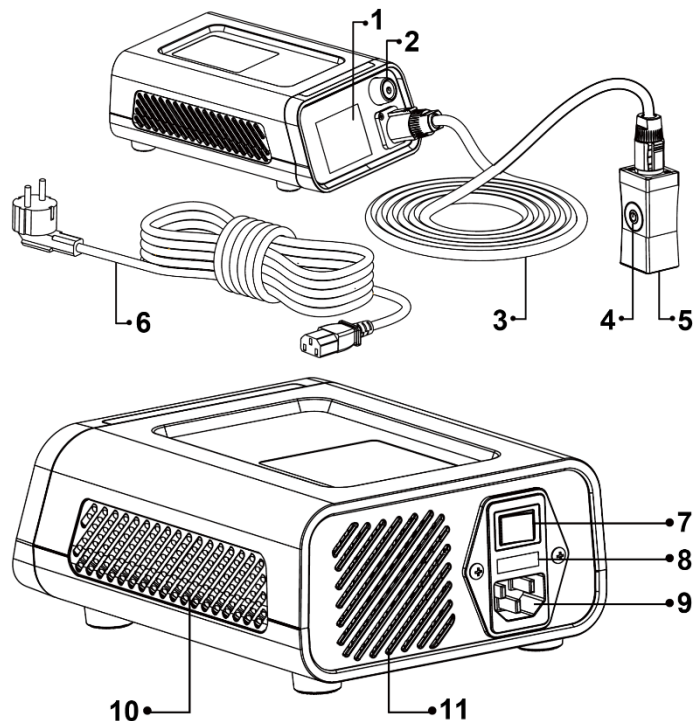

INSTALLATION

1. Connect the main cord to the repair head and control unit. Aim at the location socket and insert one end of the cord, turn the end clockwise to tighten the cord securely.
2. Connect the power cord to the backside of the control unit.
3. Make sure that all the cords are well connected before connect the machine to the power socket. Switch on the backside of the control unit.

SELF-CHECK SYSTEM

The machine is activated when turn on the power switch and then it get into the self-checking state. The machine can automatically check if the input frequency and voltage are in accordance with the applicable regulations or not before it is used. There will be an error warning accordingly if something goes wrong.

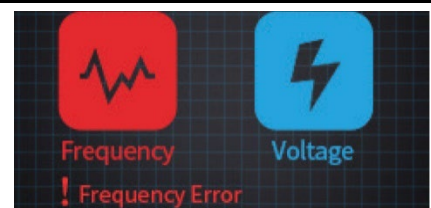

SELF-CHECK SYSTEM

The machine is standby and ready to use when input frequency and voltage are applicable.

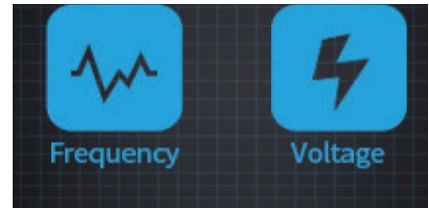

STANDBY

Turn the rotary knob to select your expected operation parameter sign. Press the rotary knob, there will appear a triangle sign, indicates the current parameter is available to set when you turn the rotary knob. Press the rotary knob again, the triangle sign disappeared indicates that the machine recover to the parameter selection state again.



PARAMETER RANGE

1. Power: OFF, 10%, 20%, 30%, 40%, 50%, 60%, 70%, 80%, 90%, MAX
2. Time: 1.0S, 1.5S, 2.0S, 2.5S, 3.0S, 3.5S, 4.0S, 4.5S, 5.0S, MAX
3. Triangle sign: Indicates the current parameter is selected and available to preset when you turn the rotary knob.
4. Volume: 0, 1, 2, 3, 4

WORKING STATUS AND ERROR INSTRUCTION

1. Standby
2. Operating
3. Wrong operation. There is an air gap between the repair head and the work piece.
4. The input voltage supplied is not stable. Please check the voltage is is normal or not.
5. The operating temperature is overheated. Please stop use the machine and let it cool down
6. adequately before use again.

SUITABLE RANGE OF USE

This device is designed specifically to be used with dents on flexible steel car bodies. The diagrams below illustrate the types of dents that can be removed. Dents like the kind caused by impact from hailstones, which leave smooth, rounded dents, can be removed. (More active materials may call for different devices, like pull hooks or suction cups. Consult with training personnel for specifics.)



UNSUITABLE RANGE OF USE

1. Sharp dents
2. Body areas that have been damaged and reconstructed
3. Crumpled/creased areas or dents along creased metal
4. Aluminum bodies



DENT REPAIR METHOD

Car body dent diagram

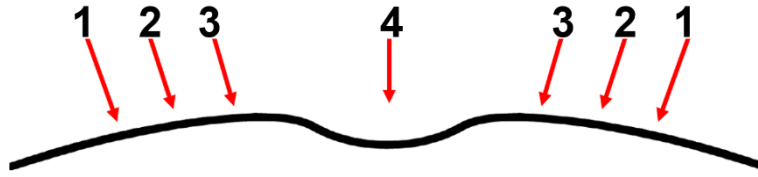

PAINTLESS DENT REPAIR MANUAL

The plant



Iron plate



PROCEDURE 1

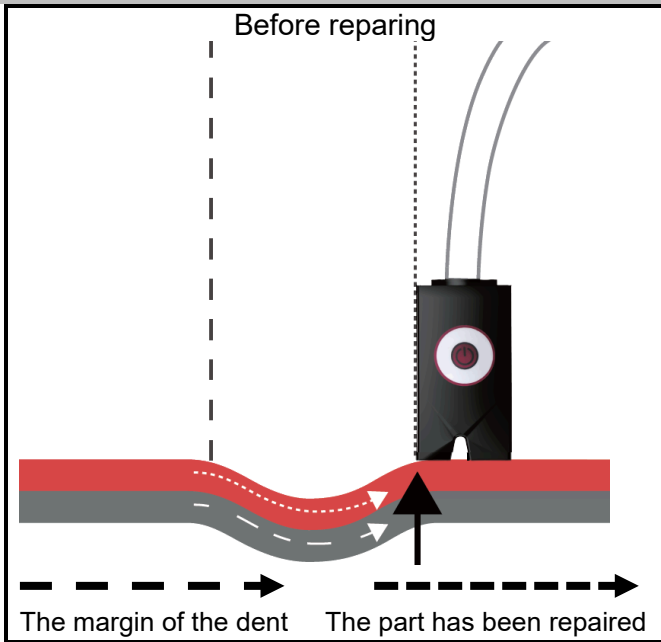

After repairing

Move the restoration head around the dented area and click on the switch.
(Set for 1 seconds and click 1-2 times).

The dent would be narrowed and you get into next step.

PROCEDURE 2

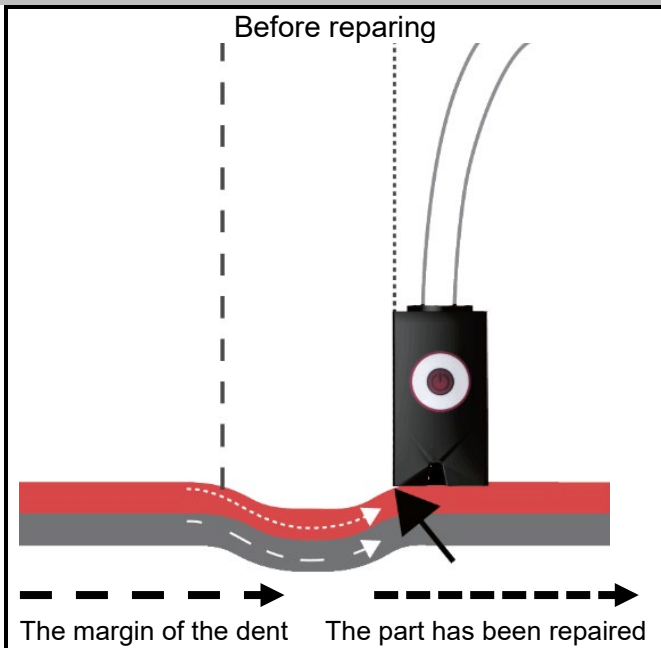

After repairing

Move the restoration head around the processed dented area and click on the switch.
(Set for 1 seconds and click 1-2 times).

The dent would be narrowed further and get into next step.

PAINTLESS DENT REPAIR MANUAL

The plant

Iron plate

PROCEDURE 3

| | |
|---|---|
| <p>Before repairing</p> <p>The margin of the dent The part has been repaired</p> | <p>After repairing</p> <p>When the dent diameter less than or equal to the restoration head. (The dent can be covered completely by the restoration head).</p> <p>Put the restoration head vertically on the dent and click the switch. (Set time for 1 second and click 1-2 times).</p> <p>There will be a small bulge on the dent and get into next step.</p> <p>Direction of iron plate distortion</p> |
|---|---|

PROCEDURE 4

| | |
|---|---|
| <p>Before repairing</p> <p>The margin of the dent The part has been repaired</p> | <p>After repairing</p> <p>Put the restoration head on the opposite sides separately of the bulge and click the switch. (Set time for 1 second and click 1-2 times).</p> <p>We make the dent reversed-draw and the surface will be flat.</p> <p>Direction of iron plate distortion</p> |
|---|---|

ENVIRONMENTAL PROTECTION

Recycle unwanted materials instead of disposing of them as waste. All packaging should be sorted, taken to a recycling centre and disposed of in a manner which is compatible with the environment.



DISPOSAL

Dispose of this product at the end of its working life in compliance with the EU Directive on Waste Electrical and Electronic Equipment. Contact your local solid waste authority for recycling information or give the product for disposal to BGS technic KG or to an electrical appliances retailer.





**EU-KONFORMITÄTSERKLÄRUNG
EC DECLARATION OF CONFORMITY
DÉCLARATION „CE“ DE CONFORMITE
DECLARACION DE CONFORMIDAD UE**

Wir erklären in alleiniger Verantwortung, dass die Bauart des Produktes:
We declare that the following designated product:
Nous déclarons sous propre responsabilité que ce produit:
Declaramos bajo nuestra sola responsabilidad que este producto:

**Induktions-Ausbeulgerät (BGS: 70240)
Induction Heating Dent Repair Kit
Appareil de débosselage par induction
Desabollador por inducción**

folgenden einschlägigen Bestimmungen entspricht:
complies with the requirements of the:
est en conformité avec les réglementations ci-dessous:
esta conforme a las normas:

**EMC Directive 2014/30/EU
RoHS Directive 2011/65/EU**

Angewandte Normen:

Identification of regulations/standards:

Norme appliquée:

Normas aplicadas:

EN 55014-1:2006+A1:2009+A2:2011
EN 61000-3-2:2014 ; EN 61000-3-3:2013
EN 55014-2:1997+A1:2001+A2:2008
EN 61000-4-2:2009 ; EN 61000-4-3:2006+A1:2008+A2:2010
EN 61000-4-4:2012 ; EN 61000-4-5:2014
EN 61000-4-6:2014 ; EN 61000-4-11:2004
IEC 62321-1:2013

Certificate No.: BCTC-160505401C / PDR-007

Test Report No.: BCTC-160505401E

RoHS Certificate: BCTC-160505403C

Wermelskirchen, den 01.09.2025

ppa.

Frank Schottke, Prokurist

BGS technic KG, Bandwinkerstrasse 3, D-42929 Wermelskirchen