

Réf. 266555

GenCode : 3476060026651 / Weight : 27400g



PROFESSIONAL HOT WIRE CUTTING TABLE - For styrofoam panel, especially for E.T.I.C.S. applications

Hot wire cutting machine for a clean cut without polystyrene beads projection.

For expanded and extruded polystyrene (E.P.S. and X.P.S.).

Max. depth : 330 mm.

Max. height : 1320 mm.

Max. width : 1550 mm.

From 0° to 90° angle cuts.

From 90° to 15° chamfered cuts.

Groove cutting until 300 mm depth.

Temperature of the hot wire : 350°C.

Transformer : 40 V / 200 W / 230 V.

CE certified.

Accessories included :

- Carrying case with wheels
- Scaffold hanging accessory
- Folding feet
- 2 hot wires

Possible cutting shapes : rectangular, angled, chamfered, stepped, grooved.

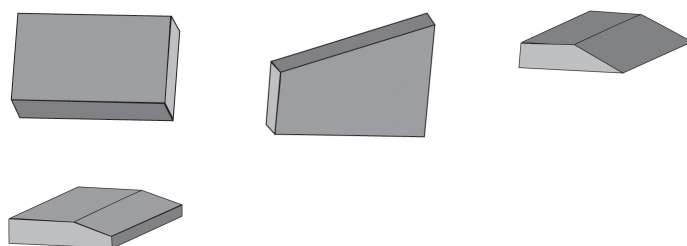

PHOTOS OF CONTEXT

