

Tool set for compact  
wheel hub/bearing unit  
Ø 72, 78, 82



**MECHANICAL  
WORKING**



**Complete Kit (The hydraulic cylinder is NOT INCLUDED)**

**323 029 023**



This tool kit is used to pull and insert wheel hubs and their bearings perfectly and safely, without damaging the mechanic gears.

**Components**

Ring for bearing introduction  
Ø 72 **323029020**

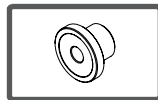

Ring for bearing removal  
Ø 72, Ø 78, Ø 82 **323029022**

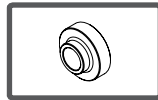

Ring for bearing introduction  
Ø 78 **323029018**

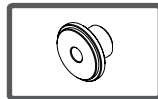

Ring for bearing introduction  
Ø 82 **323029009**

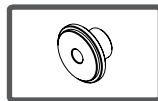

Nut + OR + bearing **323029015**

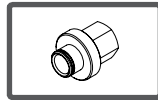

Counterthrust nut **323029012**

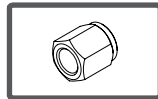

Half ring for introduction  
Ø 82 **323029005**



Half ring for removal **323029011**



Half ring for introduction  
Ø 72, Ø 78 **323029016**



BRAND	TYPE	HUB
AUDI	A1; A2	Ø 72
	C30; C70; S40; V50	Ø 78
	S80; V70; XC60; XC70 2006-	Ø 82
SEAT	Cordoba; Ibiza	Ø 72
SKODA	Fabia	Ø 72
VW	Polo	Ø 72
	Focus II; C-Max; S-Max	Ø 78
FORD	Mondeo 2007-; Galaxy; S-Max 2006-	Ø 82
MAZDA	3	Ø 78
LAND ROVER	Freelander 2 2006-	Ø 82

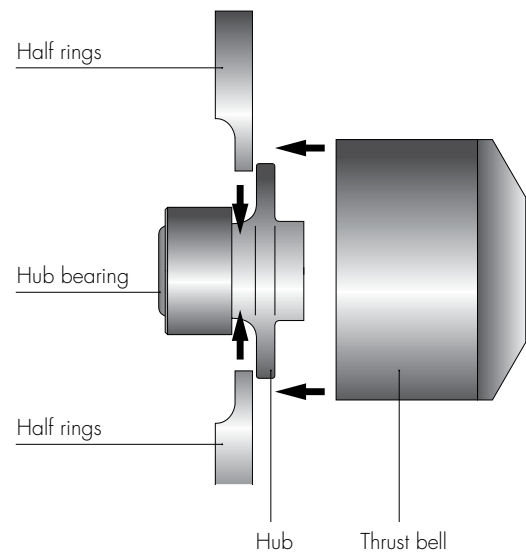

**Components**

Thickness  $\varnothing$  18x12 for  $\varnothing$  82

**323029013**

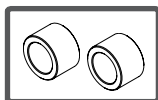

Thickness  $\varnothing$  18x3 for  $\varnothing$  72

**323029014**

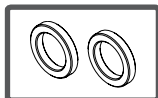

Thickness  $\varnothing$  18x9 for  $\varnothing$  78

**323029021**

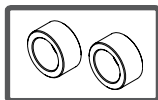

**Components**

Screw 12X55

**822084000**

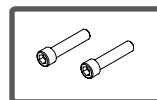

Thrust bell

**323029001**

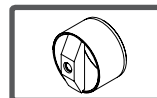

M20X1.5 Screw - CH15 for bearing removal

**323029004**

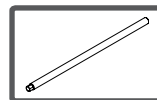

« To complete the tool kit and make the operation faster and perfect, use also the hydraulic cylinder designed by GOVONI (code 270025000), power 17 Tons and stroke 43 mm.

« Also available the hydraulic pump designed by GOVONI (code 271004000) to obtain the max. thrust of 17 tons with pressure 700 Bars.

