

Hydraulic cylinder

Extractor kit with 17 TON hydraulic cylinder



HEAVY DUTY

17 ton, stroke 70 mm

i ▶ Device to be used for removing hubs, bearings and for all the other applications where it can be used, such as mechanical parts very tighten.

▶ **PRESSURE:** 700 Bar
 ▶ **WEIGHT:** 5,12 Kg
 ▶ **HOLE:** Ø 20,4 mm

ii ▶ **CONNECTION:** 3/8" -18 NPT
 ▶ **POWER:** 166713,05 N
 ▶ **STROKE:** 70 mm
 ▶ **DIMENSIONS:** Ø 90x155 mm

Complete Kit

270 017 000

Components

Hydraulic cylinder

270017001

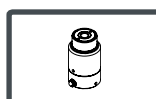

Quick connection 3/8" F

251019000

