

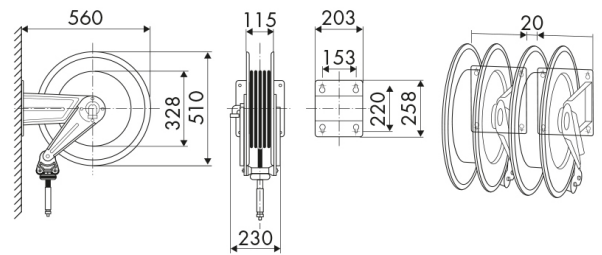

ART. 8530.702

Fixed hose reel, s.530, for welding, 20 bar, twin gum hose SBR/EPDM 20 m, 2 x \varnothing 1/4"

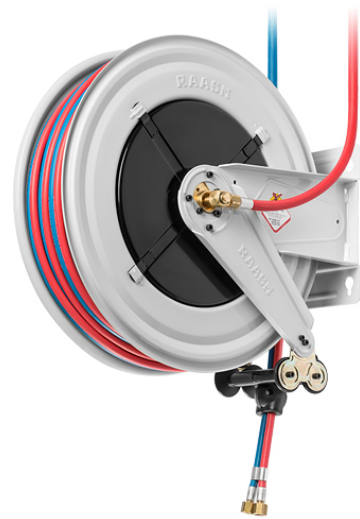

Features

Features	Value
Pressure	20 bar
Compatible fluids	welding
Swivel joint	brass
Seals	Viton®
Characteristic	fixed
Material	painted steel
Couplings	brass
Hose	p/n 973.920
\varnothing and hose length	2 x \varnothing 1/4" - 20 m
Inlet	G 3/8" (f)
Outlet	G 3/8" (f)
Reel flow path	brass - zinc plated steel

RAASM S.p.A.

via Marangoni 33, 36022 - S. Zeno di Cassola (VI) - ITALY
Tel. 0039 0424 571111 - Fax. 0039 0424 571135

info@raasm.com - www.raasm.com

Copyright © 2020 All rights reserved to RAASM S.p.A.