



SL-40CBTE-K



SL-40CBTE-T



SL-40CBTE-H

## DIRECT DRIVE TURNTABLE SYSTEM

# PREMIUM CLASS SL-40CBT

Combining Technics' coreless direct drive technology and plug & play features with a new minimalistic design, the SL-40CBT redefines the modern turntable style elegantly matching your home interior.

**Coreless Direct Drive Motor** with single stator and single rotor for accurate and stable rotation

**Built-in Phono (MM) Equalizer and Pre-installed Pickup Cartridge** for simple setup and easy connectivity

**Bluetooth Transmission\*** for even wider connection flexibility with a multitude of contemporary audio devices

**High-Sensitivity S-Shaped Aluminum Tonearm** with precise tracking of vinyl discs for maximum musical enjoyment

**Puristic, Contemporary Design** with three colours available for elegant integration in modern home interior style

\*aptX Adaptive, SBC

Rediscover Music

**Technics**

At the heart of the SL-40CBT lies the same coreless direct drive motor technology found in Technics' higher models like the SL-1500C and SL-1200MK7. This motor features a 12-pole, 9-coil, three-phase brushless DC design, delivering exceptional rotational accuracy and ultra-low noise.



### Coreless Direct Drive Motor

Traditional direct drive systems often suffer from cogging – minute speed fluctuations caused by magnetic resistance. The SL-40CBT eliminates this with a stator that has no iron core, ensuring smooth, uninterrupted rotation. A specially designed rotor yoke further reduces magnetic flux leakage, preventing interference with the cartridge and preserving audio purity.

### High-Accuracy Motor Control

Sophisticated control circuitry ensures the platter maintains a consistent speed under all conditions. This results in stable pitch and timing, which are critical for accurate music reproduction especially noticeable in classical, jazz, and live recordings.

Engineered for

Audiophile-Grade Performance.

### Built-in Phono Equalizer

The SL-40CBT features a high-grade MM phono equalizer, housed in a shielded enclosure to minimize external noise and interference. This circuit is expertly tuned to deliver optimal performance with the included Audio Technica AT-VM95C cartridge, ensuring a balanced frequency response and rich, dynamic sound right out of the box. At the same time, it offers broad compatibility with most other MM cartridges, making it easy for users to upgrade or replace their pick-up without compromising audio quality.

### Short Signal Path for Clean Sound

By integrating the phono stage directly into the turntable, the signal path from cartridge to output is kept short, reducing the risk of signal degradation and external interference. This means cleaner, more detailed playback – even at low volumes.

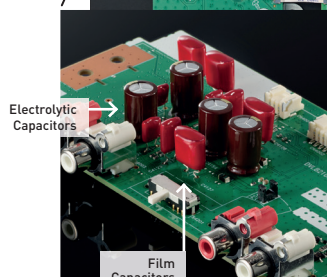
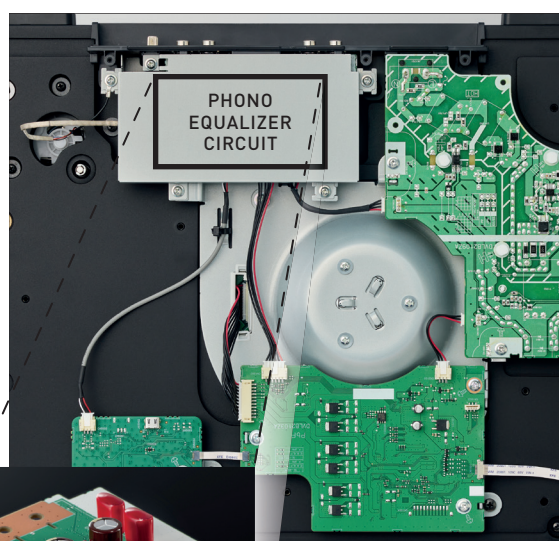



Designed for Modern Living.  
The SL-40CBT is more than a turntable –  
it's a lifestyle upgrade.



### Instant Enjoyment

Comes with a high-quality Audio  
Technica AT-VM95C pickup cartridge  
for immediate playback.



### Minimalist Aesthetics

Clean lines and intuitive operation  
make it a seamless addition to any  
contemporary space.



### S-Shaped Aluminum Tonearm

The precision-engineered tonearm  
ensures accurate tracking for a truly  
immersive vinyl experience.

Technics' first Turntable with  
Bluetooth Connectivity.



### Bluetooth Transmission (aptX Adaptive, SBC)

Experience the freedom of wireless listening.  
Stream your vinyl collection to Bluetooth  
speakers or headphones and enjoy your  
records in more ways than ever before.



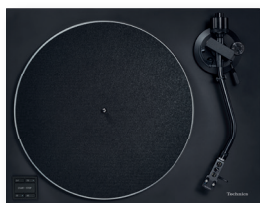

EAN: 5025232981854

## SL-40CBTE-K

Colour: Black



EAN: 5025232981861

## SL-40CBTE-T

Colour: Terracotta Brown



EAN: 5025232981878

## SL-40CBTE-H

Colour: Grey

### Turntable Section

Motor	Coreless Direct Drive Motor (Single rotor-type)
Turntable Speeds	33 1/3, 45 rpm
Body	MDF
Wow and Flutter	0.025% W.R.M.S.
Turntable Platter	Aluminum die-cast

### Tonearm Section

Insulator Height Hdjustment	Yes (New Insulator)
Tonearm Height Adjustment	–
Auto Lifter	–
Cartridge	Audio Technica AT-VM95C
Auxiliary Weight	–

### Terminals

Built-in Phono EQ	Yes
Audio Output	Phone/ Line/ Earth Terminal
Bluetooth Transmission	aptX Adaptive, SBC

### General

Power Supply	AC 220–240V, 50/60 Hz, Switching Mode Power Supply
Dimensions (W x D x H)	430 x 334 x 128 mm
Weight	Approx. 7.1 kg
AC Cord	2-pin Type
Dust Cover	Yes

Complete your Technics setup with the SC-CX700 HiFi active speaker system, a perfect match in both design and performance. Crafted to complement your turntable in style and sound, it brings harmony to your home audio experience.



**Panasonic Marketing Europe GmbH.** Technics is the brand name of hi-fi audio products owned by Panasonic Corporation. The design and specification of products are constantly changing in the interest of improvement. Whilst every care has been taken in the preparation of this catalogue, some changes may not have been indicated and may have occurred after publication. Please check with your Panasonic dealer for details. Panasonic Marketing Europe GmbH cannot accept any responsibility for any error or omissions.

[www.technics.com](http://www.technics.com)

[facebook.com/technics.global](https://facebook.com/technics.global)

[www.instagram.com/technics\\_global/](https://www.instagram.com/technics_global/)

[youtube.com/user/TechnicsOfficial](https://youtube.com/user/TechnicsOfficial)