

FASTENING SETS

BEF-830/840/841

I-beam clamp

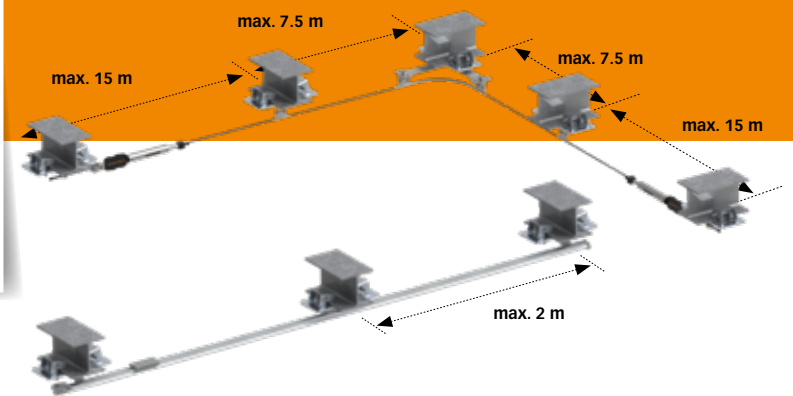

The BEF-830/840/841 fastening sets from INNOTECH are characterised by their high intrinsic stability. The variable adjustment options for the various clamps guarantee

- Fastening set for clamping to I-beams
- The fastening sets can be used in the AIO lifeline system, the TAURUS rail system, and with EAP-SPAR-10-25 as a single anchor point
- With the ABP-10-30, also suitable for abseiling

perfect adaptation to the respective beam dimensions. The clamps allow rapid and above all perforation-free installation on the respective structures.

- Fastening spacings up to 15 m max. are possible
- No penetration of the supporting structure
- Simple and fast installation
- Simple to retrofit at any time

Fastening sets

BEF | FASTENING SETS

BEF-830-01

FASTENING SETS FOR I-BEAM STRUCTURES

Material: galvanised steel
Flange width: 80 to 130 mm

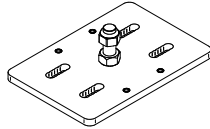

Can only be used in combination with BEF-840/841
Available on request only!

BEF-830-02

FASTENING SETS FOR I-BEAM STRUCTURES

Material: galvanised steel
Flange width: 130 to 180 mm

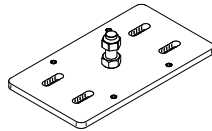

Can only be used in combination with BEF-840/841
Available on request only!

BEF-830-03

FASTENING SETS FOR I-BEAM STRUCTURES

Material: galvanised steel
Flange width: 180 to 260 mm

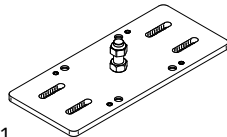

Can only be used in combination with BEF-840/841

BEF-830-04

FASTENING SETS FOR I-BEAM STRUCTURES

Material: galvanised steel
Flange width: 260 to 350 mm

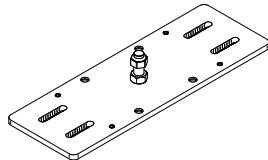

Can only be used in combination with BEF-840/841

BEF-830-05

FASTENING SETS FOR I-BEAM STRUCTURES

Material: galvanised steel
Flange width: 350 to 450 mm

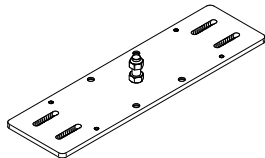

Can only be used in combination with BEF-840/841

FASTENING SETS

BEF-840

FASTENING SETS FOR BEF-830-XX

Material: galvanised steel
Flange width: 8 to 26 mm

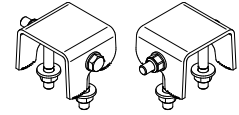

Can only be used in combination with BEF-830-01/02/03/04/05

BEF-841

FASTENING SETS FOR BEF-830-XX

Material: galvanised steel
Flange width: 24 to 40 mm

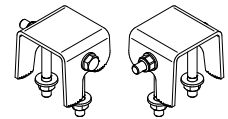

Can only be used in combination with BEF-830-01/02/03/04/05

BEF-810-1

ADAPTER BRACKET FOR CORNER PASS-THROUGH ELEMENTS

Substructure: BEF-810, BEF-811, BEF-830-XX
Material: galvanised steel
Connection: Thread M16

