

VERTICAL LIFELINE SYSTEM

VERT-SET-50

Lifeline system



The VERT-SET-50 from INNOTECH is the innovation in vertical lifeline systems. Once attached to the new travelling eyebolt, the user is able to ascend with even more freedom of movement, because the eyebolt slides unimpeded and free over the traversable system.

- Vertical lifeline system with projection to protect people from falling
- Traversable intermediate bracket for unimpeded access
- Accessibility to the lifeline system without detaching or reconnecting
- User-friendly installation without special tools
- Flexible guiding through vertical curves is possible

The particularly flexible system prevents incorrect use, and the core of the system, the new travelling eyebolt, has an innovative safety function.

- No safety cage required for the vertical lifeline system
- Slider has new safety function – use in the incorrect direction is not possible
- Certification to the latest state of the art:

EN 353-1:2014

Complete vertical set

ATTENTION: As per standard EN 353-1:2014, vertical lifeline systems may be placed on the market only as complete systems, i.e. with VERT-GLEIT-50, VERT-SET-50, and AIO-SEIL-30 (see item 3 of the standard).

Extended profile for an optimum transition to the roof surface

VERT-SET | COMPLETE VERTICAL SET

VERT-SET-50

ATTACHMENT AT TOP

Material: Stainless steel (AISI 304), aluminium
Substructure: Ladder
Rung dimensions: max. 45 x 45 mm, Ø 45 mm

Additional safety attachment
to the building structure (VERT-SAFE-50) optional

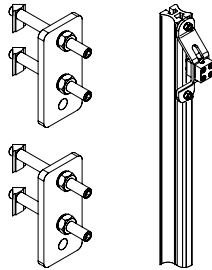

ATTACHMENT AT BOTTOM

Material: Stainless steel (AISI 304), aluminium
Substructure: Ladder
Rung dimensions: max. 45 x 45 mm, Ø 45 mm

Additional safety attachment
to the building structure (VERT-SAFE-50) optional

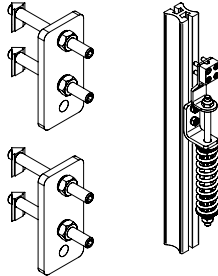

GLEIT | TRAVELLING EYEBOLT

VERT-GLEIT-50

MOBILE ANCHORAGE POINT/TRAVELLING EYEBOLT,
REMOVABLE, CURVE COMPATIBLE (EN 353-1:2014)

Material: stainless steel (AISI 304), (AISI 316)

Can be installed and removed at any point in the vertical lifeline system, with integrated shock force absorption, suitable for traversing the pass-through elements (intermediate brackets and curved elements)

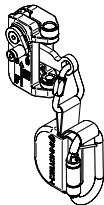

SZH | INTERMEDIATE BRACKET

VERT-SZH-50

INTERMEDIATE BRACKET, VERTICALLY TRAVERSABLE

Material: stainless steel (AISI 304)
Substructure: Ladder, aluminium/steel construction
Rung dimensions: max. 45 x 55 mm, Ø 45 mm

Intermediate bracket separation 5 m

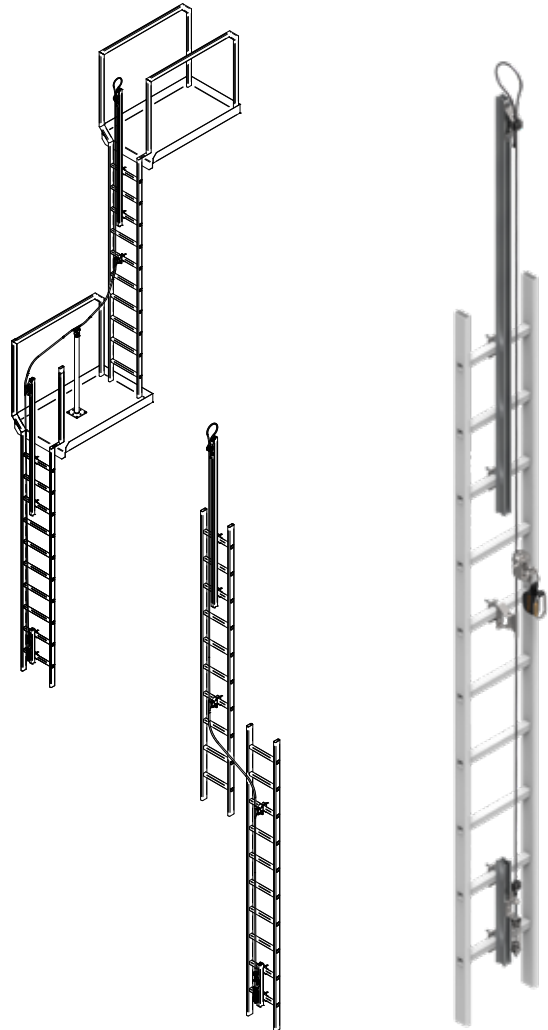
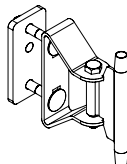

INTERMEDIATE BRACKETS

VERT-SAFE-50

REDUNDANT SECURING

Material: Aluminium 5754

For more security additional attachment
on the building structure.
Absolutely essential when the ladder rungs
cannot withstand a force of 16kN (as per EN 353-1)

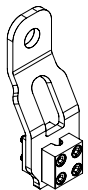

AIO-SEIL-30

CABLE OF STAINLESS STEEL (EN 795 C)

Material: Stainless steel (AISI 316)
Dimensions: Ø 8mm (7 x 7)
Breaking load: 37 kN

Tested for INNOTECH lifeline system

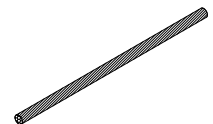

TYP | RATING PLATES

VERT-TYP-50

RATING PLATE,
VERTICAL LIFELINE SYSTEM, (EN 795 C)

Dimensions: 3 x 12 cm
Material: Plastic

Is stuck onto VERT-SET-50

