

(1) EC-Type Examination Certificate

(2) Council Directive of 21 December 1989 on the approximation of the laws of the member states relating to personal protective equipment - 89/686/EEC

(3) No. of EC-Type Examination Certificate: **ZP/B033/15** replaces ZP/B069/14

(4) Product: **Anchor device class D and guided type fall arrester including rigid anchor line**
Type: **TAURUS**

(5) Manufacturer: **INNOTECH® Arbeitsschutz GmbH**

(6) Address: **Laizing 10, 4656 Kirchham, Austria**

(7) The design and construction of this personal protective equipment and any acceptable variation thereto are specified in the schedule to this type examination certificate.

(8) The certification body of DEKRA EXAM GmbH, Notified Body No. 0158 according to Article 9 of Council Directive 89/686/EEC of 21 December 1989, certifies that this personal protective equipment has been found to comply with the Essential Health and Safety Requirements given in Annex II to the Directive. The examination and test results are recorded in the test and assessment report PB 15-100.

(9) The Essential Health and Safety Requirements are assured by compliance with

DIN EN 795:2012

DIN CEN/TS 16415:2013

DIN EN 353-1:2002

CNB/P/11.073

(10) This EC-Type Examination Certificate relates only to the design, examination and tests of the specified personal protective equipment in accordance to Directive 89/686/EEC. Further requirements of the Directive apply to the manufacturing process and supply of this personal protective equipment. These are not covered by this certificate.

(11) When applying the CE Marking to the products that conform to the types examined, the client is obliged to add, in accordance with the attached pattern, the identification number of the Notified Body engaged in production control.

CE 0158

(12) This EC-Type Examination certificate is valid until 2020-08-02.

DEKRA EXAM GmbH
Bochum, 2015-08-03

signed: Wiegand
Certification body

signed: Mühlenbruch
Special services unit

We confirm the correctness of the translation from the German original. In the case of arbitration only the German wording shall be valid and binding.

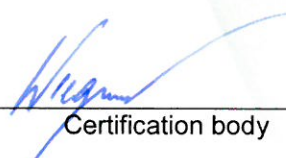
Certification body

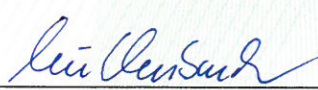
Special services unit

(13) Appendix to

(14) **EC-Type Examination Certificate**
ZP/B033/15

(15) 15.1 Subject and Type

Anchor device type D and guided type fall arrester including rigid anchor line

Type: TAURUS

15.2 Description

Anchor device

The anchor device, type: TAURUS is used for to temporary secure persons against fall from a height.

The system was developed for horizontal application and consists of a rail and the appropriate approved rail slider. The rail (=continuous cast aluminium profile) TAURUS RAIL-*,* can be designed as straight section, curved or bent profile. The connection between two guide blocks is provided by a TAURUS VB-10 rail connector resp. connector with expansion compensation.

On the anchor line run the mobile anchor points type: TAURUS-GLEIT-H-10, type: TAURUS-GLEIT-H11, type: TAURUS-GLEIT-A-30 and type: TAURUS-GLEIT-S-40.

The mobile anchor point type: TAURUS-GLEIT-S-40 can be used as guide of up to 70° in a suitable arrangement. They have eyelets for fixing the user's personal protection equipment. Up to four persons at a time can be protected on each 10 meters of rail length. The system is installed horizontally by means of the holders provided; any two holders can be spaced apart up to 3000 mm. The rail can be fastened to the building structure either on the roof, the wall or the ceiling.

Curve detours and running turnarounds in the form of a turnstile, type: TAURUS-DW-10 can be realized as well. The rail connector with expansion compensation is exclusively intended for placing the guide on a roof. The ends of the rail are protected by end stops so that the anchors cannot accidentally run off the rail. An end stop (for install/remove TAURUS EA-11) can be opened so that the mobile anchor can be installed on or removed from the anchor line.

The other end stop can remain firmly closed (TAURUS EA-10).

Guided type fall arrester including a rigid anchor line

The guided type fall arrester including a rigid anchor line, type: TAURUS is used for temporary securing persons against fall from a height.

The system was developed for vertical application and consists of a rail and the appropriate approved rail slider. The rigid anchor line can be installed at maximum 45° and 10° inclination, respectively to the structure with a lateral offset of the mounting holder. The rail (=continuous cast aluminum profile) TAURUS RAIL acts as the rigid anchor line. The connection between two guide blocks is provided by a TAURUS VB-10 rail connector.

Running on the rigid anchor line is the energy absorbing guided type fall arrester, type: TAURUS GLEIT-V-20 or type: TAURUS GLEIT-A-30. To accept the user's connecting element (carabiner), they are provided with an appropriate eyelet at the integrated energy absorber.

The maximum distance between the energy absorber of the guided type arrester and the front fall arrest eyelets of the full body harness must not exceed 11 cm (= 1 spring hook length).

Maximum two persons can be protected at the same time. The maximum permitted weight of the user at the guided type fall arrester is 100 kg. The anchor line is fastened by suitable holders at spacing not exceeding 2000 mm. The ends of the rail are protected by end stops so that the anchors cannot accidentally run off the rail. An end stop (install/remove TAURUS EA-11) can be opened so that the guided type fall arrester can be installed on or removed from the guide. The other end stop can remain firmly closed (TAURUS EA-10).

Combination of „anchor system“ and „guided type fall arrester including a rigid anchor line “

The „slider“ type: TAURUS GLEIT-A-30 can be used as mobile anchor point horizontally or as guided type fall arrester in vertical applications and as such provides an uninterrupted connection of both systems if the „Personal Protection Equipment (PPE) against falls from a height“ is used correctly.

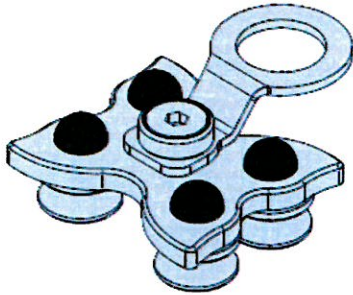

Fig. 1: Mobile anchor point,
type: TAURUS GLEIT-H-10

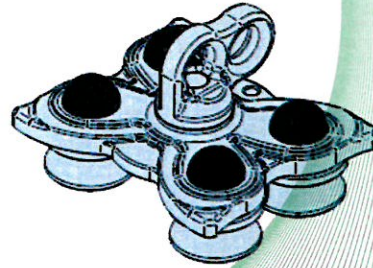

Fig. 2: Mobile anchor point,
type: TAURUS GLEIT-H-11

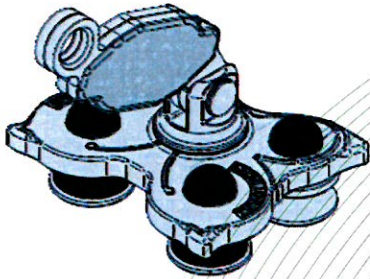

Fig. 3: Mobile anchor point and guided
type fall arrester,
type: TAURUS GLEIT-A-30

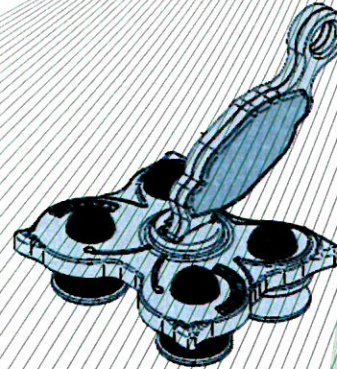

Fig. 4: Guided type fall arrester,
type: TAURUS GLEIT-V-20

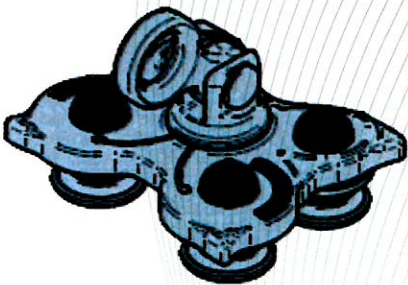

Fig. 5: Mobile anchor point, type: TAURUS GLEIT-S-40

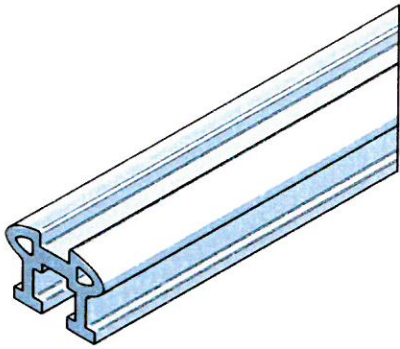

Fig. 6: Anchor line TAURUS RAIL-10, -20, -30, -40

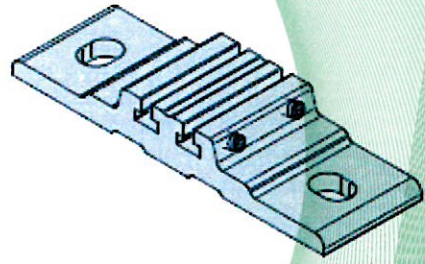

Fig. 7: Holder TAURUS-BEF-10

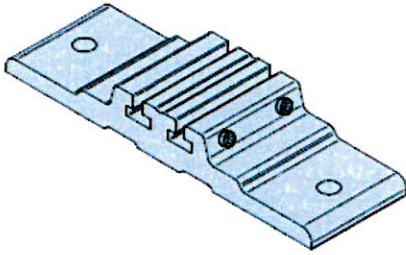

Fig. 8: Holder TAURUS-BEF-40

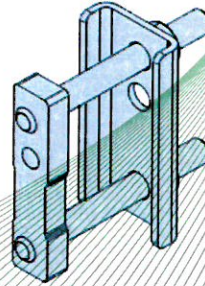

Fig. 9: Holder TAURUS-BEF-90

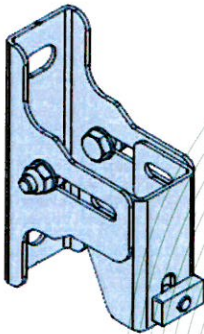

Fig. 10: Holder TAURUS-BEF-20

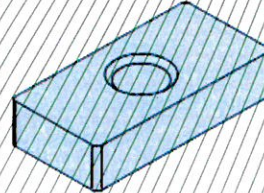

Fig. 11: Holder TAURUS-BEF-12

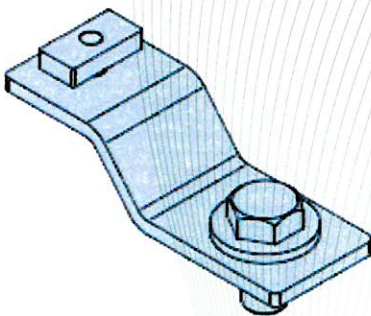

Fig. 12: Holder TAURUS-BEF-30

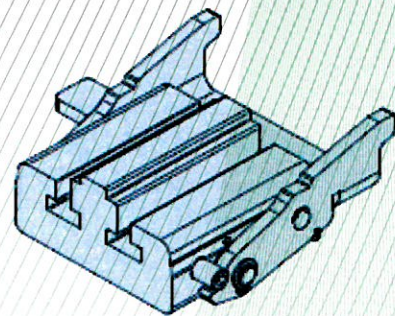

Fig. 13: End stop with install/remove facility
type: TAURUS EA-11

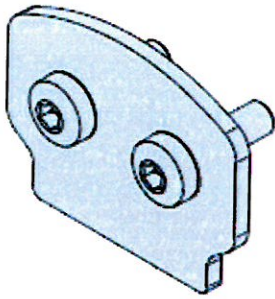

Fig. 14: End stop, type: TAURUS EA-10

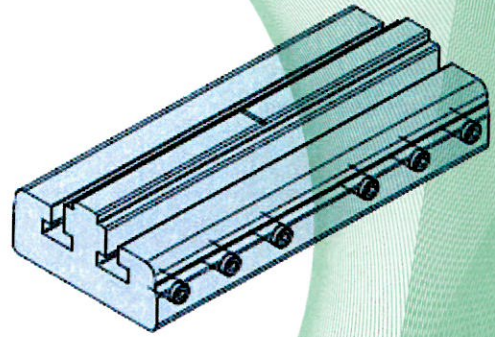

Fig. 15: Rail connector, type: TAURUS VB-10

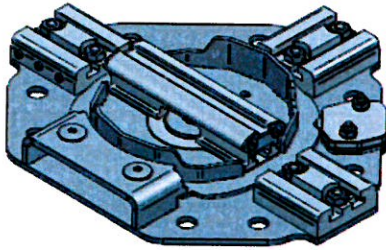

Fig. 16: Turnstile, type: TAURUS-DW-10

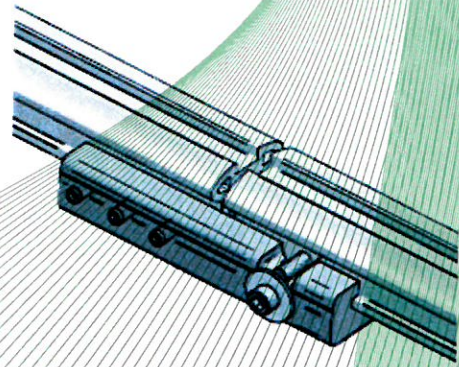

Fig. 17: Rail connector with expansion compensation

(16) Test and Assessment Report

PB 15-100 dd. 2015-08-03