

Temporary horizontal lifeline system **TEMP**

EN

TEMP, the temporary horizontal lifeline system from INNOTECH is very simple and quick to install and remove, and is therefore especially suitable for short-term installation requirements on building sites or on industrial construction sites having very varied support structures (steel, façade, warehouse, and bridge construction, etc.).

A practical lashing belt ratchet and a braked cable drum with up to 150 m stainless steel cable provide the maximum possible flexibility for temporary use.

- mobile lifeline system
- ideal for steel, façade, warehouse, and bridge construction
- adapts itself individually to very varied fastening options (round columns, steel construction, INNOTECH anchorage points)
- simple and quick installation and removal
- braked cable drum with up to 150 m stainless steel cable
- End lock with integrated shock absorber
- up to 20 m separation between cables can be achieved!
- to the latest state of the art certification:

EN 795:2012 TYPE B and C
CEN/TS 16415:2013

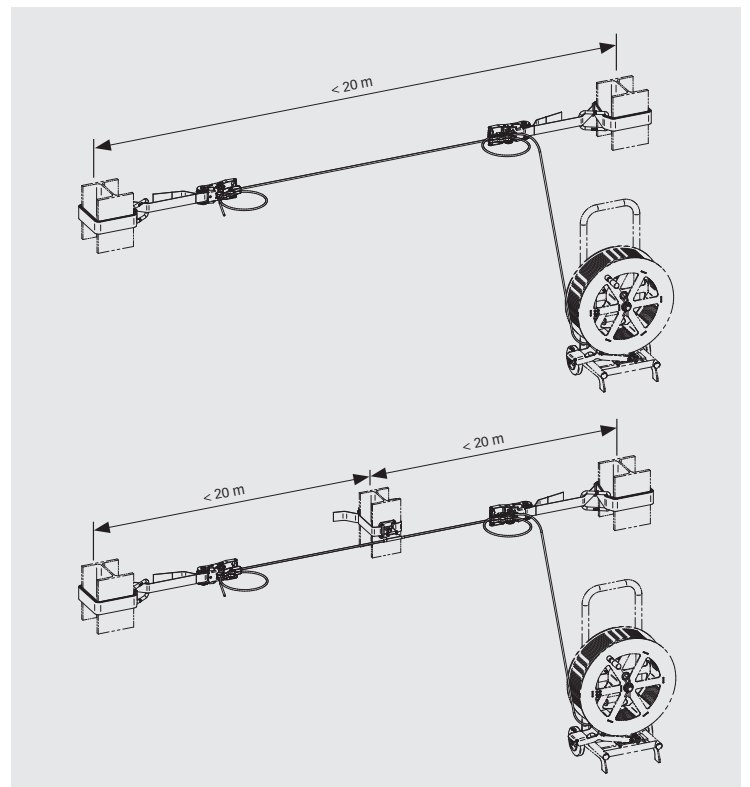



TEMP

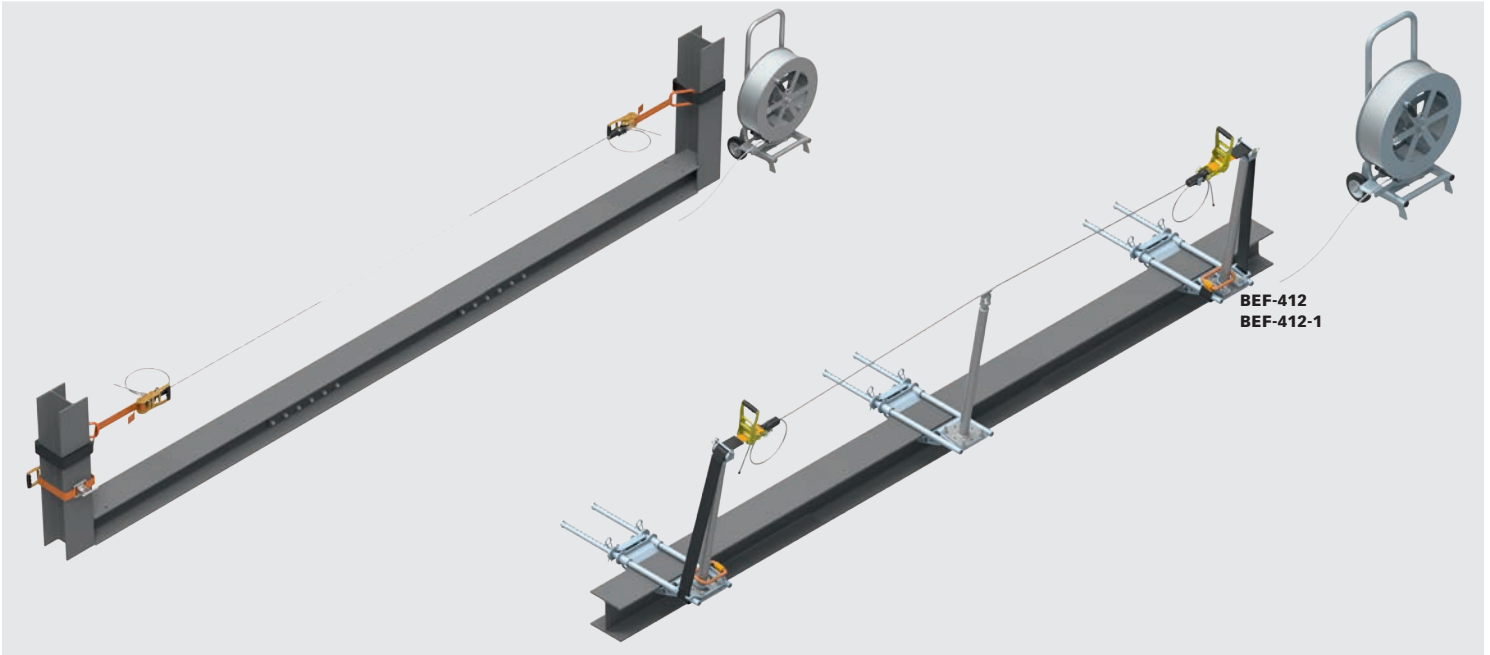

SYSTEM COMPONENTS

**TEMP-HASPEL-10
MOBILE CABLE DRUM**

Material: Stainless steel (AISI 316), galvanised steel, braked cable drum for the practical winding in and out of the stainless steel cable (AIO-SEIL-30)

TEMP-HASPEL-10-150 including 150 m stainless steel cable, weight ~85 kg

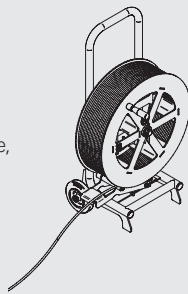

**TEMP-ENDS-10
TEMPORARY END LOCK SET
with integrated shock absorber
(EN 795 B-C)**

Substructure: Steel or concrete support
Application: Steel, façade, and bridge construction
Belt length: 4 m
Material: Aluminium (anodised), plastic, galvanised steel

Complete set for one cable span (packing unit = 2 items)

can be quickly attached and removed at any point of the stainless steel cable (AIO-SEIL-30) – attachment by means of tension strap on steel or concrete support

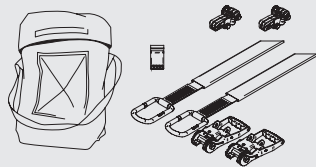

- **End lock ENDS-10**
Aluminium, anodised, Stainless steel A2, galvanised steel

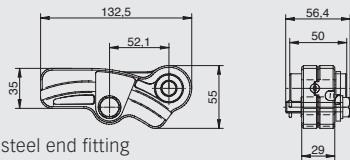

- **Polyester harness strap**
50 x 4,000 mm with powder-coated steel end fitting and protective polyester sleeve with smooth PVC coating Ø 35 x 2,000 mm

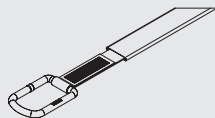

- **Ratchet**
50 mm, 18 teeth, 5,000 daN; made from galvanised steel, with plastic handle

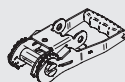

FASTENING

**BEF-412
STEEL CONSTRUCTION, CLAMPING CONSOLE**

Material: galvanised steel
Flange thickness: 10 to 40 mm
Width of steel girder: 125 to 415 mm

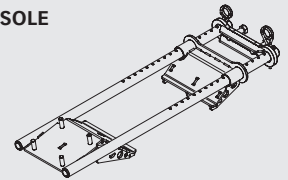

**BEF-412-1
STEEL CONSTRUCTION, GUIDE PULLEY**

Material: galvanised steel
for the creation of an end point in a temporary lifeline system (TEMP-ENDS-10)

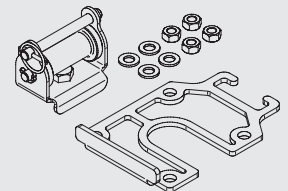

INTERMEDIATE BRACKET

**TEMP-SZH-10
TEMPORARY INTERMEDIATE BRACKET
(EN 795 B-C)**

Substructure: Steel or concrete support
Application: Steel, façade, and bridge construction
Belt length: 2.5 m
Material: Aluminium (anodised), plastic, galvanised steel

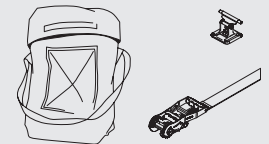

Attachment is made using a tension strap on steel or concrete support (packing unit = 1 item)

- **Intermediate bracket SZH-10**
Stainless steel A2 and nickelled steel

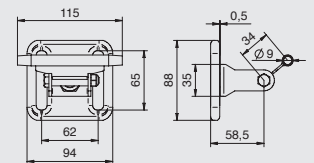

- **Polyester harness strap with sewn-in ratchet**
50 mm, 18 teeth, 5,000 daN made from galvanised steel, with plastic handle

