

PRACTICAL PACKAGING

KIT-BOX

Horizontal lifeline system

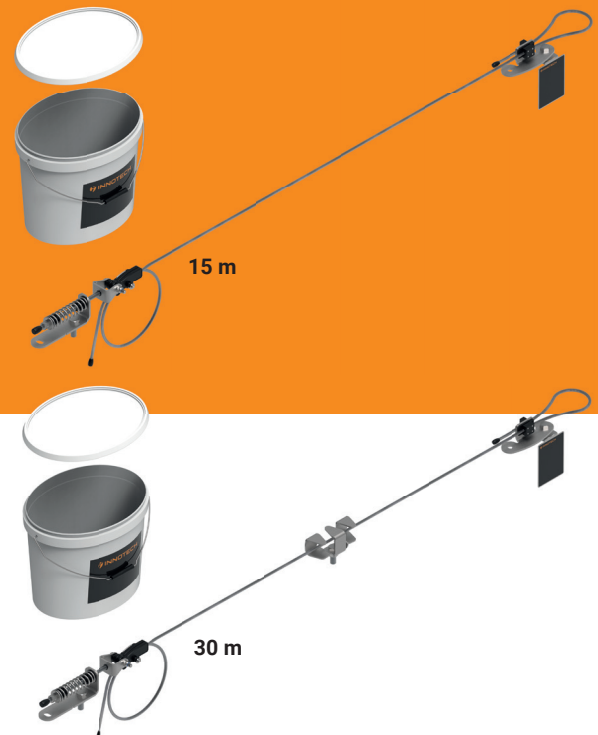

The pre-assembled horizontal lifeline system KIT BOX, in a practical reusable packaging, is outstandingly suited for rapid, simple, and flexible installation on various substructures.

- Pre-assembled horizontal lifeline system
- Two system lengths (15 m/30 m)
- Simple to install because of standardised system components
- Integrated shock absorber and constant spring pre-tension

Approved for 4 people (including 1 person for provision of first-aid), it is ideal for use on building/construction sites of all types (steel, facades, warehouse and bridge construction, etc.).

- The special shock absorber reduces the forces on the end points to a minimum in the event of a fall
- No training required
- All products in one bucket (easy to transport)
- Certification to the latest state of the art:

EN 795 TYPE C

Horizontal lifeline system

Ideal on all types of construction sites
(steel, facades, halls, bridges, etc.).

Approved for 4 people
(including 1 person for provision of first aid)

KITBOX | KIT BOX

KIT-BOX-15 PRE-ASSEMBLED HORIZONTAL LIFELINE SYSTEM (EN 795 C)

Material: stainless steel (AISI 304),
aluminium (anodised), plastic
Length: 15 m

Complete set:

- 1x end lock set
- 1x rating plate
- Stainless steel cable

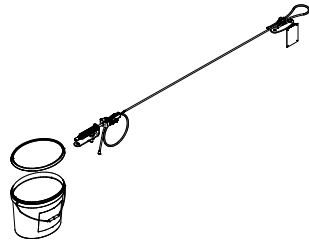

KIT-BOX-30 PRE-ASSEMBLED HORIZONTAL LIFELINE SYSTEM (EN 795 C)

Material: Stainless steel V2A (AISI 304),
aluminium (anodised), plastic
Length: 30 m

Complete set:

- 1x end lock set
- 1x rating plate
- Stainless steel cable
- 1x LIFELINE KIT SZH-10
(intermediate bracket)

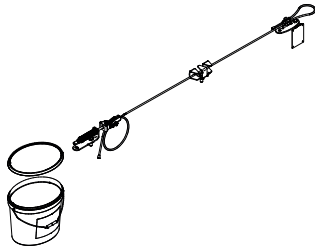

ENDS | END LOCK

END LOCK PRE-ASSEMBLED (EN 795 C)

For a straight cable span, with integrated
shock force absorption

Material: stainless steel (AISI 304), aluminium (anodised)

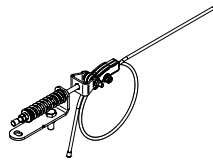

END LOCK VARIABLE (EN 795 C)

For a straight cable span, with integrated
shock force absorption

Material: stainless steel (AISI 304), aluminium (anodised)

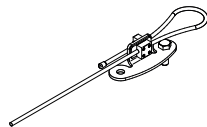

SZH | INTERMEDIATE BRACKET

LIFELINE-KIT-SZH-10 KIT - INTERMEDIATE BRACKET, TRAVERSABLE (EN 795 C)

Material: stainless steel (AISI 304)
Substructure: AIO-STA, AIO-FALZ, AIO-SAND,
AIO-VARIO, AIO-SYST, etc.
Connection: Thread M16

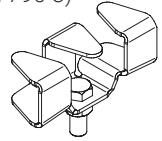

Suitable for installation on posts – traversable only with steel carabiner
Hex bolt M16 x 45 mm and hex nut M16 included in the scope of delivery

SEIL | STAINLESS STEEL CABLE

AIO-SEIL-30 STAINLESS STEEL CABLE (EN 795 C)

Material: Stainless steel (AISI 316)
Dimensions: Ø 8 mm (7 x 7)
Breaking load: 37 kN

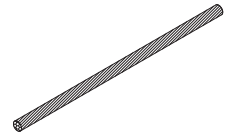

Tested for INNOTECH lifeline system