

KIT-BOX



- CZ – POZOR:** Práce s výrobkem INNOTECH je povolena teprve po kompletním přečtení a porozumění bezpečnostních pokynů a návodu k montáži.
- DE – ACHTUNG:** Die Verwendung des INNOTECH-Produkts ist erst zulässig, nachdem die Sicherheitshinweise und Montageanleitung vollständig gelesen und verstanden wurden.
- DK – GIV AGT:** Det er først tilladt at anvende INNOTECH-produktet, efter du har læst og forstået sikkerhedshenvisningerne og monteringsvejledningen.
- EN – ATTENTION:** Use of the INNOTECH product is permitted only after the safety instructions and instruction manual in the respective language have been read.
- ES – ATENCIÓN:** Solo se autorizará el uso del producto INNOTECH una vez que se hayan leído y entendido completamente las indicaciones de seguridad y las instrucciones de montaje.
- FR – ATTENTION :** L'utilisation du produit INNOTECH n'est autorisée qu'après avoir intégralement lu et compris les consignes de sécurité et la notice de montage.
- HU – FIGYELEM:** Az INNOTECH termék használatát csak akkor engedhető meg, ha a biztonsági utasításokat és az összeszerelési utasításokat teljes mértékben elolvasta és megértette.
- IT – ATTENZIONE:** L'utilizzo del prodotto INNOTECH è permesso solo previa lettura completa e comprensione integrale delle avvertenze di sicurezza e le istruzioni di montaggio.
- NL – ATTENTIE:** Dit INNOTECH-product mag pas worden gebruikt nadat u de gebruikershandleiding en de montagehandleiding volledig heeft gelezen en begrepen.
- PL – UWAGA:** Używanie produktu INNOTECH jest dozwolone dopiero po zapoznaniu się z wszystkimi zasadami bezpieczeństwa i instrukcją montażu.
- PT – ATENÇÃO:** O uso do produto INNOTECH apenas é permitido depois de terem sido lidas e compreendidas na totalidade as indicações de segurança e o manual de montagem.
- SK – POZOR:** Použitie výrobku INNOTECH je povolené až vtedy, keď si úplne prečítate a pochopíte bezpečnostné pokyny a montážny návod.
- SL – POZOR:** Uporaba izdelkov INNOTECH je dovoljena šele po tem, ko preberete in so vam jasne vse varnostne opombe in navodila za montažo.
- SV – OBS:** INNOTECH-produkten får inte användas, förrän säkerhets- och monteringsinstruktionerna har lästs igenom och förstås fullständigt.
- TR – DİKKAT:** INNOTECH ürününün kullanılmasına ancak güvenlik uyarılar ve montaj talimatı tamamen okunup anlaşıldıktan sonra izin verilir.
- ZH – 注意:** 只有在完全阅读并理解安全提示和装配说明书之后,才允许使用INNOTECH产品。



1



2



2

3



4

4



6

5



10

6



14

7



16

8



17

2

INNOTECH KIT-BOX

 EN 795:2012 TYP C
 DIN CEN/TS 16415:2017

XXXX ■ XXXX ■ XXXX ■



»» NEXT

№

12-10-Aufkleber-A





KIT-BOX-15

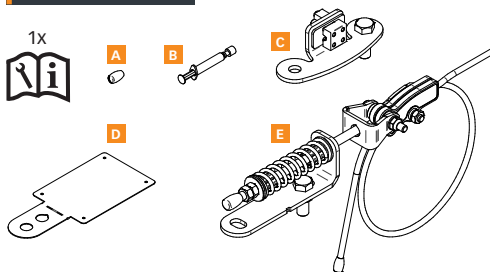

A 1x Ø 12 mm

B 1x WEICON AntiSeize ASW 10000

C 1x KIT-BOX ENDS

D 1x TYP, 225 x 100

E 1x KIT-BOX ENDS, 15m

KIT-BOX-30

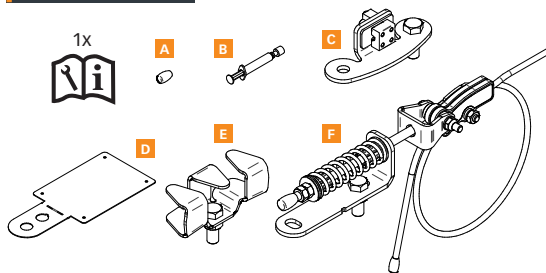

A 1x Ø 12 mm

B 1x WEICON AntiSeize ASW 10000

C 1x KIT-BOX ENDS

D 1x TYP, 225 x 100

E 1x LIFELINE-KIT-SZH-10

F 1x KIT-BOX ENDS, 30m



[mm]

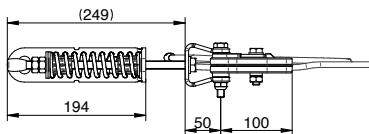
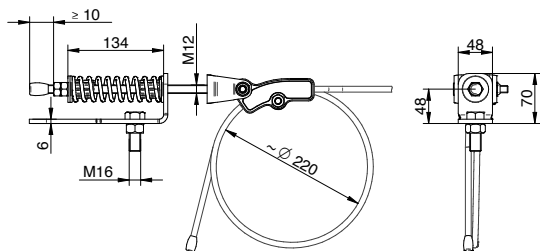
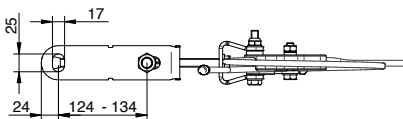



[mm]

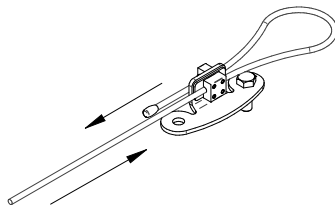
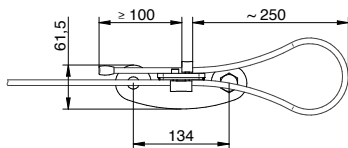
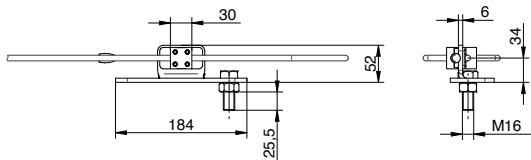

4



24

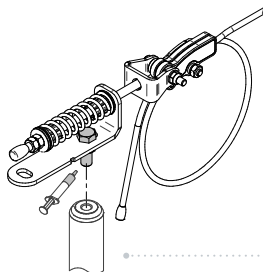

24

FISCHER /
HILTI

[mm]

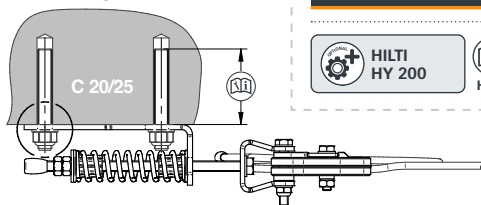
MONT-FIS-SB-390-S
FISCHER FIS-SB-390-SHILTI
HY 200

HILTI

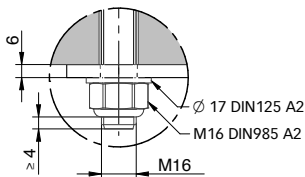

4



2x



24



24



Nm

FISCHER /
HILTI

[mm]

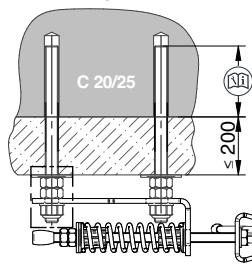

MONT-FIS-SB-390-S
FISCHER FIS-SB-390-S



HILTI
HY 200



HILTI

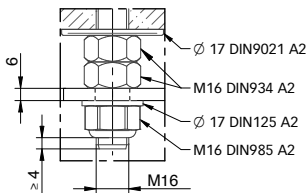

4



[mm]

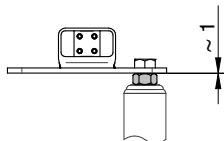
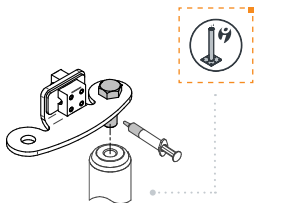

[mm]

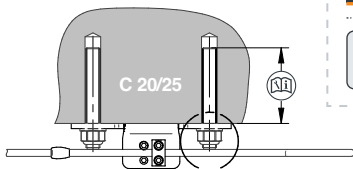
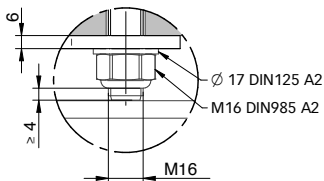
FISCHER /
HILTIHILTI
HY 200



[mm]



2x



24



24

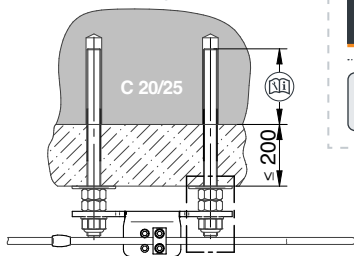

Nm

FISCHER /
HILTIMONT-FIS-SB-390-S
FISCHER FIS-SB-390-SHILTI
HY 200

HILTI

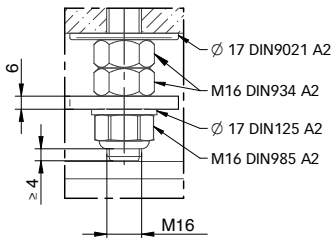



1.

[mm]

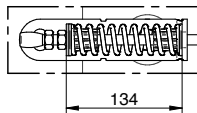
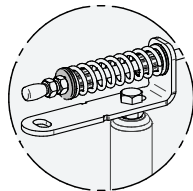
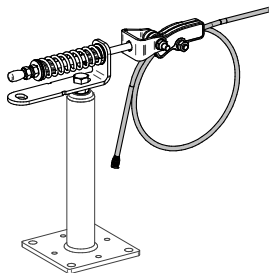

5



2.

[mm]



PSA-TAPE

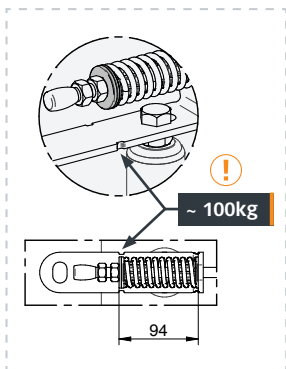
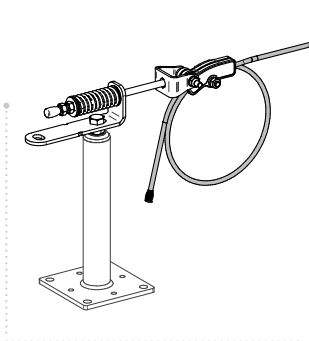
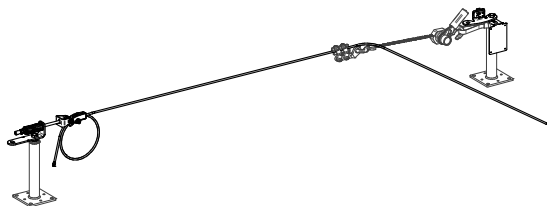

5



3.

[mm]

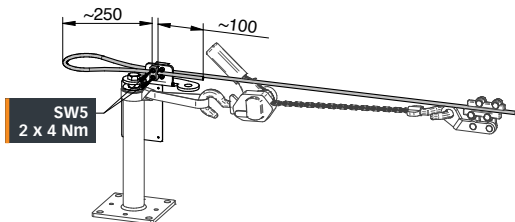
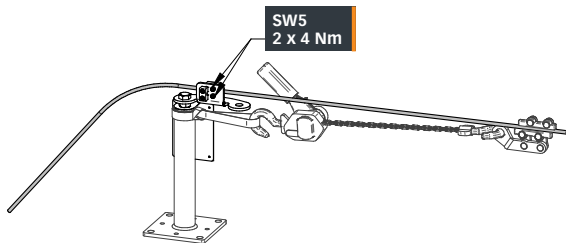
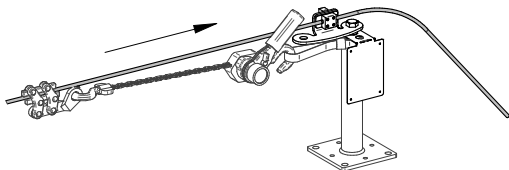

5



4.

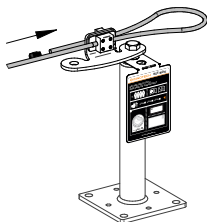

5.

[mm]



2x



19

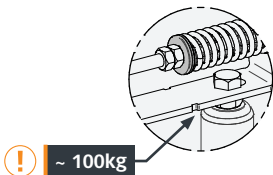
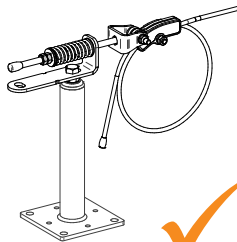
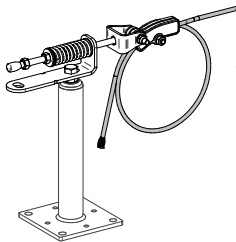

~ 100kg

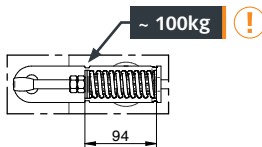

~ 100kg



94

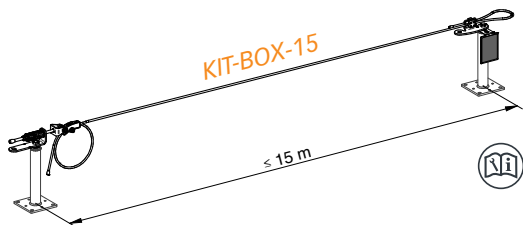

≤ 15m



≤ 15°



≤ 3m

STA-10-600

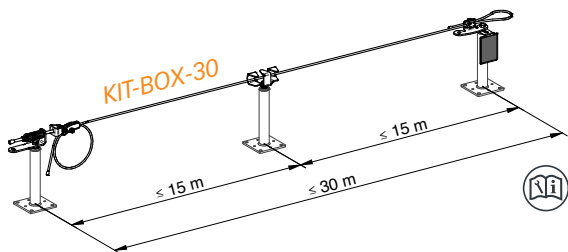

≤ 15m



≤ 15°



≤ 3m

STA-10-600

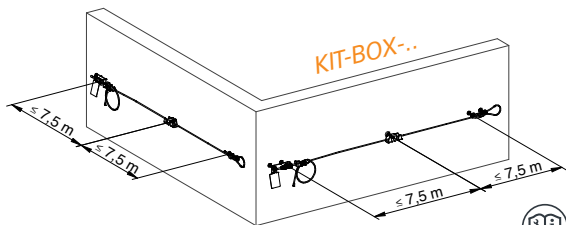

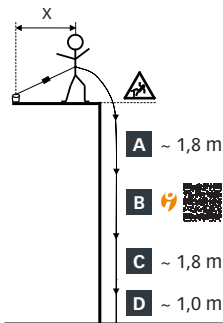

A	PSA + Falldämpfer <i>PPE + shock absorber</i>	~ 1,80 m
B	Seilauslenkung <i>Cable deflection</i>	
C	Körpergröße <i>Body height</i>	~ 1,80 m
D	Sicherheitsabstand <i>Safety distance</i>	~ 1,00 m
Σ	Mindestfallhöhe <i>Minimum fall height</i>	Σ

PLANUNG & STATIK | PLANNING & STATICS



DE



EN



ES



FR



NL

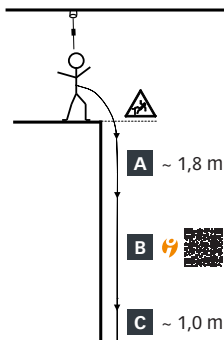

A	PSA + HSG (Höhensicherungsgerät) <i>PPE + fall arrest device</i>	~ 1,80 m
B	Seilauslenkung <i>Cable deflection</i>	
C	Sicherheitsabstand <i>Safety distance</i>	~ 1,00 m
Σ	Mindestfallhöhe <i>Minimum fall height</i>	Σ

INNOTECH WEB-APP

INNO|doc

Simple. Clear. Document.



www.innotech.at/de/innodoc

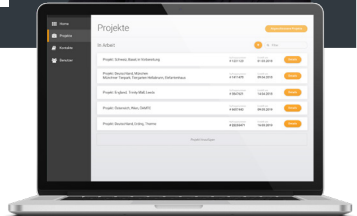

INNOTECH Arbeitsschutz GmbH

Laizing 10, A-4656 Kirchham

T: +43 7619 22122-0

office@innotech.at | www.innotech.at



KIT-BOX
www.innotech.at