

TAURUS GLEIT-A-31

Instructions for installation and use



DE – ACHTUNG: Die Verwendung des Innotech-Produktes ist erst zulässig nachdem die Gebrauchsanleitung in der jeweiligen Landessprache gelesen wurde.

DE

EN – ATTENTION: Use of the Innotech product is only permitted after the instruction manual has been read in the respective national language.

EN

IT – ATTENZIONE: L'utilizzo del prodotto Innotech è permesso solo previa lettura del manuale di istruzioni nella lingua del paese corrispondente.

IT

FR – ATTENTION : L'utilisation du produit Innotech n'est autorisée qu'après la lecture du mode d'emploi correspondant dans la langue du pays.

FR

NL – ATTENTIE: Het gebruik van dit Innotech product is pas toegestaan, nadat de gebruikshandleiding in de taal van het betreffende land gelezen werd.

NL

SV – O B S : Denna Innotech-produkt får inte användas, förrän bruksanvisningen på respektive lands språk har lästs igenom.

SV

DK – GIV AGT: Det er først tilladt at anvende Innotech-produktet, før end brugsvejledningen på det pågældende lands sprog er læst.

DK

ES – ATENCIÓN: El uso del producto Innotech sólo está permitido después de que se hayan leído las instrucciones de uso en el idioma del respectivo país.

ES

PT – ATENÇÃO: O uso do produto Innotech apenas é permitido depois de ter lido as instruções de uso na respectiva língua nacional.

PT

PL – UWAGA: korzystanie z produktu Innotech jest jedynie dozwolone po przeczytaniu podręcznika w języku narodowym.

PL

RO – ATENȚIE: Utilizarea produsului Innotech este autorizată abia după ce au fost citite instrucțiunile originale de utilizare în limba țării respective.

RO

SL – POZOR: Uporaba izdelka Innotech je dovoljena šele po tem, ko navodila preberete v svojem jeziku.

SL

CZ – POZOR: Práce s výrobkem Innotech je povolena až po prostudování návodu k použití v příslušném jazyce daného státu.

CZ

SK – POZOR: Používanie výrobku Innotech je povolené až potom, keď ste si prečítali návod na obsluhu v jazyku príslušnej krajiny.

SK

HU – FIGYELEM: Az Innotech termékek használatra csak az után engedélyezett, miután saját nyelvén elolvasta a használati utasítást.

HU

ZH – 注意: 只有在阅读了当地语言的使用说明后, 才能使用 Innotech 公司的产品。

ZH

Prior to use, the following safety instructions and the current state of the art must be taken into consideration.

- INNOTECH "TAURUS GLEIT-A-31" may be used only in combination with the INNOTECH "TAURUS" rail system.
- Read this instruction manual completely.
- Read the instructions for installation and usage for the INNOTECH "TAURUS" rail system fully. (Comply with the safety instructions!)
- These instructions for installation and use must be stored by the person responsible for the site, and made available to the user.
- Understand and accept the options and restrictions of the safety system and the protective equipment used, as well as the risks associated with its use.
- If uncertainties arise during installation/use, it is imperative that you contact the manufacturer. (www.innotech.at)
- If the equipment is sold in another country, the instructions for installation and use must be provided in the respective national language.
- For horizontal use, only lanyards that are suited for this purpose and that have been tested for the respective edge design (sharp edges, trapezoidal sheeting, steel girders, concrete, etc.) may be used.
- The attachment to the vertical rail system is made through the rail slider ("TAURUS GLEIT-A-31"), always using the original carabiner, and must take place by means of a safety harness as per EN 361. The maximum distance between the slider's energy absorber and the front fall-arrest eyelets must not exceed 17 cm (= 1 carabiner length). Attention: Use only a carabiner (EN 362) that is suitable and has been tested for this use.
- Ensure that PPE is securely in place and use only the front fall-arrest eyelet of the safety harness in vertical use.
- If the belt becomes loose during ascent or descent, then it must be correctly readjusted from a secured position.
- It is essential for the user's safety that the release for the entry/exit "TAURUS EA-11" is actuated only from a safe position that does not carry a risk of falling.
- Because of the danger of an invisible stress corrosion crack, guided type fall arresters (including fixed anchorage line) consisting of corrosion-resistant steel must not be installed in a highly corrosive atmosphere (e.g. over a swimming pool), unless special inspection measures are implemented or the compatibility is demonstrated.

If there are any doubts concerning the reliable operation of the rail slider, it must no longer be used, and it must be checked by an expert (written documentation). If necessary, the product must be replaced immediately.

2.1 CHECK BEFORE EVERY USE

- Easy movement of the running rollers
- Anchorage device can be turned easily
- No damage to the energy absorber
- No deformations (e.g.: tilting of the running rollers,...)
- No corrosion
- Indications of wear or bearing damage
- No damage

2.2 ANNUAL INSPECTION

The "TAURUS GLEIT-A-31" must be inspected at least once per year by a technical expert who is familiar with the safety system, as the user's safety depends on the effectiveness and reliability of the equipment. Shorter inspection intervals may be required, depending on the intensity of use and the environment. Testing by the technical expert must be documented in the test sheet and test log in the "TAURUS" instructions for installation and use, and must be stored along with these instructions for use.

INSPECTION POINTS:

as section 2.1

- Glued-in threaded joints secured
(4 x running roller axle + 4 x rotating release device)
- Rubber on the 2 running rollers not damaged/worn
(2 x running roller rubber lining)

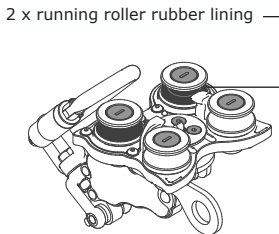
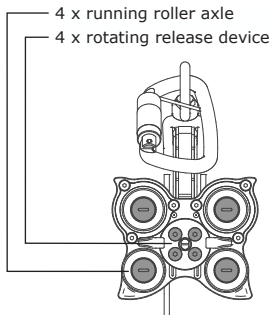

2

INSPECTION

2.3 ATTENTION! DO NOT USE ANY LONGER IF:

- Damage or wear to its components is obvious
- Stress has occurred due to falling
- Damage is determined during regular inspections
- The product identification is no longer legible

3

CARE/STORAGE

INNOTECH "TAURUS GLEIT-A-31" is maintenance-free.

It is recommended to keep the rail slider together with the PPE.

During transport, protect against UV radiation, chemicals, moisture, and other environmental effects.

IF NECESSARY:

Clean harness rail slider with a soft and lukewarm water, rinse off with clean water and air dry.

4

WARRANTY

Under normal conditions of use there is a two year warranty against manufacturing defects on all components. However, if the rail slider is used in particularly corrosive atmospheres, this period may be shortened.

If there is strain (a fall), the warranty claim is void for those components that have been designed to absorb energy, or that may possibly be deformed and therefore must be replaced. Attention: INNOTECH does not assume any warranty in the event of improper installation.



5

STANDARDS

INNOTECH "TAURUS GLEIT-A-31" was tested and certified as a horizontal and vertical rail slider ("moveable anchor point" or "guided type fall arrester") for the INNOTECH "TAURUS" rail system, as per **EN 795:2012 TYPE D + DIN EN 353-1:2018**

THE NOTIFIED ORGANISATION PARTICIPATING IN THE TYPE TEST:

DEKRA Testing and Certification GmbH, Dinnendahlstr. 9, 44809 Bochum, Germany
CE 0158

- A) Name or logo of the manufacturer/reseller: INNOTECH
- B) Type designation: TAURUS GLEIT-A-31
- C) Number of the relevant standard: EN 795:2012 TYPE D
DIN EN 353-1:2018
CE 0158
- D) DEKRA Testing and Certification GmbH:
- E) Year of manufacture and manufacturer's serial number: 20XX/XXXX
- F) Signs stating that instructions in the manual must be followed: 
- G) Maximum number of persons that can be secured: 1 (50-140kg
incl. clothes + equipment)
- H) Use only together with the INNOTECH rail system: "TAURUS"  INNOTECH TAURUS



"TAURUS GLEIT-A-31": Stainless steel V2A/V4A

"End cap": Polyethylene

7.1 DIMENSIONS

[mm]

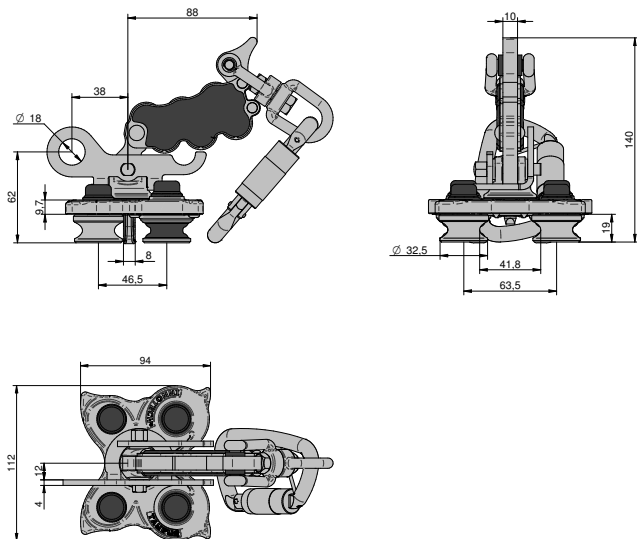

[mm]

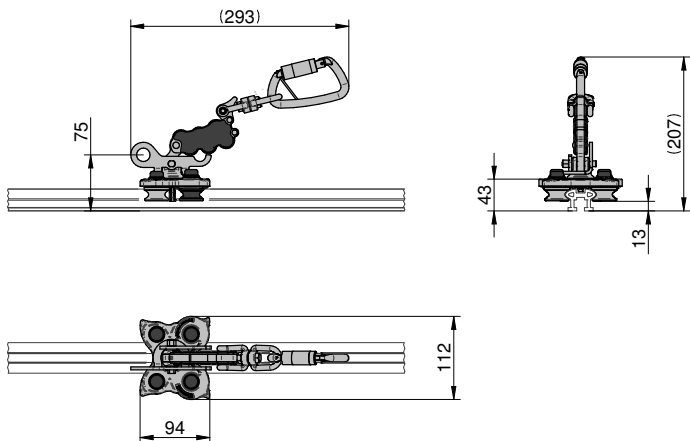

The "TAURUS GLEIT-A-31" allround rail slider is characterised by resistance-free travel along the entire "TAURUS" horizontal or vertical rail system. (straight sections and curves)

It was developed to ensure complete freedom of movement for the user, without having to detach or attach the slider to/from the safety system. The rotatability of the slider's anchorage eye means that the rail system can be used from both sides.

Approved as a "mobile anchorage point" or "guided type fall arrester" (RAIL SLIDER) for **1 person** on the horizontal and vertical INNOTECH "TAURUS" rail system (tested as per EN 795:2012 TYPE D + DIN EN 353-1:2018).

"TAURUS GLEIT-A-31" is not suitable for use as part of "overhead systems".

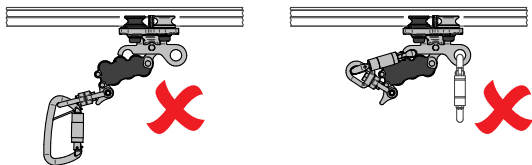

The use of fall arrest devices is not permitted.

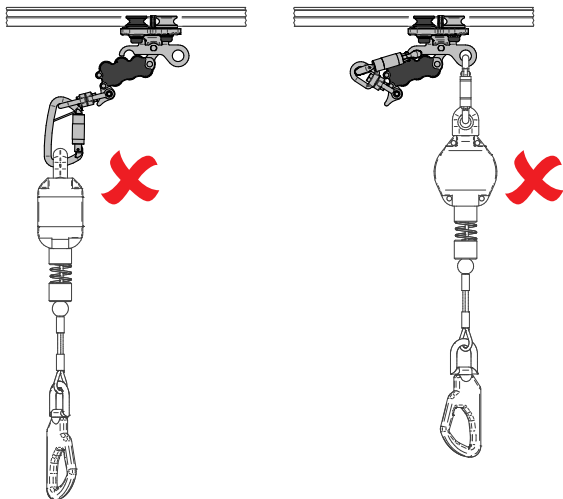

Suitable for the following fall protection systems in accordance with EN 363:2008

- Restraint systems
- Fall arrest systems
- Rescue systems

Safe use requires that you observe the corresponding specifications provided by the PPE manufacturers.

For safety reasons, we recommend that you always use fall arrest systems as restraint systems. "TAURUS GLEIT-A-31" is not suitable for descent energy (rope access systems (EN 363:2008)).

The user must be capable of selecting and properly handling the "Personal Protective Equipment (PPE) against falls from a height", taking into account EN 363:2008.

Every person working in areas where there is a danger of falling is personally responsible for paying attention to the fall height. The connection to the anchorage device must be kept as short as possible in order to limit free fall.

10.1 VERTICAL USE

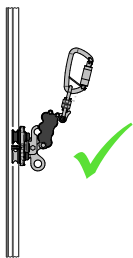
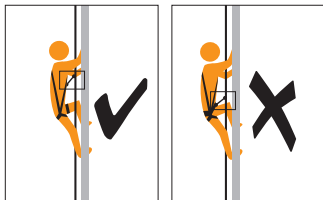

The maximum distance between the slider's energy absorber and the front fall-arrest eyelets must not exceed 17 cm (= 1 carabiner length).

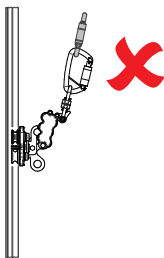

NEVER clip on two carabiners one after another.

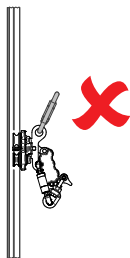

Use the eye **ONLY** for horizontal and facade access.

10.2 HORIZONTAL/FACADE USE (CARABINER)

The appropriate "personal protective equipment (PPE) against falls" is connected to the original carabiner of the "TAURUS GLEIT-A-31" as per the instructions of the PPE manufacturer (see instructions for use of the PPE).

(e.g. EN 353-2 or EN 354 + EN 355, etc)

(e.g. "INNOTECH BRAKE")

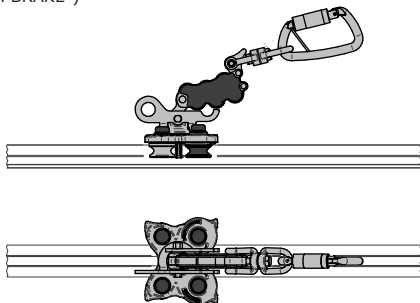

10.3 HORIZONTAL/FACADE USE (EYE)

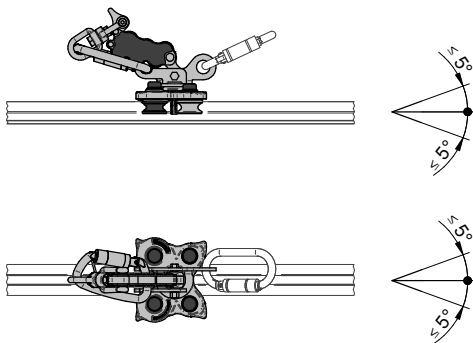

Horizontal/facade use with the eye only at $0^\circ \pm 5^\circ$

The minimum free space required between the fall point and the ground is calculated as follows:

Free-fall height¹ (height of the unchecked fall until the PPE stops the fall)

- + max. deflection of rail after fall (max. 0.30 m)
- + energy absorber and braking distance of the rail slider (max. 1.00 m)
- + manufacturer's instructions for the fall protection PPE
- + shift of the fall-arrest eyelet on the safety harness as per EN 361 (approx. 1.00 m)
- + safety distance: 1.00 m

¹ can be avoided in many cases if positioned and used in the proper manner.

12

LOAD DIRECTIONS

12.1 VERTICAL USE

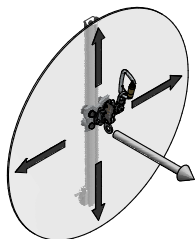

Vertical

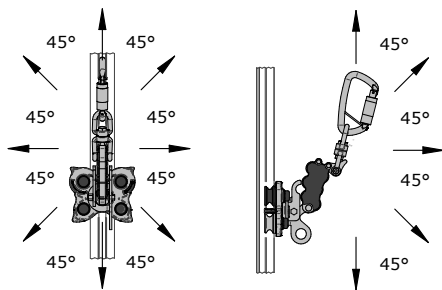

12.2 HORIZONTAL USE (CARABINER)

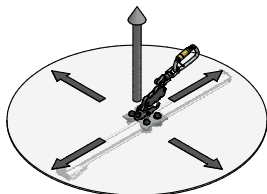

Horizontal

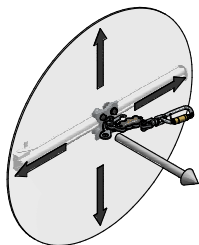
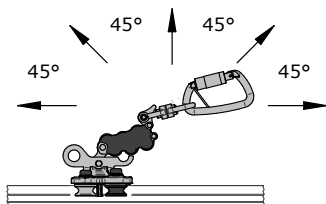

Facade

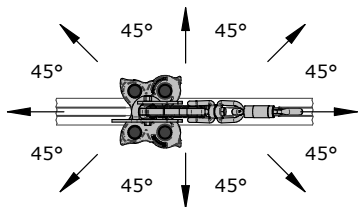

12.3 HORIZONTAL USE (EYE)

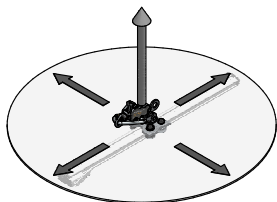

Horizontal

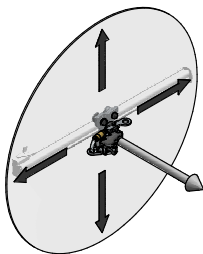
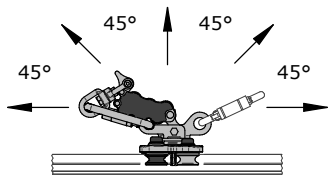

Facade

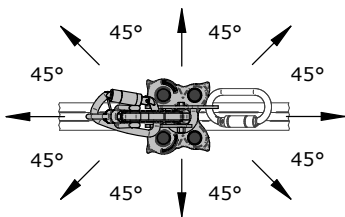

When using the anchorage line, the maximum load corresponds to a maximum user weight of 140 kg. During a fall, the maximum load is restricted to less than 6 kN.

The rail slider is part of your "TAURUS" horizontal and vertical rail safety equipment. It can be attached or removed only when climbing on or off the "TAURUS EA-11". However, do not forget that the restraint of a person ends with detachment from the system, and if a risk of falling is still present then suitable secondary protective equipment must be present.

Climbing on/off EA-11

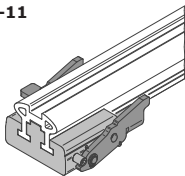

Attaching the "TAURUS GLEIT-A-31" to the rail system

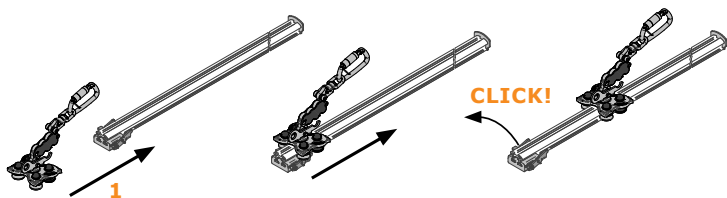

Detaching the "TAURUS GLEIT-A-31" from the rail system

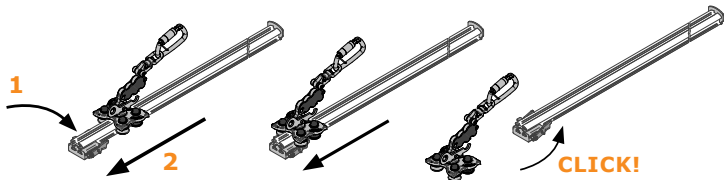

INNOTECH Arbeitsschutz GmbH, Laizing 10, 4656 Kirchham/Austria.
www.innotech.at

