

SL-NTS24CV60W-CA

24V DC Power Supply with 60 Watt



PRODUCT FEATURES

- » 24 Volt DC power supply unit with 1.8 meter connection cable
- » Direct connection of up to 5 x 24V DC Led lights or Siro Receiver
- » 60 watts, maximum output power
- » Connection of wired sensors (TOUCH, PIR, DOOR, DOUBLE DOOR, HIDDEN TOUCH) to control the power supply output
- » 4-pin sensor connection for sensors from common manufacturers
- » **Wired sensors must not be used in combination with PUSHPOWER receivers!**
- » Short-circuit protection & overload protection
- » Low stand-by consumption < 0.23 watts

TECHNICAL DRAWING

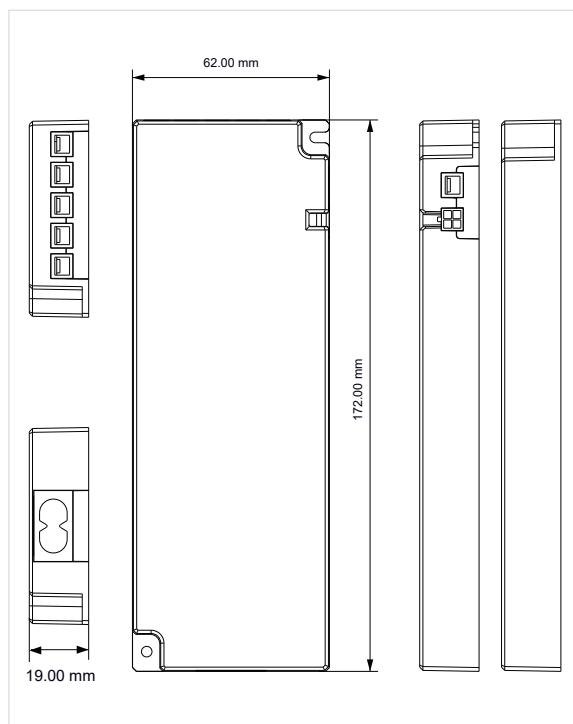

TECHNICAL DATA

- » Input voltage: 200 - 240V AC
- » Output voltage: 24V DC
- » Output current: 2.5 A
- » Power: 60 Watt
(10% reserve recommended)
- » Efficiency: 89 %
- » Standby P: 0.23 W
- » Idle power P_{no}: N/A
- » Networked standby power P_{net}: N/A
- » Protection class: IP 20
- » Mains frequency input: 50 - 60 Hz
- » Housing color: white
- » Ambient temperature: -20° - +45°C
- » Protection: Short-circuit &
..... Overload protection
- » Length: 172.00 mm
- » Width: 62.00 mm
- » Height: 19.00 mm
- » Weight: 246 g



Darf nicht in den Hausmüll entsorgt werden.
Must not be disposed of in household waste.

SIRO Beschläge- und
Metallwarenfabrik Ges.m.b.H.
Spiefeldstraße 12
4452 Ternberg, Austria

Tel . +43 (0)7256.6020.0
Fax . +43 (0)7256.8932
E-Mail office@siro.at
Web . www.siro.at

© 2026 Alle Rechte
vorbehalten.
All rights reserved
Version 04/26