

# Monteringsanvisning

## Fönsterlås 2820

Montera karmfäste  
med 2 vanliga skruvar.

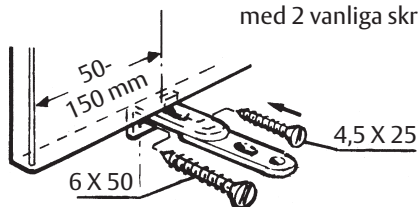

Provmontera cylinder-  
låshuset med 2 vanliga  
skruvar.

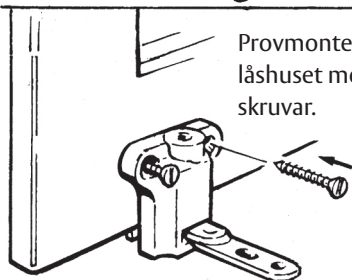

Prova funktionen.

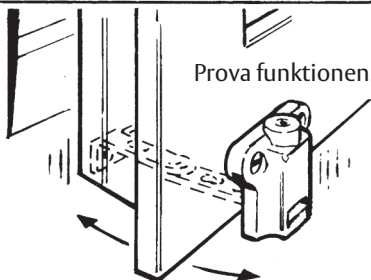

Slutmontera med  
envägsskruv och  
plastplugg.

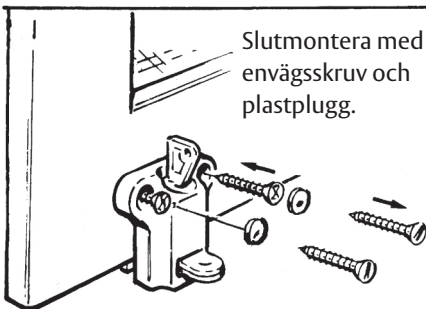

OBS! Lossa skruven försiktigt.  
Vrid ej cylinder i förhållande till tappen när  
skruven är lös.

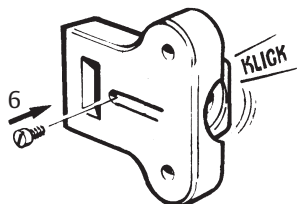
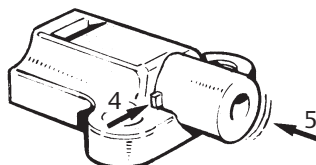
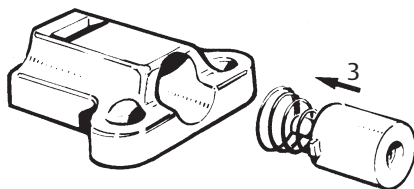
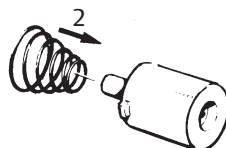
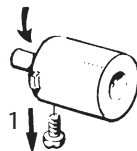

**ASSA®**  
ASSA ABLOY

ASSA OEM AB  
Box 121 99  
402 02 Göteborg  
Tel. 031 - 704 40 00  
info.gbg@assaoem.se  
www.assaoem.se

Fönsterlås 2820 är godkänd av SBSC.  
Gäller endast i stängt läge, ej i ventilationsläge.

# Fitting instructions

## Window lock 2820

Fit the frame fixture with 2 ordinary screws.

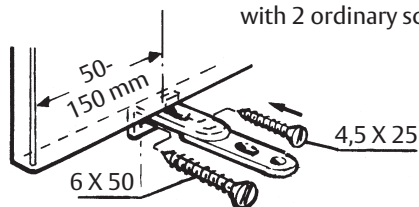

Fit the cylinder lock housing with 2 ordinary screws

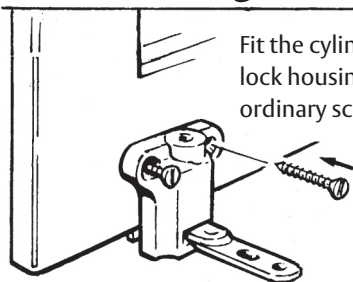

Test the function.

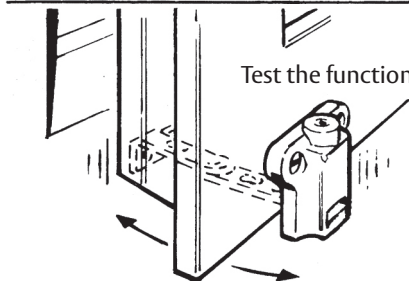

Change the screws to one-way-screws and plastic cover

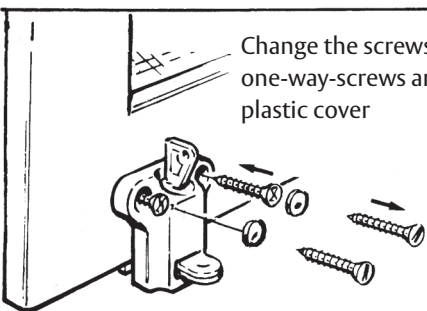

N.B. Loose the screw carefully. The cylinder should not be turned in relation to the pin when the screw is loosened.

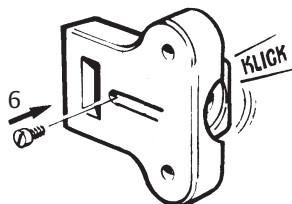
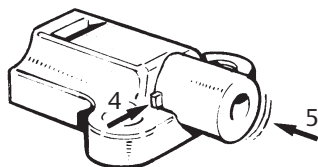
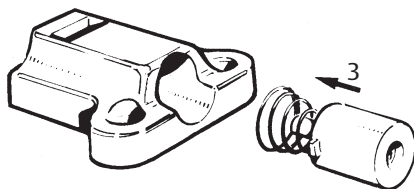
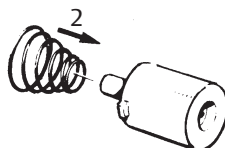
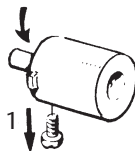

**ASSA®**  
ASSA ABLOY

ASSA OEM AB  
Box 121 99  
402 02 Göteborg  
+46 (0)31-704 40 00  
info.gbg@assaoem.se  
www.assaoem.se

Window lock 2820 is type-approved.  
Valid only in closed position, not valid in ventilation position.

OEM9025.1112.112&/ KT 858