

HONDA

INSTALLATION INSTRUCTIONS

Accessory
AUX CODE
P/N 08A87-MKC-A00

Application
GL1800/B/BD/D

Publication No.
MII
Issue Date
July 2017

Honda Dealer: Please give a copy of these instructions to your customer.

PARTS LIST

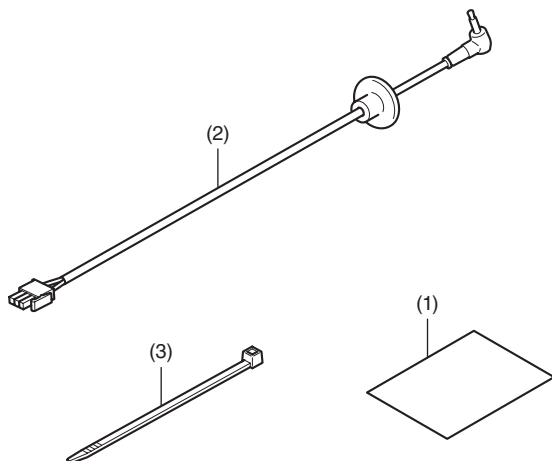

No.	Description	Qty
(1)	Installation Instructions URL	1
(2)	AUX code	1
(3)	Wire tie	1

SUPPLIES REQUIRED

Nippers

Scale

Masking tape

Synthetic detergent solution

(Water : Synthetic detergent / 100 : 1)

Shop towel

INSTALLATION

⚠ CAUTION

- To prevent burns, allow the engine, exhaust system, radiator, etc., to cool before installing the accessory.

NOTE:

- Disconnect the negative (-) cable from the battery before installing this accessory.
- The memories of the clock will be erased when you disconnect the battery. Reset the memories after reconnecting the battery.
- Reinstall the removed parts on the motorcycle and make sure that the wires and harnesses are not pinched.
- Trim the excess ends off the wire ties after attaching them to the wire harnesses. Do not allow the cut part of the wire tie to interfere with another harness or brake hose.

- Open the left saddlebag lid as shown.

- Repeat on the right side.

<Left side>

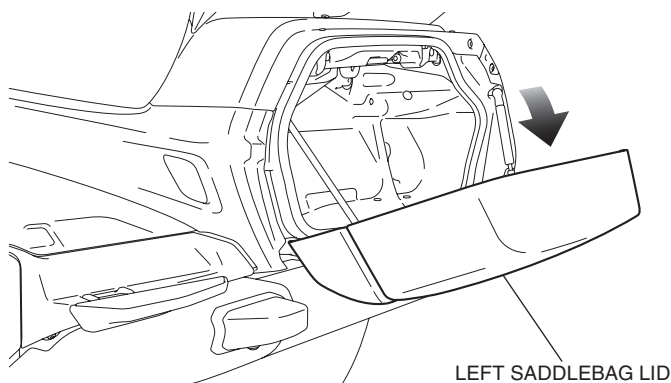

- Remove the left side cover as shown, and disconnect the negative (-) cable of the battery.

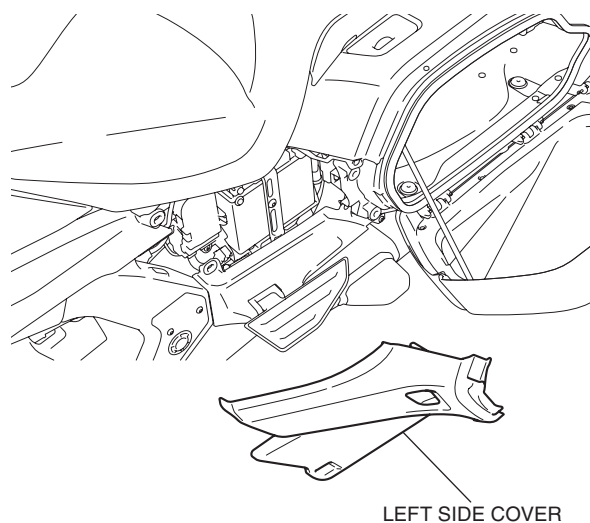

- Remove the right side cover in the same manner as the left side.

4. Remove the seat as shown.

- **Disconnect the connector for GL1800/D.**

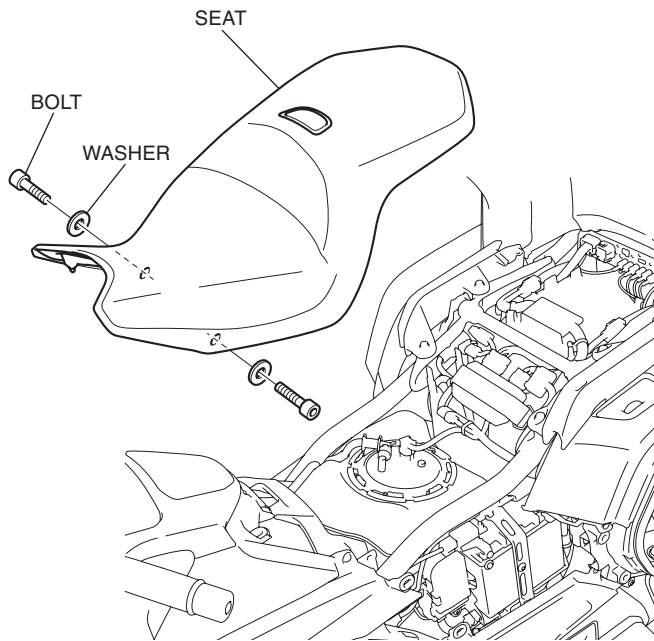

5. Fold down the left rear view mirror backward as shown.

<Left side>

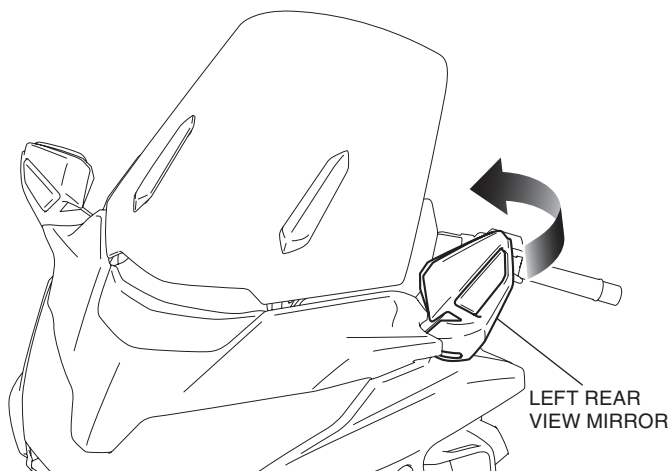

6. Remove the left mirror arm panel as shown.

<Left side>

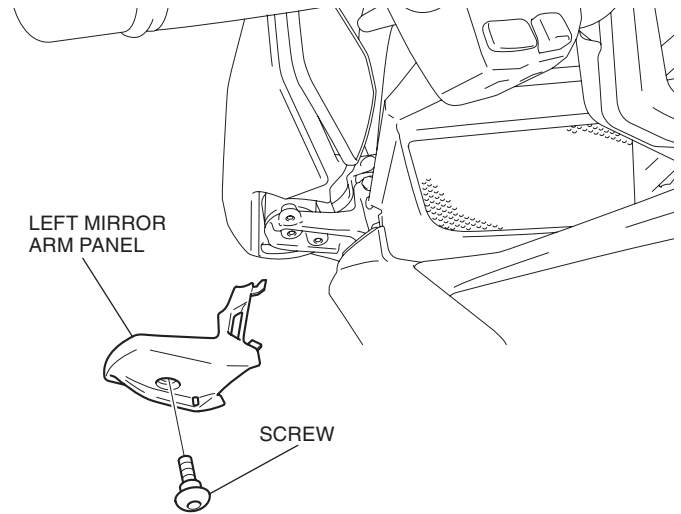

7. Remove the left rear view mirror as shown.

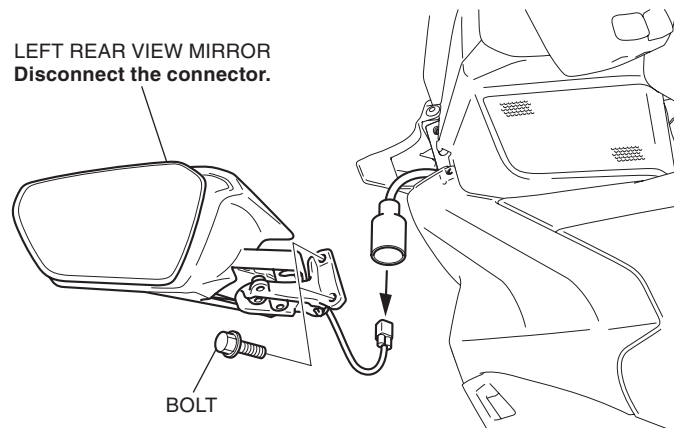

8. Remove the right mirror arm panel and right rear view mirror in the same manner as the left side.

9. Remove the screw as shown.

- **Repeat on the right side.**

<Left side>

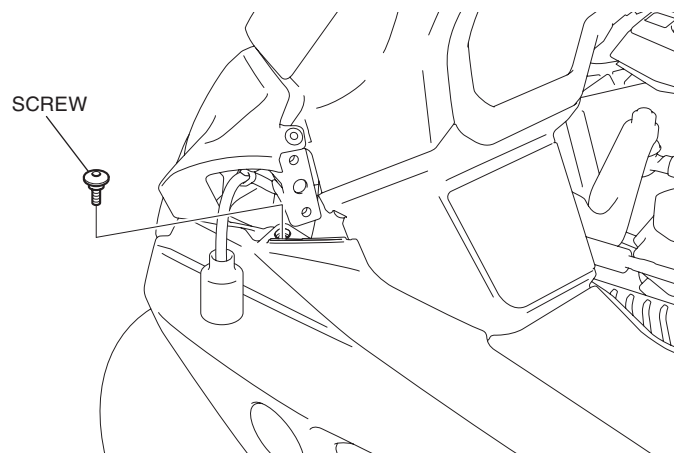

10. Remove the left deflector panel as shown.

<Left side>

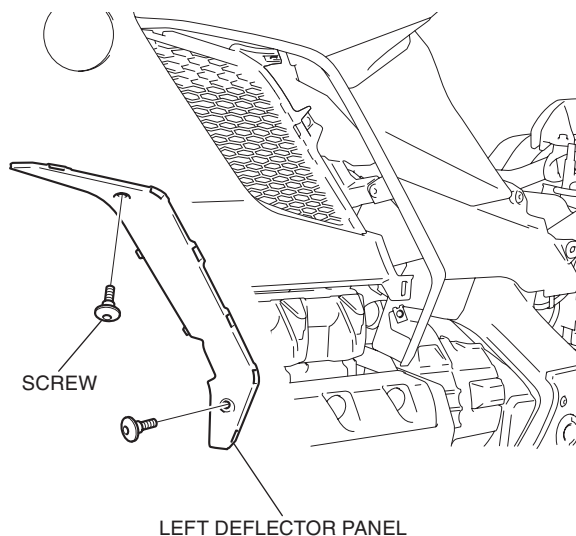

11. Remove the clip as shown.

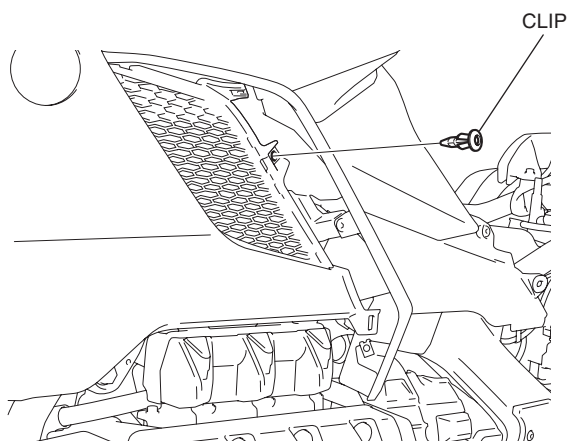

12. Remove the left inner cowl as shown.

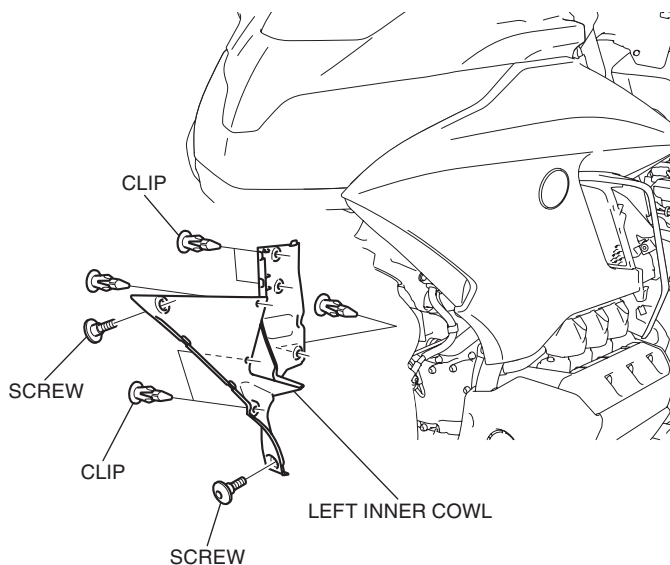

13. Remove the clip as shown.

<Left side>

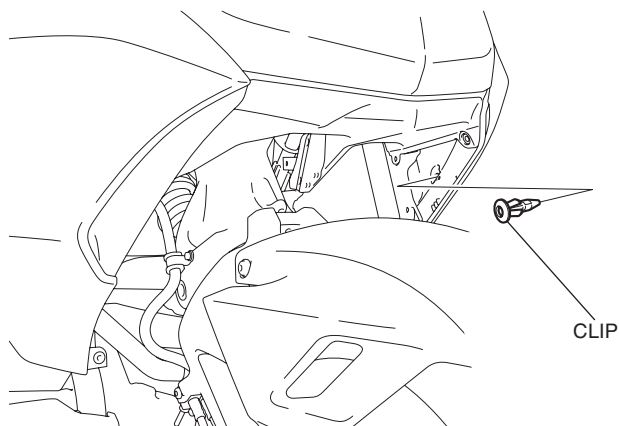

14. Remove the left middle cowl as shown.

<Left side>

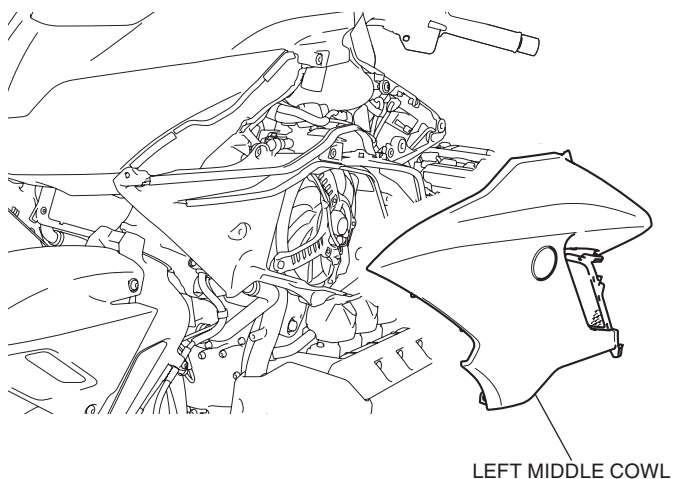

15. Remove the right deflector panel, right inner cowl and right middle cowl in the same manner as the left side.

16. Remove the parts as shown.

- Repeat on the right side.

<Left side>

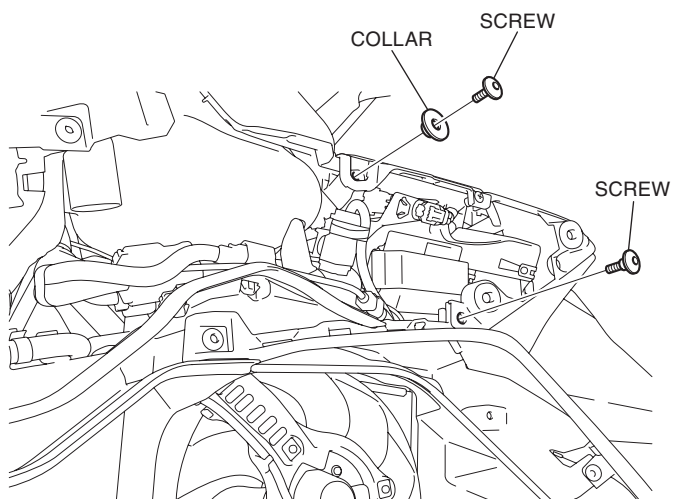

17. Remove the connector as shown.

<Right side>

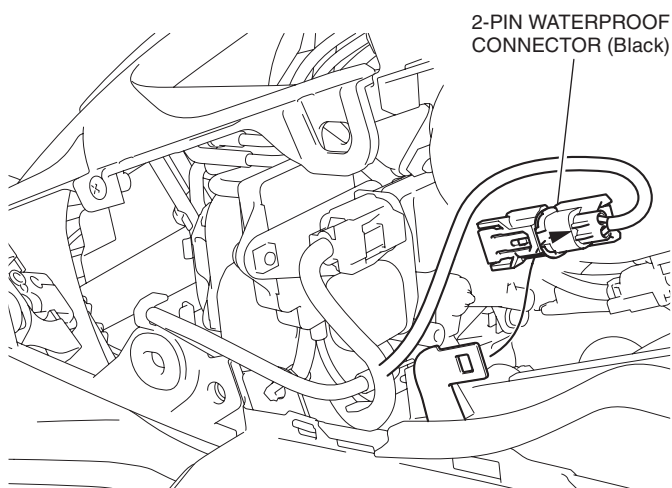

18. Remove the clip and disconnect the connector as shown.

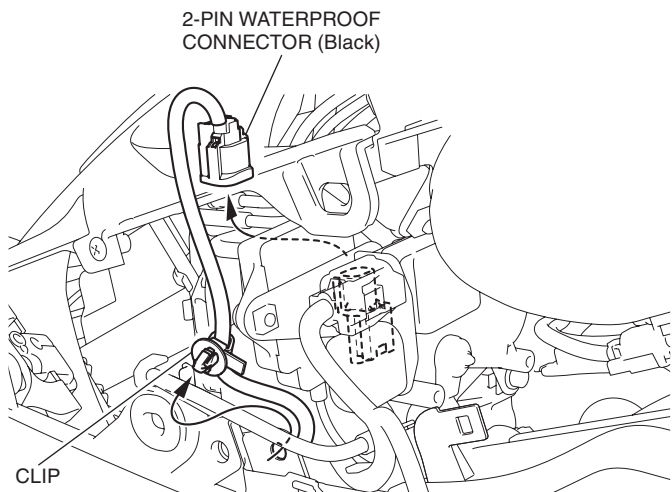

19. Remove the right outer air guide as shown.

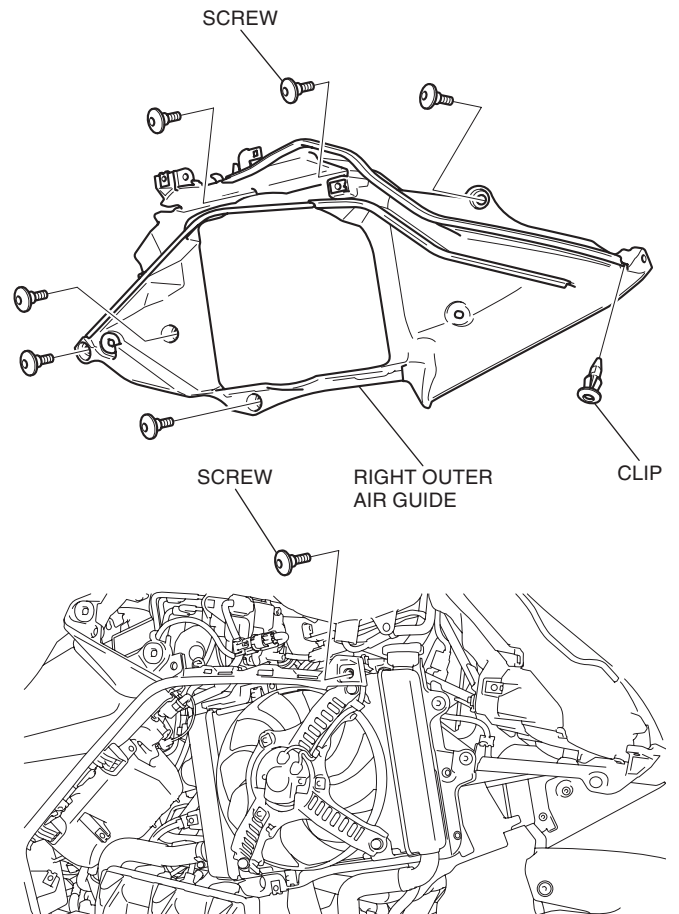

20. Remove the pocket cable as shown.

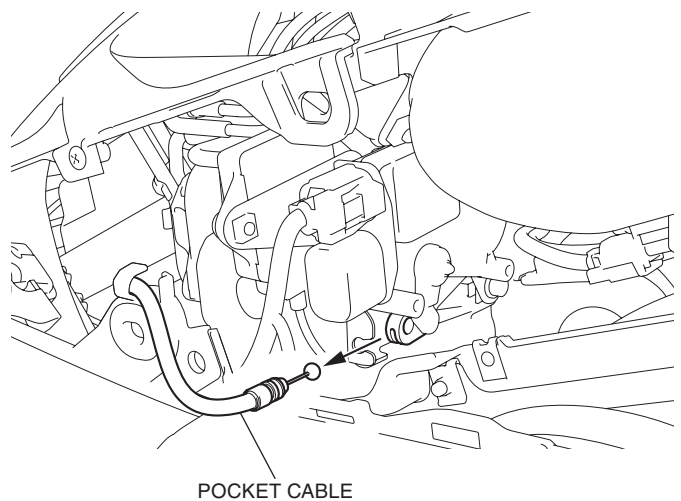

21. Remove the parts as shown.

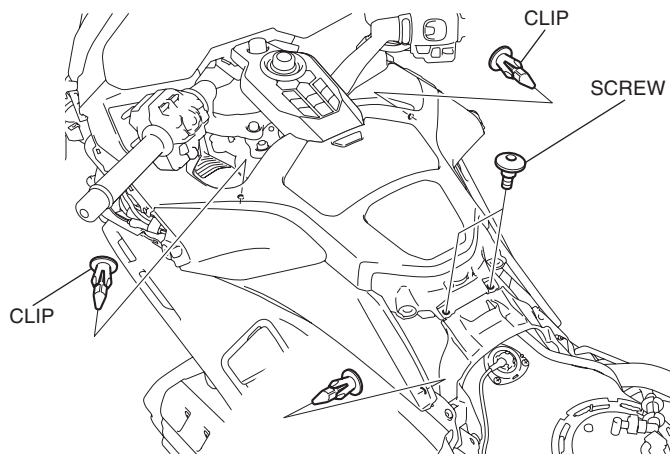

22. Remove the shelter as shown.

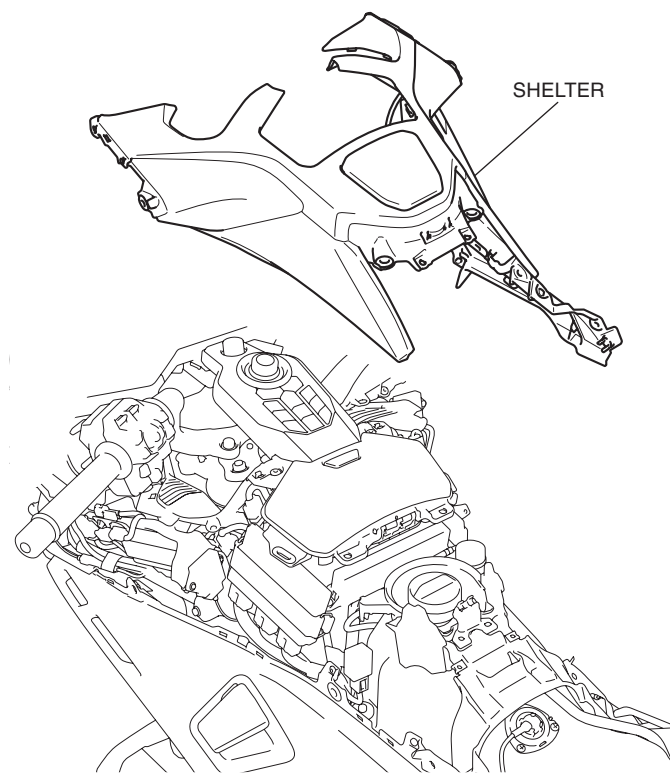

23. Open the pocket, remove the grommet as shown.

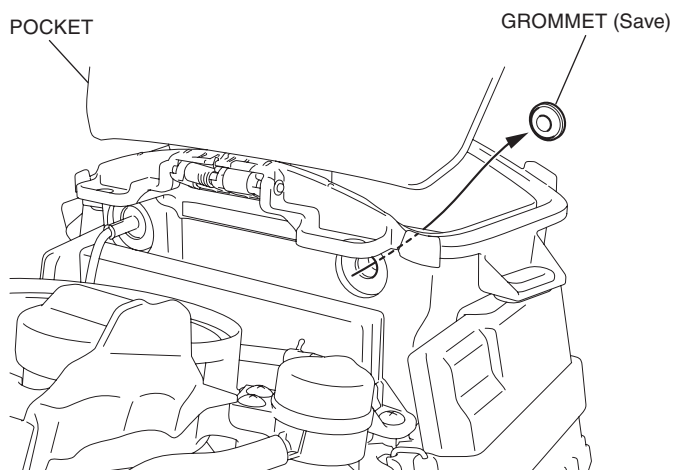

24. Secure the AUX code with the wire tie as shown.

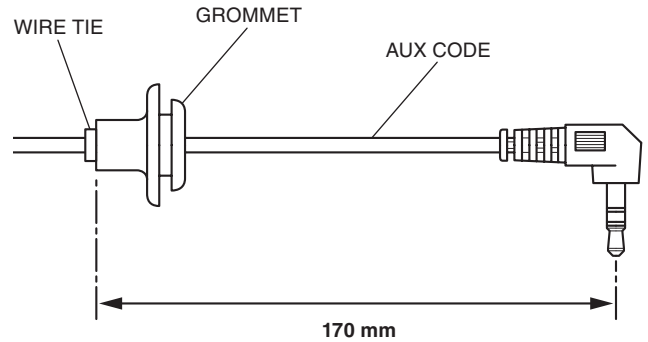

25. Attach the masking tape as shown.

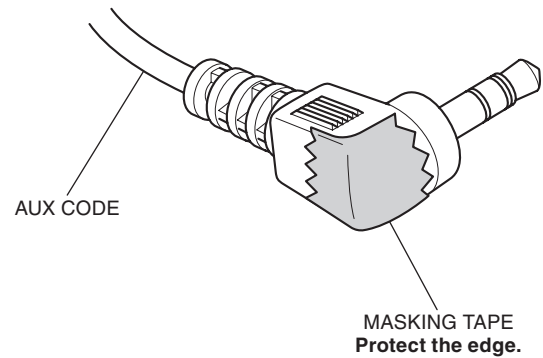

26. Apply synthetic detergent solution to the position shown.

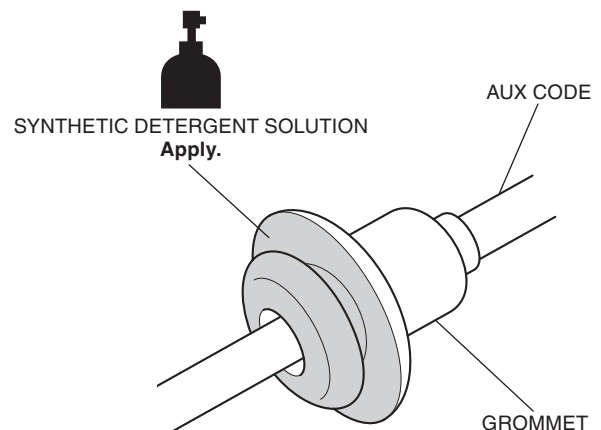

27. Route and install the AUX code as shown.

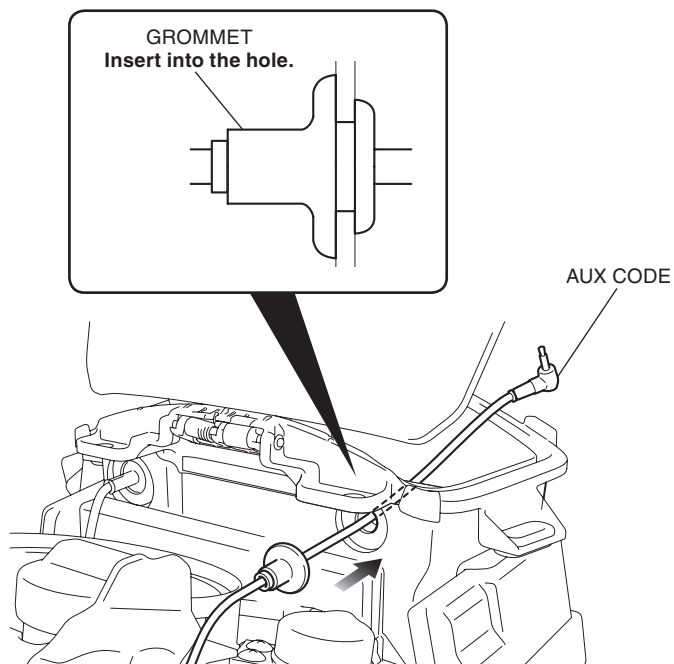

28. Remove the masking tape.

29. Route and connect the AUX code as shown.

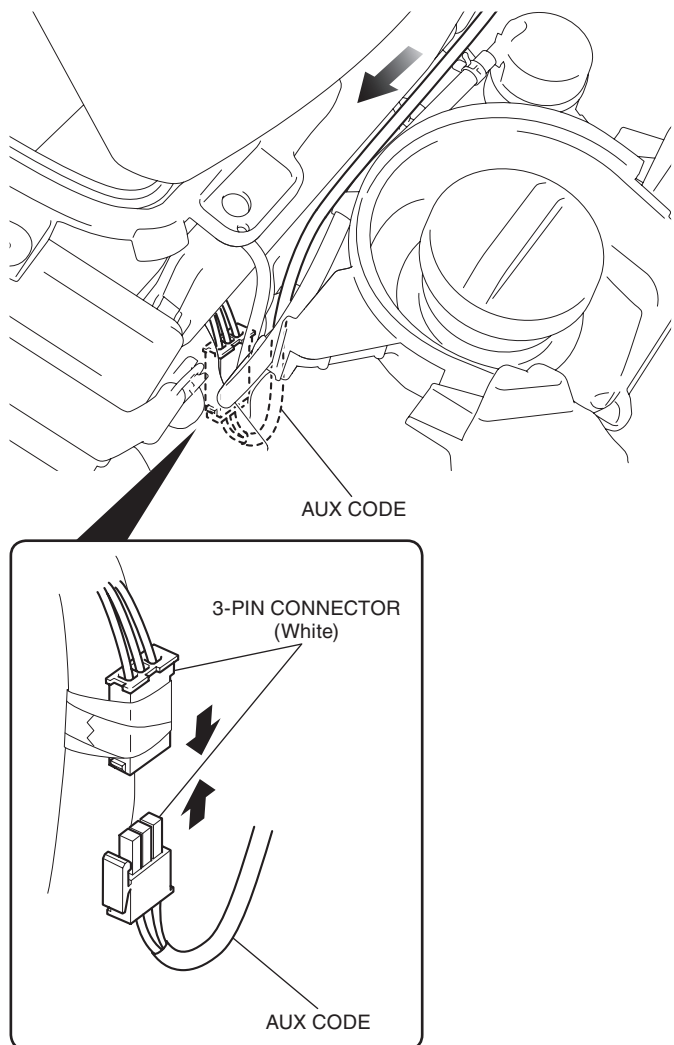

30. Install the motorcycle's parts in the reverse order of removal.

- **Confirm that any wire harness is not caught or too tight.**

31. Check the AUX, headlight and the other lights for proper operation.