



# INSTALLATION

## L.E.D. FRONT REFLECTOR CONVERSION 7455

### PARTS INCLUDED

- 1 L.E.D. Conversion Light — Left—Chrome with Amber Lens
- 1 L.E.D. Conversion Light — Right—Chrome with Amber Lens
- 1 Dielectric Grease
- 2 "Y" Connector Plugs
- 2 Male Connector Housings
- 4 4" Nylon Cable Ties
- 1 Installation Instructions

Please read and understand entire instructions before starting installation.

### THANK YOU FOR CHOOSING KÜRYAKYN!

**IN ORDER TO PROTECT YOU AND OTHERS FROM POSSIBLE INJURY AND/OR PROPERTY DAMAGE OR LOSS, PLEASE PAY CLOSE ATTENTION TO ALL INSTRUCTIONS, WARNINGS, CAUTIONS AND NOTICES REGARDING THE USE AND CARE OF THIS PRODUCT.**

#### WARNING

**THIS INDICATION ALERTS YOU TO THE FACT THAT IGNORING THE CONTENTS DESCRIBED HEREIN CAN RESULT IN POTENTIAL DEATH OR SERIOUS INJURY.**

#### NOTICE

**This indication alerts you to the fact that ignoring the contents described herein may negatively affect product performance and functionality.**

#### NOTICE

**IF INSTALLING THIS PRODUCT FOR ANOTHER PARTY, PLEASE MAKE SURE THEY RECEIVE THIS COPY OF THE INSTALLATION INSTRUCTIONS SO THEY ARE AWARE OF THE IMPORTANT INFORMATION CONTAINED IN THEM.**

### TOOLS SUGGESTED

Set of Metric Hex Wrenches, Set of Metric Combination Wrenches, Small Pliers

**STRICTLY OBSERVE THE FOLLOWING GUIDELINES IN ORDER TO USE THE PRODUCT PROPERLY AND AVOID POTENTIALLY DANGEROUS ACCIDENTS.**

#### STEP 1

Read and understand all steps in the instructions before starting the installation. Park the motorcycle on a hard, level surface and turn off the ignition.

**NOTE: Installation on '06 and later GL 1800 models require Kuryakyn P/N 7300, Adapter Plug, F6B Models require Kuryakyn P/N 7301, Adapter Plug, purchased separately.**

#### NOTICE

**A factory service manual may be helpful in performing this installation. Do not attempt to perform this installation if you are not confident in your ability to complete all of the steps in the procedure; consult a trained technician.**

#### NOTICE

**Avoid damage to the motorcycle. Protect painted and chrome surfaces with a soft cloth or blanket.**

### CUSTOMER SERVICE

877.370.3604 (toll free)

### INSTALLATION QUESTIONS

techsupport@kuryakyn.com  
or call 715.247.2983

### LIMITED WARRANTY

Kuryakyn warrants that any Kuryakyn products sold hereunder, shall be free of defects in materials and workmanship for a period of one (1) year from the date of purchase by the consumer excepting the following provisions:

- Kuryakyn shall have no obligation in the event the customer is unable to provide a receipt showing the date the customer purchased the product(s).
  - The product must be properly installed, maintained and operated under normal conditions.
  - Kuryakyn makes no warranty, expressed or implied, with respect to any gold plated products.
  - Kuryakyn shall not be liable for any consequential and incidental damages, including labor and paint, resulting from failure of a Kuryakyn product, failure to deliver, delay in delivery, delivery in nonconforming condition, or for any breach of contract or duty between Kuryakyn and a customer.
- Kuryakyn products are often intended for use in specific applications. Kuryakyn makes no warranty if a Kuryakyn product is used in applications other than intended.
- Kuryakyn electrical products are warranted for one (1) year from the date of purchase by the consumer. L.E.D.'S contained in components of Kuryakyn products will be warranted for defects in materials and workmanship for 3 years from the date of purchase where as all other components shall be warranted for one(1) year. This includes, but is not limited to; control modules, wiring, chrome & other components.

• Kuryakyn makes no warranty of any kind in regard to other manufacturer's products distributed by Kuryakyn. Kuryakyn will pass on all warranties made by the manufacturer and where possible, will expedite the claim on behalf of the customer, but ultimately, responsibility for disposition of the warranty claim lies with the manufacturer.

### ABOUT OUR CATALOG

For purchasing Kuryakyn® products, you can receive a complete catalog free of charge. Send the Proof-of-Purchase below with your address to: Kuryakyn, P.O. Box 339, Somerset, WI 54025. Please indicate either Accessories Catalog for Harley-Davidson® or GL & Metric Cruisers.

Be sure to ask your local dealer about other Kuryakyn® products, the motorcycle parts and accessories designed for riders by riders.

©2005 Kuryakyn USA® All Rights reserved.



kuryakyn.com

**STEP 2** Remove the front fender and the fork covers from the motorcycle. PIC 1 Set the hardware aside, it will be reused.

**STEP 3** Remove the stock reflectors from the fork covers.

**STEP 4** Install the LED conversion lights in place of the reflectors. The wires will pass through one of the holes in the fork cover used to mount the stock reflector. The stock nut and washer will be reused. We suggest the orientation shown in PIC 3. Route the wires up to the rubber brake hoses. Re-install the fork covers.

**STEP 5** "Peel back" the rubber boot at the base of each of the rear view mirrors. The turn signal light wiring and connector plug will be exposed. PIC 4

**STEP 6** Neatly route the wires so the terminated ends come out of the fairing at the rear view mirror bases. We suggest routing the wires along the brake hoses to the lower fork clamps and securing them with nylon cable ties. Be sure the remaining lengths of wire leading to the mirror bases are out of harms way. Remember to take into account the movement of the front end - both up and down (suspension) and left to right (steering).

**NOTICE** Be sure to leave sufficient slack in the wiring harness to allow for extension of the forks. If there is not enough wire to allow for movement, the wiring harness will be damaged!

**NOTICE** Secure all wiring away from any moving parts, pinch points or extreme heat. Küryakyn WILL NOT issue a warranty on any electrical component that fails due to pinched, crimped, broken, abraded, melted or frayed wires.

**STEP 7** Locate the connection plug between the mirror mounted turn signals and the fairing. Separate the plug, and install the supplied "Y" adapter plug in line. ('06-later GL 1800 models require Küryakyn P/N 7300, Adapter Plug, F6B Models require Küryakyn P/N 7301, Adapter Plug, purchase separately.) If you have other Küryakyn products, there will already be one "Y" connector in place. This connector can be added to the existing one.

**STEP 8** Insert the pins into male connector housing so the following color wires join as follows (remember the housing only plugs in one way!):

"Y" Connector Plug	L.E.D. Conversion Light
black (ground)	black (ground)
red (running light)	green (running light)
white (turn signal)	red (turn signal)

**STEP 9** Plug the rotor light into one of the small plugs on the "Y" connector (the remaining one will be used for other Küryakyn accessories). Replace the rubber boots around the base of the mirrors.

**STEP 10** Turn the key on and test that all lights work.

**WARNING** ENSURE PROPER LIGHT OPERATION BEFORE RIDING THE MOTORCYCLE. VISIBILITY IS A MAJOR CONCERN FOR MOTORCYCLISTS. A LIGHT MALFUNCTION COULD RESULT IN DEATH OR SERIOUS INJURY.

**NOTICE** It is the installer's responsibility to ensure that all of the fasteners (including pre-assembled) are tightened before operation of the motorcycle. Küryakyn will not provide warranty coverage on products or components lost due to improper installation or lack of maintenance. Periodic inspection and maintenance are required on all fasteners.

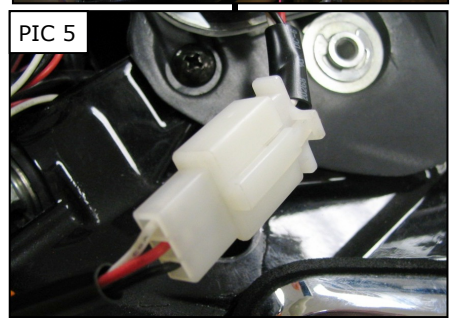
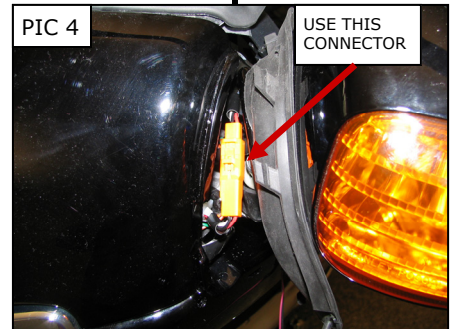

*Ride On!*

*Ride On!*

-cont.-

**PRODUCT NAME HERE**

**INSTALLATION**