

AKUSTIK



NOOLI

LIVING WITH GRACE

© Copyright ©2021 Borett Webbutik AB.
Original content rights reserved. All
product names, logos, and brands are
property of their respective owners.



Information contained within this
document was considered accurate
at the time of publication, but may
be subject to revision.

Installation

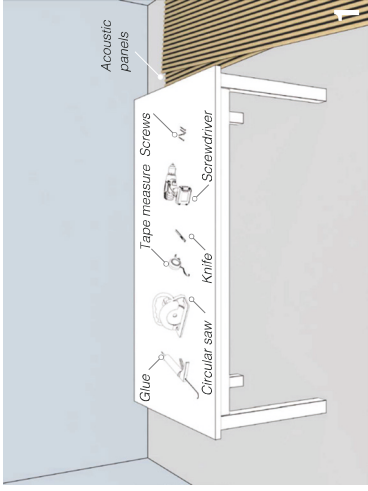

Step 1: Prepare all the tools and materials you need.

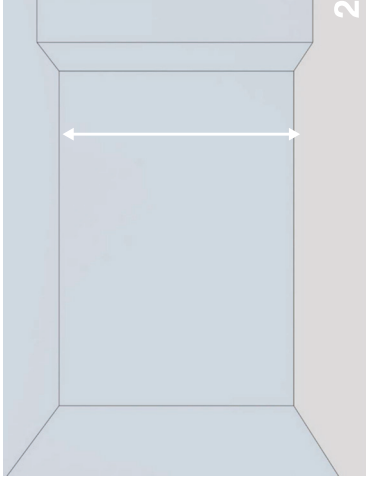

Step 2: Measure the height of the wall.

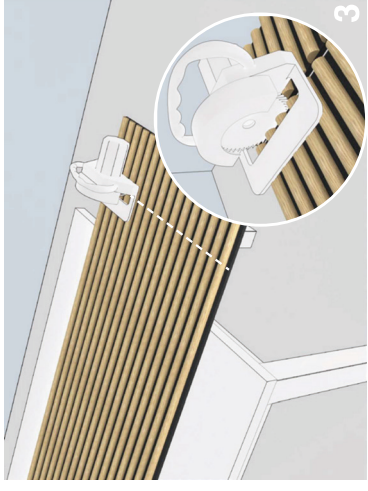

Step 3: Cut the acoustic panel according to the height of the wall.

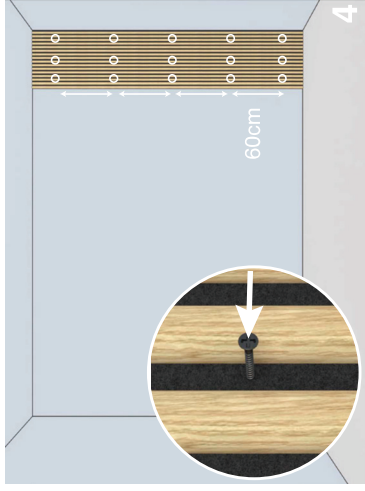

Step 4: Place the acoustic panel on the wall and nail it.

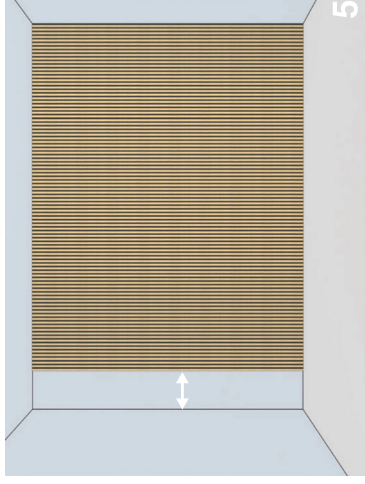

Step 5: Install in turn. Measure the remaining width.



Step 6: Cut the acoustic panel

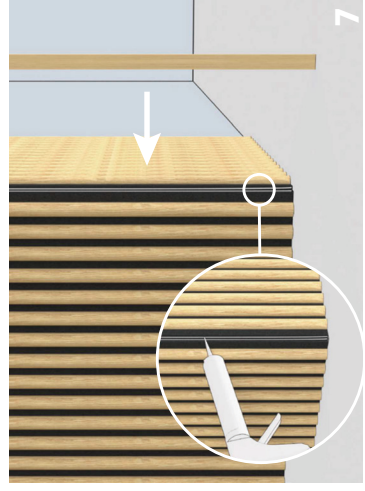

Step 7: When dealing with external corner, Use an edge strip too.

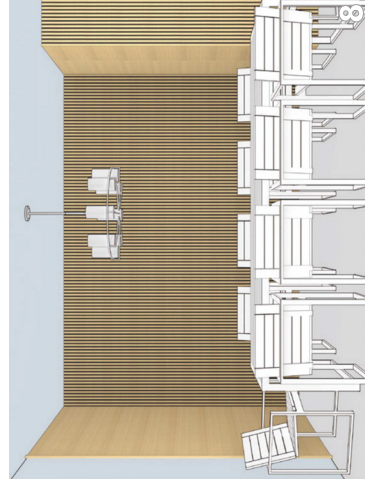

Step 8: Complete the installation.

NOOLLI

LIVING WITH GRACE

© Copyright ©2021 Borett Webbutik AB.
Original content rights reserved. All
product names, logos, and brands are
property of their respective owners.



Information contained within this
document was considered accurate at
the time of publication, but may be
subject to revision.