

## MIRROR INSTALLATION

Check that there is no electrical cables / water hoses or any other objects in the drilling locations before you drill into walls

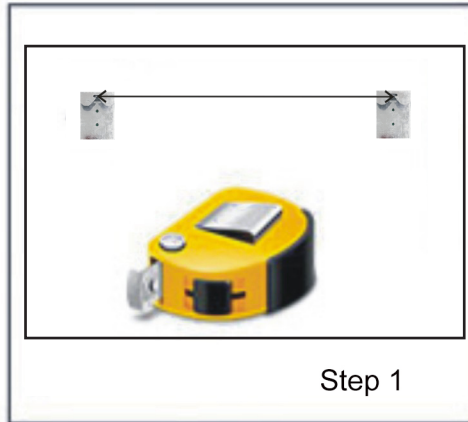

Measure the distance between the two cut outs / hook in the back of the mirror

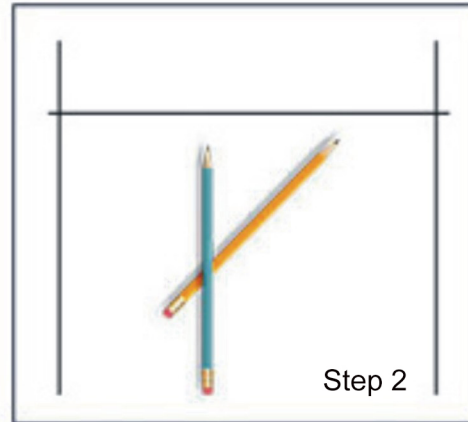

Draw a straight line, mark out the position of the cut out / hooks



Drill holes where required

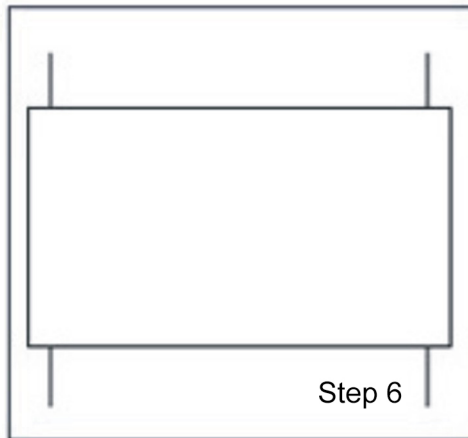

Hang up the mirror, Finish

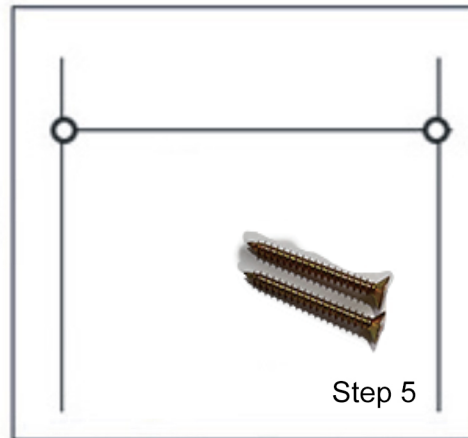

Fix screws into wall



Screw and plugs provided for screwing