

## HANDBROMS MB

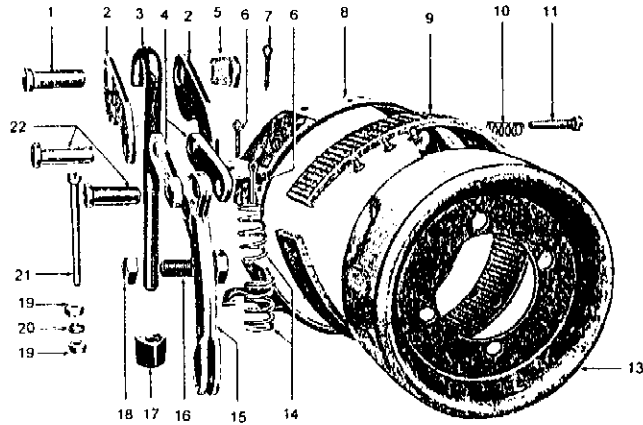

- |     |       |                    |     |        |        |
|-----|-------|--------------------|-----|--------|--------|
| 2.  | A1003 | KAM                | 13. | A1002  | TRUMMA |
| 3.  | A1016 | BULT               | 14. | A1017  | FJÄDER |
| 4.  | A1228 | LÄNK               | 15. | A1226  | ARM    |
| 5.  | A1005 | LÄNK               | 16. | A1227  | BULT   |
| 6.  | A1642 | SAXPINNE           | 17. | A1018  | MUTTER |
| 7.  | A5020 | SAXPINNE           | 18. | 52925  | MUTTER |
| 8.  | A1009 | BROMSBAND KOMPLETT | 19. | 52217  | MUTTER |
| 9.  | A1014 | BELÄGG             | 20. | 52706  | BRICKA |
| 10. | A1021 | FJÄDER             | 21. | A1019  | SKRUV  |
| 11. | A1020 | BULT               | 22. | 311003 | SPRINT |

## HANDBROMS CJ

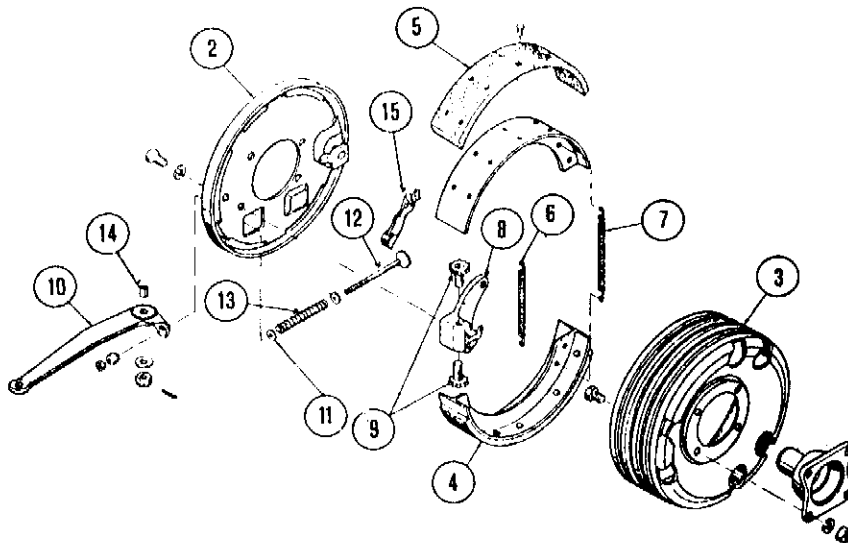

- |    |        |             |     |        |                    |
|----|--------|-------------|-----|--------|--------------------|
| 2. | 643454 | SKÖLD       | 9.  | A10331 | JUSTERSKRUV V-GÄNG |
| 3. | A9332  | TRUMMA      |     | A10332 | JUSTERSKRUV H-GÄNG |
| 4. | 643055 | BACKSATS    | 10. | A17254 | ARM CJ2-6          |
| 5. | 116712 | BANDSATS    | 11. | A10335 | MUTTER             |
| 6. | A10337 | RETURFJÄDER | 12. | A10334 | LÄNK               |
| 7. | A10338 | RETURFJÄDER | 13. | A10336 | FJÄDER             |
| 8. | A10330 | FÄSTE       | 14. | A17253 | BUSSNING           |
|    |        |             | 15. | A10333 | ARM                |