

TLH Simplified... Without Compromise

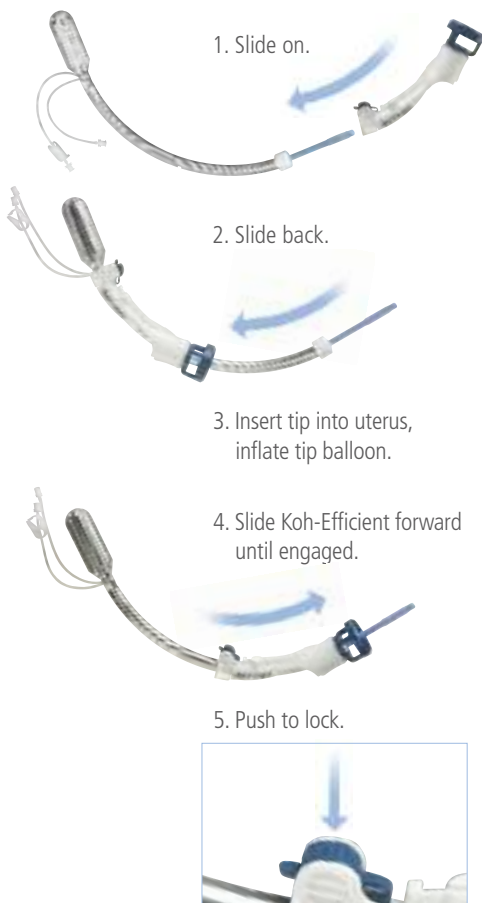
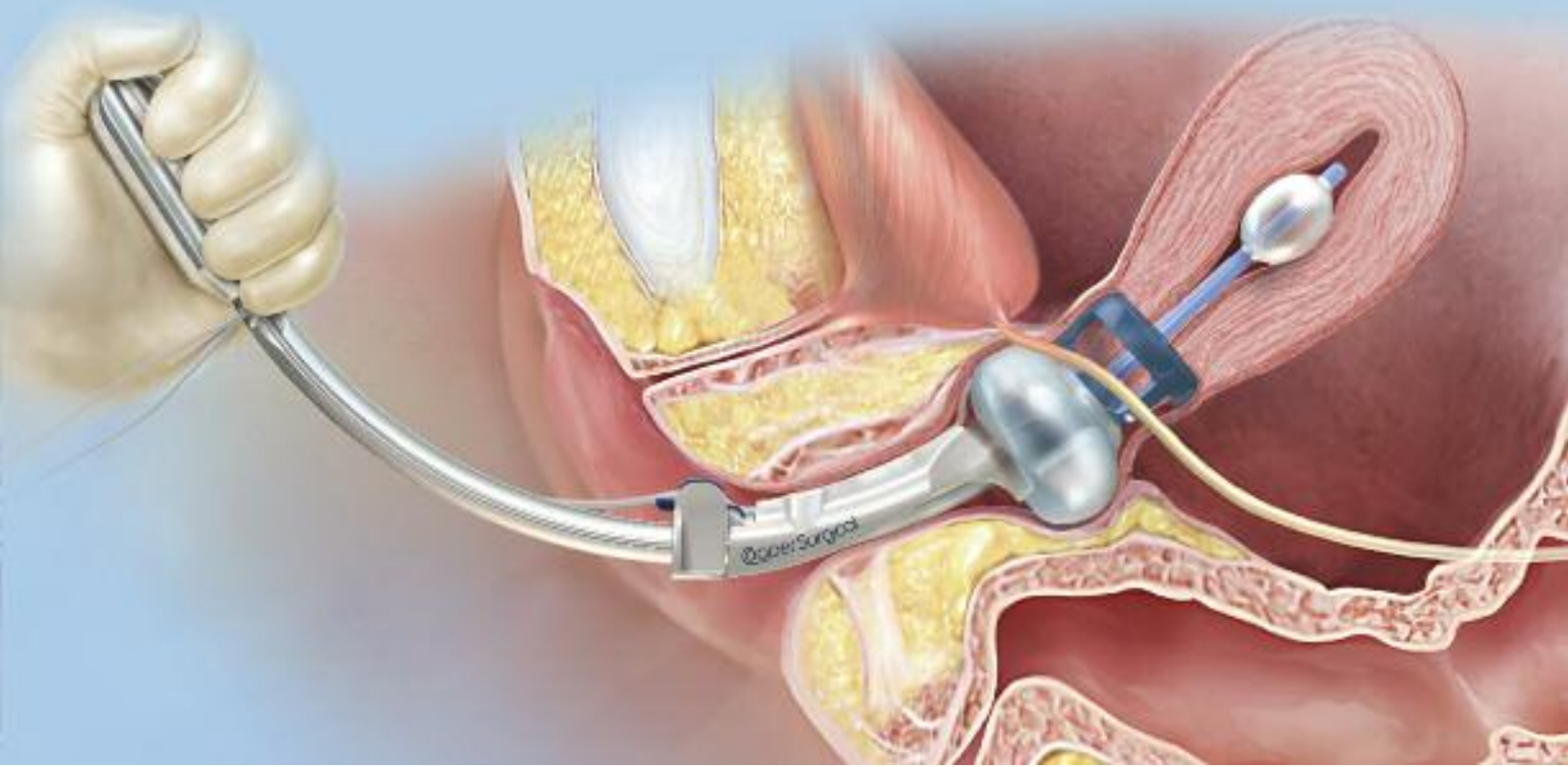

The Advincula Arch™

"The Advincula Arch is an innovative uterine manipulator. When combined with the Arch Koh-Efficient™ it provides ease of use and functionality during all the critical stages of a TLH."

- Arnold Advincula, MD
FACOG, FACS

Designed for Ease of Use and Functionality

Simple

- Faster setup – Integrated Koh Cup™ and pre-attached occluder balloon facilitates assembly
- Simple, lightweight design
- Ease of insertion with our easy load Koh-Efficient™ System

Uncompromised Functionality

- Durability – Provides unprecedented simplicity in a reusable design compared to disposable manipulators that "buckle under pressure"
- Superior visualization and control – the right colpotomy cup for every TLH
- Outstanding anteversion and retroversion in a durable configuration

During TLH procedures, the Koh-Efficient creates a "margin of safety" by providing a visual landmark and backstop for full circumferential colpotomy, as well as distancing the ureters during the incision. Vaginal length is maximized and pneumoperitoneum is maintained.

CooperSurgical

Advincula Arch™ Designed for Strength and Durability

Provides:

- Ease of use
- Functionality for a faster, safer TLH

An alternative to the articulating RUMI® II, the reusable Advincula Arch™ is ideal for physicians who prefer the simple and lightweight design of a disposable uterine manipulator but would like additional strength.

Some physicians choose the Advincula Arch™ as they prefer executing anteversion/retroversion of the uterus manually or with the Uterine Positioning System™. The radial design permits easy insertion from any angle and its unique curve provides outstanding elevation for superior visualization and control.

The Advincula Arch™ has a specifically designed Koh-Efficient™ system enabling the physician to safely insert and correctly position the device for use.

The Koh-Efficient™ Creates a “Margin of Safety” by Providing a Visual Landmark and Backstop for Full Circumferential Colpotomy

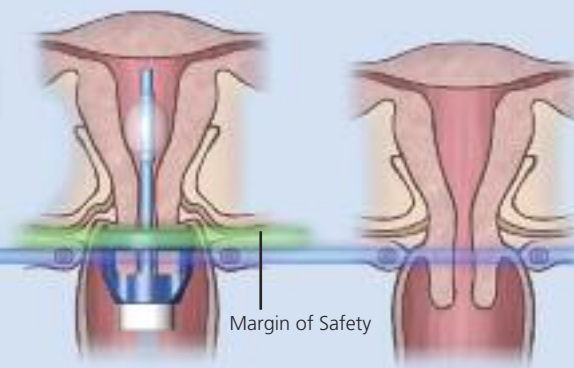

Ordering Information

Code	Product	Description
Uterine Manipulator Handles		
UMH750	Advincula Arch Handle	(1 each)
RUMI Uterine Tips		
UMY514	RUMI Tip Yellow	5.1 mm x 3.75 cm (5 per box)
UML516	RUMI Tip Lavender	5.1 mm x 6 cm (5 per box)
UMW676	RUMI Tip White	6.7 mm x 6 cm (5 per box)
UMB678	RUMI Tip Blue	6.7 mm x 8 cm (5 per box)
UMG670	RUMI Tip Green	6.7 mm x 10 cm (5 per box)
UMO672	RUMI Tip Orange	6.7 mm x 12 cm (5 per box)
SACRO-1	Sacrocolpopexy Tip - Large	(3 per box)
SACRO-1S	Sacrocolpopexy Tip - Small	(3 per box)
SACRO-1C	Sacrocolpopexy Tip - Concave Distal End	(3 per box)
Cervical Sizer		
KC-SIZER	Cervical Sizer	(1 each)
Arch Koh-Efficient System for electrosurgical devices		
KC-ARCH-25	Plastic Arch Koh-Efficient	2.5 cm (5 per box)
KC-ARCH-30	Plastic Arch Koh-Efficient	3.0 cm (5 per box)
KC-ARCH-35	Plastic Arch Koh-Efficient	3.5 cm (5 per box)
KC-ARCH-40	Plastic Arch Koh-Efficient	4.0 cm (5 per box)
Arch Koh-Efficient System for harmonic scalpel or laser use		
KCS-ARCH-25	Steel Arch Koh-Efficient	2.5 cm (5 per box)
KCS-ARCH-30	Steel Arch Koh-Efficient	3.0 cm (5 per box)
KCS-ARCH-35	Steel Arch Koh-Efficient	3.5 cm (5 per box)
KCS-ARCH-40	Steel Arch Koh-Efficient	4.0 cm (5 per box)
Uterine Positioning System™ (UPS)		
371550-03	Uterine Positioning System	
53468	Adapter, Advincula Arch , UPS	
400245-01	Drape, UPS, 20/Case	
371560-01	Uterine Positioning System - Cart	

All RUMI products are latex free

CooperSurgical

CooperSurgical is the leading company dedicated to providing medical devices and procedure solutions that improve health care delivery to women regardless of clinical setting. Our company is fostering that position through expansion of its core businesses and introduction of advanced technology-based products, which aid clinicians in the management and treatment of commonly seen conditions.

To schedule a demonstration or trial of the Advincula Arch, call 800.243.2974 or 203.601.5200. Visit coopersurgical.com or see us at youtube.com/coopersurgical

203.601.5200 | coopersurgical.com | 95 Corporate Drive | Trumbull, CT 06611