

TECHNICAL DATA SHEET

SECUMAX 150 NO. 150001

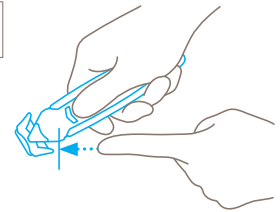

Safety technology



Concealed blade – a maximum degree of safety

The SECUMAX 150 blade is not an open one, but is hidden from people and goods. This provides you with a maximum degree of safety from cut injuries and from damage to goods.



DISPOSABLE SAFETY KNIFE WITH CONCEALED BLADE. FOR CUTTING, SCRAPING AND SCORING.

Order No. 150001.12

Flexible and sustainable at work.

MARTOR's SECUMAX 150 provides you with one tool for three tasks: cutting, scraping and splitting. The two cutting edges are concealed to provide optimum protection for users and packaged goods. The blade head of this 26 g safety knife is firmly attached to the ergonomic handle and cannot be changed. The fibreglass reinforced SECUMAX 150 comprises at least 80% recycled plastic.

3-in-1 blade head

The SECUMAX 150 fits like a glove. It's so comfortable to hold, that it feels like an extension of your hand. With it you can cut cardboard, split tape, open plastic strapping... you can even scrape residue off surfaces.

Concealed blade

This safety knife doesn't need a sharp tip to be a smart knife. The cutting head is flat and relatively small, the two noses on each side have the perfect length to protect, and both

cutting edges are wide enough to safely and effortlessly cut 2-ply cardboard.

Clever guide surfaces

Another reason why the SECUMAX 150 can cut through cardboard so easily? The guide surfaces located right at the front of the safety knife help you to cut at an angle. Angled cutting means less material resistance!

Ergonomically shaped

Right handed? Left handed? It's really all the same. The SECUMAX 150 fits perfectly in any hand. Gently arched outer edges, coupled with light ribbing and a low weight, ensure an ergonomic experience.

Disposable and also sustainable





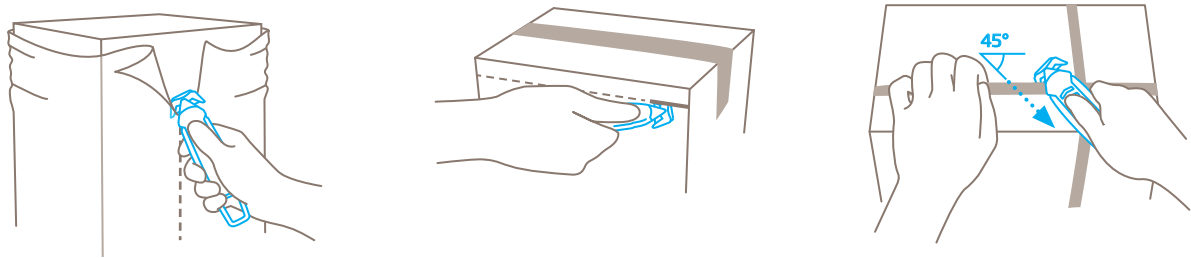

The SECUMAX 150 is a disposable knife. The blade head is non-replaceable. It was therefore especially important to us to make the product as sustainable as possible. The result: 80% recycled plastic with fibreglass reinforcement.

USAGE



PRODUCT FEATURES

Technical features

 Maximum safety	 Disposable knife	 Abrasion resistant	 Very ergonomic
 2-cutting edge blade	 Cutting depth	 Scraper width	 Tape splitter
 For right and left handers	 Lanyard hole	 Printable for promotional purposes	

Main cutting materials

 Cardboard: up to 2-ply	 Wrapping, stretch and shrink foil	 Tape	 Plastic strapping band
 Bagged goods	 Layers of foil or paper	 Yarn, cord	 Felt
 Self-adhesive label			

Installed blade

Blade thickness 0.30 mm.

BLADE CHANGE

The blade is moulded into the body of the knife and cannot be changed.
Blade thickness 0.30 mm.

SERVICES OFFERED



Safety poster



Training video



Technical data sheet



Consulting service

PRODUCT AND PACKAGING DETAILS

Order No.	NO. 150001.12	Packaging unit	10 in box (loose)
Knife size (L x W x H)	148 x 11 x 37.2 mm	Size outer pack	154 x 113 x 40 mm
Weight knife	26.0 g	Weight outer pack	284.0 g
Basic material	Recycled plastic, glass fibre reinforced	EAN Code outer pack	4002632972133
Cutting depth	6.2 mm	Customs tariff number	82119200

SAFETY CERTIFICATE

Date of issue	13.07.2023
Certification	GS certificate NO. 186525-7810-55094-2023

Certificates and awards



SAFETY INSTRUCTIONS

To ensure that you use your new MARTOR knife safely and most effectively, please read and note the following user-instructions. Please keep the written guide in a safe place so that you can access it at any time.

1. General application instructions: Please always use the product carefully for manual cutting work only and not for any purposes other than those that are intended. Please take the correct handling and the proper use of the knives into account in this regard. As an additional safety measure, we recommend the wearing of safe gloves.

2. Special application Instructions to avoid the danger of injuries: Only use cutting tools that are in perfect condition and have sharp, clean and undamaged MARTOR blades. Employ the utmost care when handling the knives. Prior to use, familiarise yourself with the safety features and their functioning. Ensure that these safety features are not impaired by the type of material to be cut. CAUTION: The blade is sharp and can result in serious and deep cuts. Therefore, never reach into the blade! Do not place your free hand in the line of cutting and never cut directly towards you.

3. Replacement of spare parts: This knife is a disposable product. It is not designed to have its blades changed or any other of its components replaced. If the knife shows signs of aging or any other wear, e.g. which impair the safety features or usage, the knife must be taken out of service and replaced. Do not modify this product in any way. Modifications of any kind may impair product safety. CAUTION: The risk of injury caused by manipulation of this product is extremely high.

4. Non-use of the knife: Always secure the blade in such a way (depending on product type) that injuries due to cuts are excluded. Store the knife in a secure place.

5. Care instructions: To guarantee a long service life, always keep the knife clean and do not expose it to unnecessary soiling and humidity.

CAUTION: No liability will be assumed for consequential losses. Subject to technical changes and errors! This knife does not belong in the hands of children!

ACCESSORIES

BELT HOLSTER S

NO. 9920



What do you do with your cutting tools when you are not actually using them? The MARTOR BELT HOLSTER S is a robust holder that allows you to carry all compact MARTOR knives as well as our safety scissors at all times. In addition, the compartments are designed to allow you to load different tools: for example you can also carry a pen or a pack of blades. The MARTOR BELT HOLSTER is the ideal place to stow your tools safely when moving from A to B - and have them at hand, as soon as they are required.

BELT HOLSTER XXL

NO. 9924



The BELT HOLSTER XXL is a real space miracle. With it, you not only transport your MARTOR cutting tools safely from A to B. All other work utensils are always within reach. The BELT HOLSTER XXL has two large compartments: the inner one is lockable, the outer one is equipped with a knife safety device. You are also well equipped when it comes to carrying options. Choose flexibly between strap, Velcro fastener and clip.

TOOL RETRACTOR

NO. 9960



The TOOL RETRACTOR protects your cutting tool from loss and from falling down. Its core is the heavy-duty Kevlar cord that can be extended up to 90 cm. As soon as you let go of your knife, it is returned to you via the flexible cord. Your hands are free for other activities – the knife always remains at hand. The carabiner is designed for your belt loop, the steel cord at the other end fits through the eyelet of your cutting tool.

CONNECTOR

NO. 9946



Materials that require cutting can sometimes be too high or too far away. The CONNECTOR from MARTOR helps you to overcome distances when cutting. The CONNECTOR is simple to attach to our SECUMAX 350, 350 SE, 150 and 148 safety knives and makes a stable connection. At the other end, the CONNECTOR can be connected, for example, to the MARTOR TELESCOPIC POLE. You then gain much more reach.

CONNECTOR SET

NO. 9947



Materials that require cutting can sometimes be too high or too far away. The CONNECTOR SET from MARTOR helps you to overcome distances when cutting. It includes the CONNECTOR which can be simply connected to our SECUMAX 350, 350 SE, 150 and 148 safety knives, and the matching MARTOR TELESCOPIC POLE. This set gives you extra reach of up to 95 cm.

MANUFACTURER

MARTOR KG | Lindgesfeld 28 | 42653 Solingen | Germany
T +49 212 73870-0 | info@martor.de | www.martor.com