

WHEEL FITMENT TEMPLATES

BMW				3 SERIES E 36 M3				92~99			
PARTS NO.		ROTOR DIAMETER		FRONT/REAR		PCD					
BM05		356mm X 32mm		FRONT		5X120					

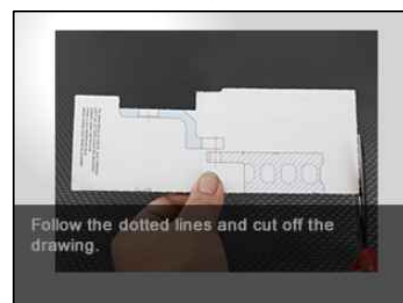
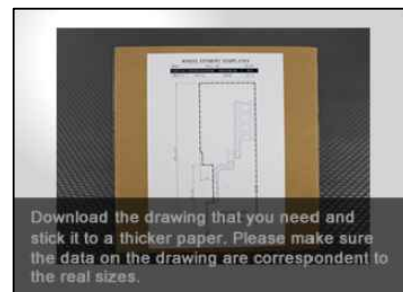
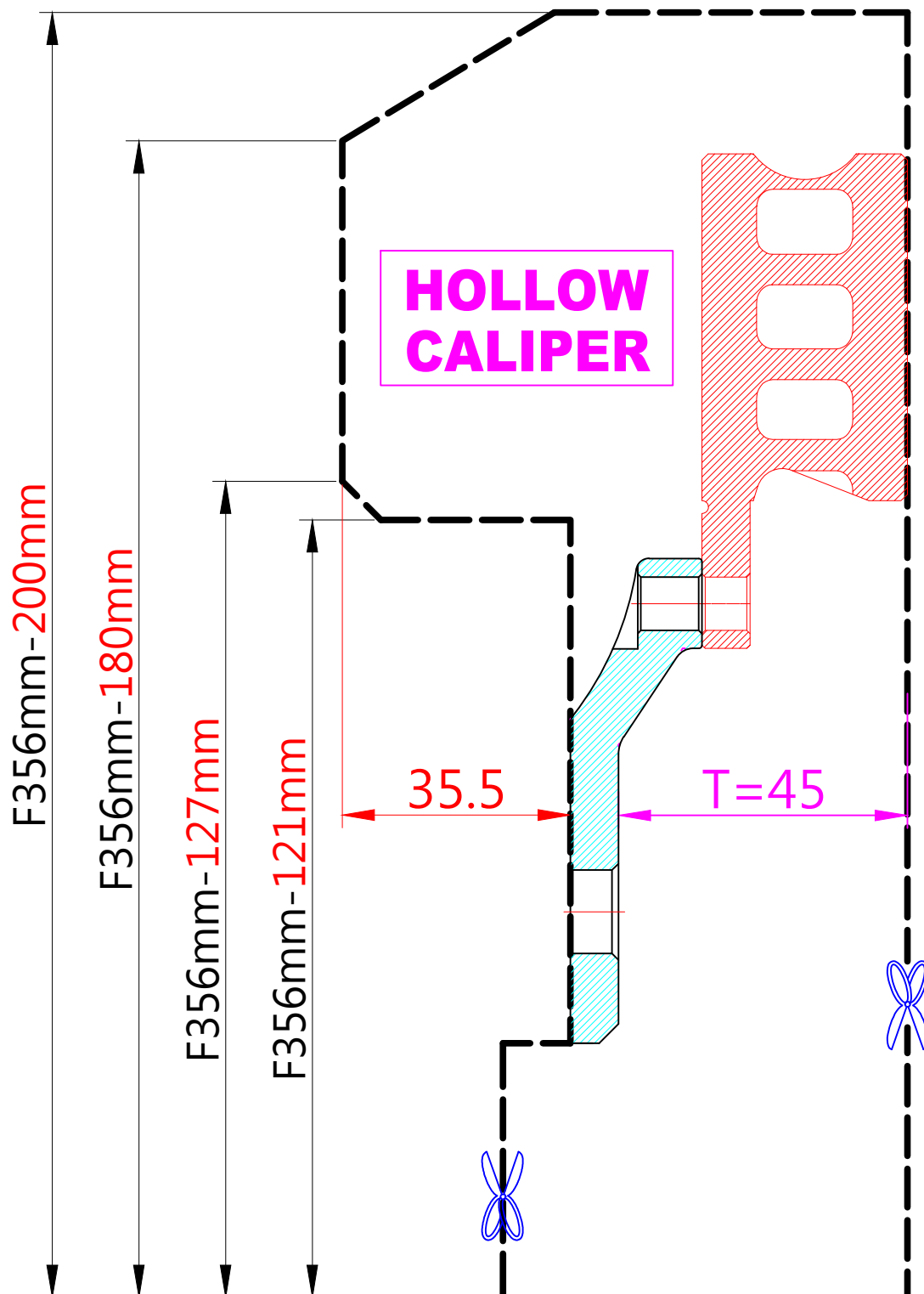

The wheel fitment is only for your reference and it can not 100% ensure the clearance between caliper and rim is ok. if there is any interference issue, please change your wheel as possible.