

WHEEL FITMENT TEMPLATES

BMW	E 46 M3 (EURO SPEC)	01~06	
PARTS NO.	ROTOR DIAMETER	FRONT/REAR	PCD
BM12-1	380mm X 32mm	FRONT	5X120

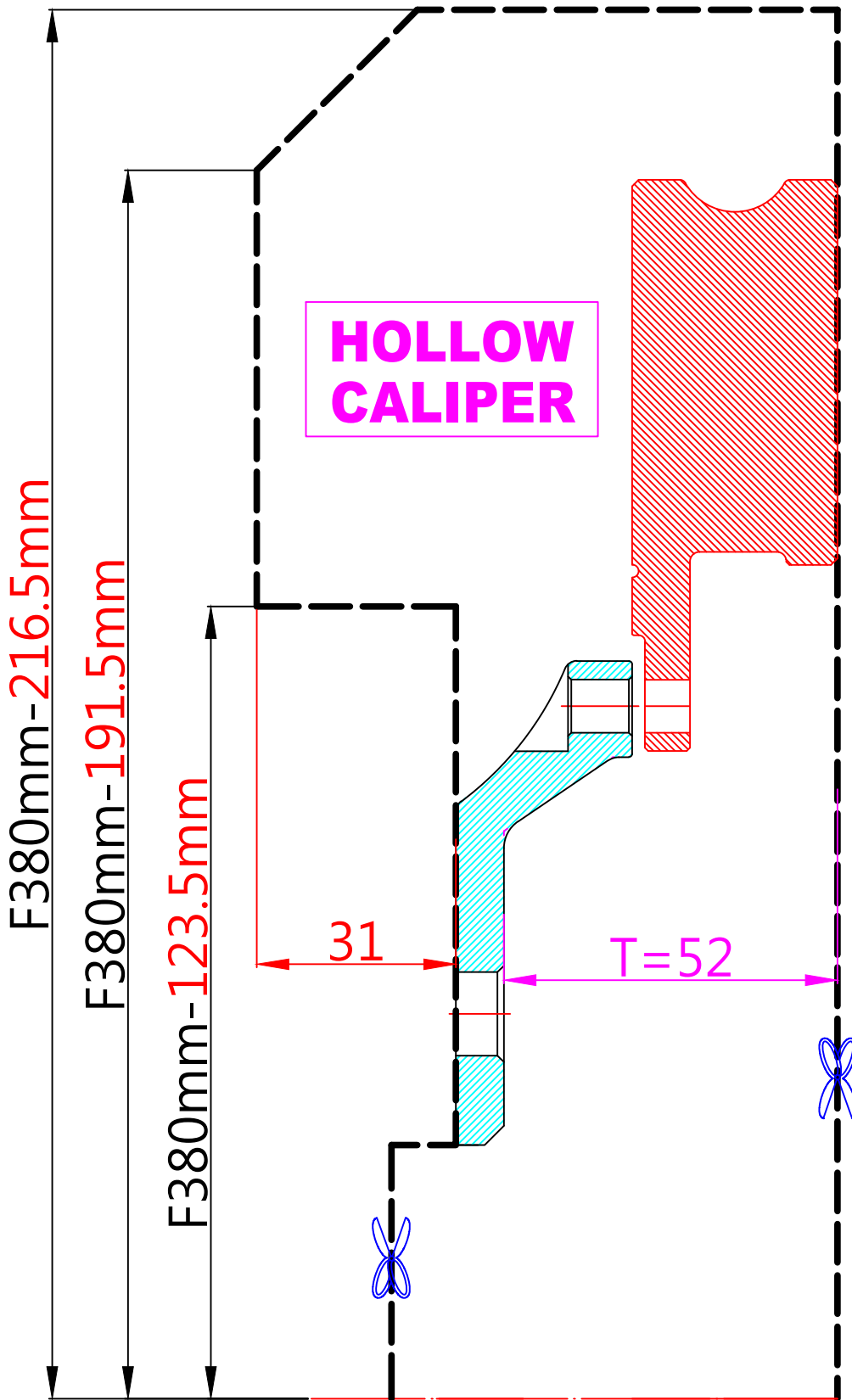

HOLLOW CALIPER

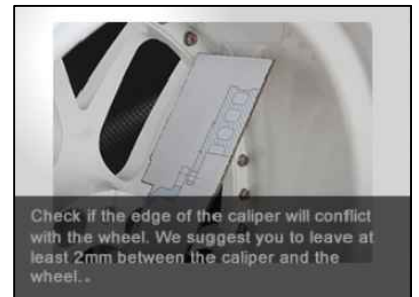
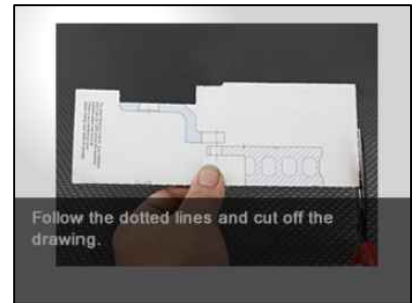
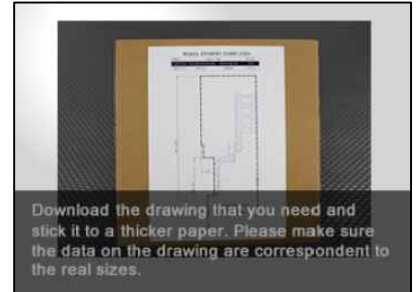

The wheel fitment is only for your reference and it can not 100% ensure the clearance between caliper and rim is ok. if there is any interference issue, please change your wheel as possible.