

# NO:0268 Shock Absorbers Installation Instruction

BODY

**Rear**

L TYPE RUBBER

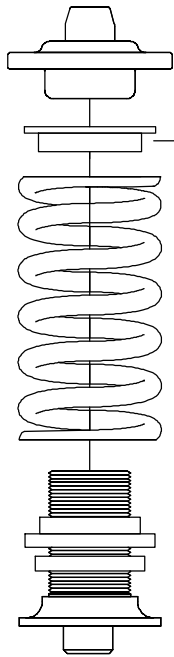

lower control arm



**BEFORE**



**AFTER**

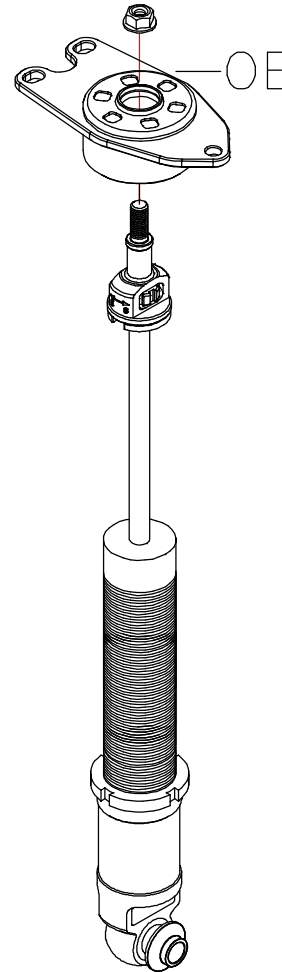

## Ride Height Adjustment of Non-Full Coilover Instructions

The spring and the strut are separated on the rears of some certain vehicles. Please make sure an adjustment in ride height and length of strut by carrying out the following steps:

- 1) A is to lower or raise the ride height.
- 2) After required ride height is reached, it is essential to adjust the length of coilover by adjusting B to your desired position.
- 3) After required ride height is reached, put the tire on and move the vehicle around 5-10 m. Please adjust B to let C insert 1/3 parts into the strut; tighten the spring perch lock of B. Please note the length of C is mentioned the situation of the car put on the ground.
- 4) The unusual noise and a breakdown will occur if failure in adjustment of the length of coilover is made.
- 5) 30mm of the mount need to leave threaded on the shock body to be safe.

