

WHEEL FITMENT TEMPLATES

HONDA		CIVIC EP3 (JAPAN)		00~05
PARTS NO.	ROTOR DIAMETER	FRONT/REAR	PCD	
HO03	304mm X 28mm	FRONT	5X114.3	

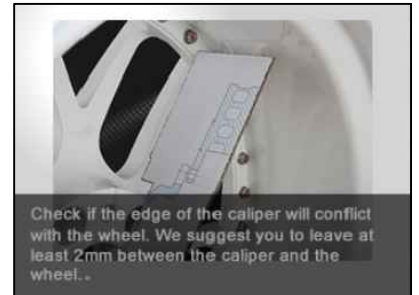
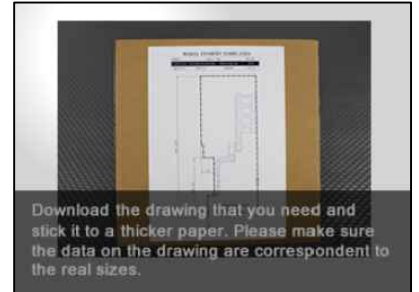
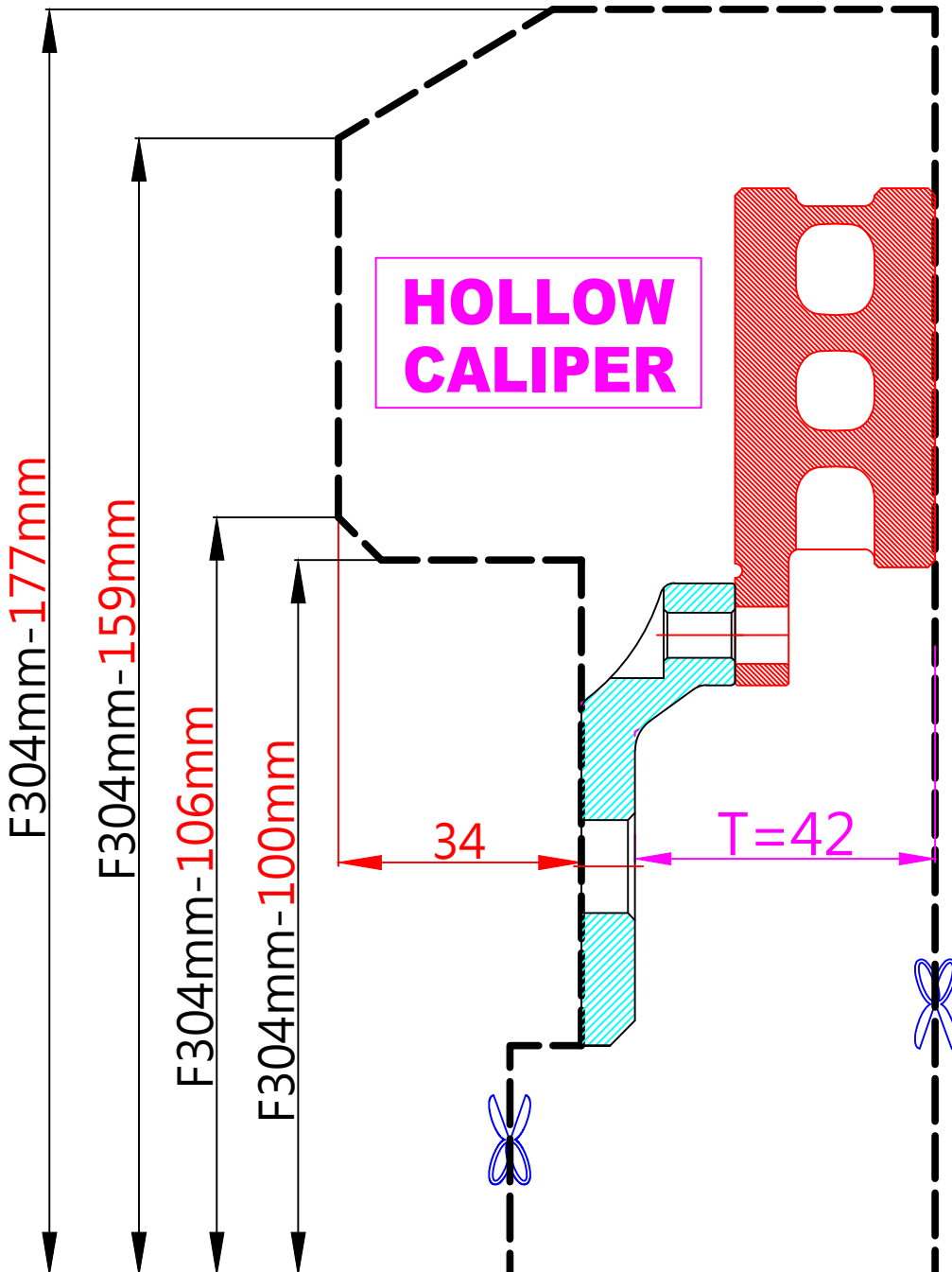

The wheel fitment is only for your reference and it can not 100% ensure the clearance between caliper and rim is ok. if there is any interference issue, please change your wheel as possible.