

Aputure[®]



Wireless Video Transceiver Set

Product Manual

English

Foreword

Thank you for purchasing the Aputure Array Trans

Aputure Array Trans is a high-definition video wireless transmission equipment, using the latest 60GHZ wireless transmission technology, special- through HDMI digital interface that can transmit audio and video signals clearly and synchronously, with uncompressed and zero latency transmission features.

Instructions

- **Please read this product manual carefully.**
- Keep this product manual. Always include this product manual when passing the products on to third parties.
- Heed all warnings and follow all instructions in this product manual.



WARNING: Do not touch the product's electrical contacts with your fingers. This is to prevent the contacts from corroding. Corroded contacts can cause the product to malfunction.

- Use only a microfiber and dry cloth for cleaning the product.
- Operate carefully to not cause any damage by dropping or physical shocking it.
- Do not leave the product near anything that has a strong magnetic field such as a magnet or electric motor. Also avoid using or leaving the product near anything emitting strong radio waves such as a large antenna. Strong magnetic fields can cause the product malfunction or destroy data transferring.
- Do not leave the product in excessive heat such as in a car with direct sunlight. High temperatures can cause the product to malfunction.
- To reduce the risk of fire or electric shock, do not use the product near water and do not expose it to rain or moisture.
- Keep the product stored in a cool and dry place.
- It is not allowed to disassemble the product yourself. Please have the product checked by the authorized service or agent if your product has some problems. Please note that this warranty does not apply to repair arising out of the malfunction of unauthorized disassembly, although you may request such repairs on a chargeable basis.
- Use of original Aputure cable accessories is recommended. Please note that this warranty does not apply to repair arising out of the malfunction of non-original Aputure accessories, although you may request such repairs on a chargeable basis.
- The product is certificated by RoHS, CE, FCC and HDMI. Please operate the product in compliance with the operation standards. Please note that this warranty does not apply to repair arising out of the malfunction, although you may request such repairs on a chargeable basis.
- The instructions and information in this manual are based on thorough, controlled company testing procedures. Further notice will not be given if the design and specifications change.

Intended use

Intended use of the Aputure Array Trans includes:

- The user has read the instructions of this Product manual.
- The user is using the products within the operating conditions and limitations described in this product manual.
- "Improper use" means using the products other than as described in these instructions or under operating conditions which differ from those described herein.

Detailed product manual for Array Trans can be found on the movie solution page on www.aputure.com.

Item check list

Before starting, please check that all the following items have been included with Aputure Array Trans. If anything is missing, contact your dealer immediately.

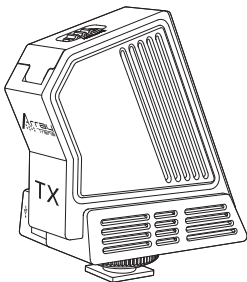

Transmitter

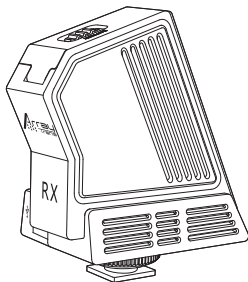

Receiver

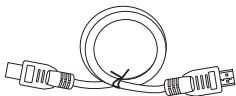

HDMI cable (A type to A type)



HDMI cable (A type to D type)

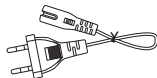

Plug

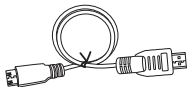

HDMI cable (A type to C type)

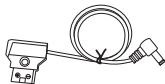

Power adapter cable (x2)

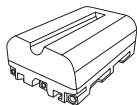

Battery (x2)

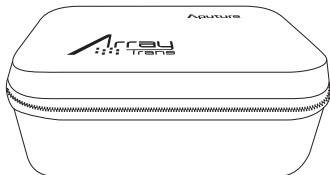

Handy case



Product manual



Warranty card

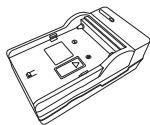

Charger

Components

Only to illustrate the component names with the transmitter because of the transmitter and the receiver have the same Component names.

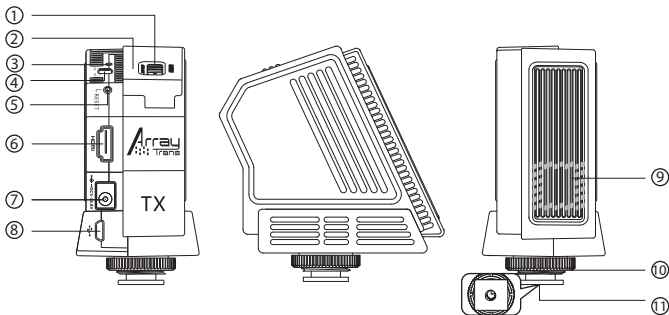

① Battery cover push button

② Battery compartment

③ Indicator light

④ Pairing switch

⑤ Reset button

⑥ HDMI interface

⑦ DC power interface

⑧ Mini USB firmware upgrade interface

⑨ Array antenna

⑩ Locking wheel

⑪ Cold shoe (1/4" slot)

Operations

1. Power supply

1) Using the power adapter cable connected to the Anton battery (14.8V / 160Wh, sold separately) power supply.

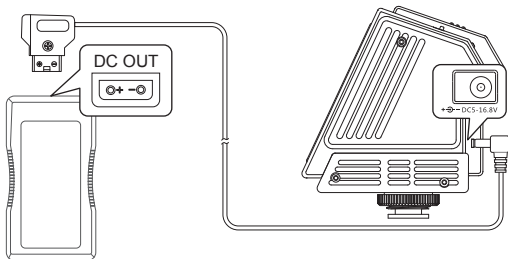

2) Using Li-ion batteries SONY NP-FM500H Model power supply

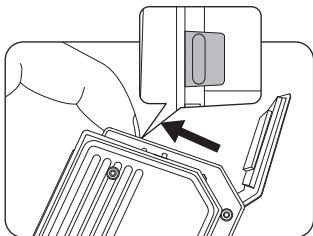
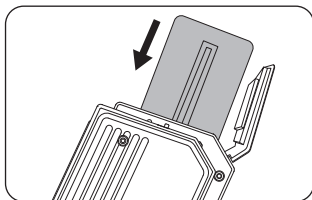

- * 1> When installing the battery, please push away the battery buckle and insert the battery by following the arrow direction above picture (left).
- 2> When the battery voltage is low, the indicator will show a red light warning. Then you should charge the battery by using the supplied charger and plug.
- 3> When removing the battery, please push the battery buckle by following the arrow direction above picture (right), then the battery pops out.

2. The fixation of transmitter and receiver

In use, with the help of locking wheel, cold shoe and 1/4" slot, the transmitter and receiver can be fixed to the camera, camcorder, tripod and so on.

3. Connecting the video equipment and receiver

Video equipment can be a HDTV, a monitor, a projector etc. Note that according to the HDMI interface of different video device, use the different interface HDMI cable to connect the video equipment and receiver.

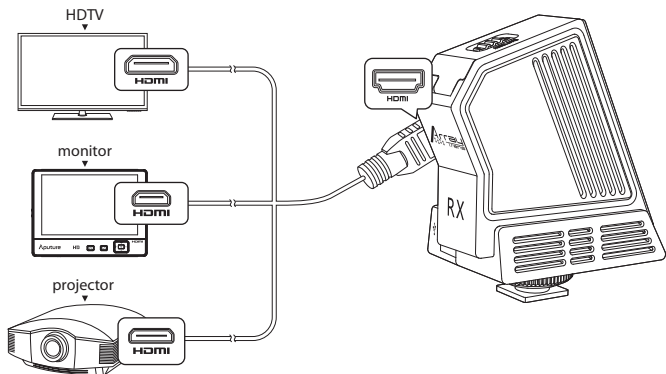

4. Connecting the transmitting terminal device and transmitter

Transmitting terminal device can be a shooting or playback device, such as a camera, a camcorder, a computer etc. Note that according to the HDMI interface of different device, use the different interface HDMI cable to connect the device and transmitter.

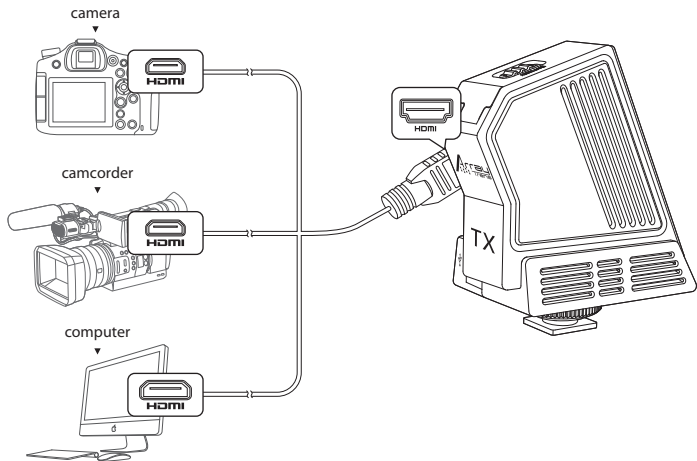

5. Wireless pairing

- 1) After the receiver and the transmitter are connected to the external device respectively, push their pairing switches to "ON" at the same time, then the blue indicator lights flash slowly and begin to pair automatically;
- 2) The indicator lights blink faster, showing that the receiver and the transmitter have paired successfully;
- 3) During normal operation (need to start the external devices) , the indicator lights stop flashing;
- 4) Push the pairing switches to "OFF", then stop working.

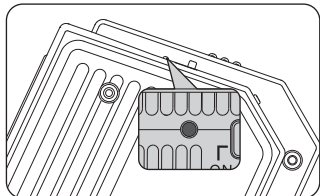
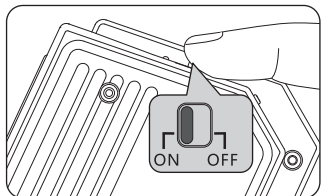

6. Reset pairing

Press the reset button for about 10s, you can clear the pairing addresses stored, and pair again by repeating the above fifth operations.

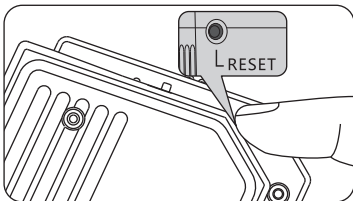

Tips and trouble setting

1. Please charge the battery within 5 minutes after the low battery warning appeared in case of unstable work.
2. In order to obtain the best use effect, we recommend that the antenna corresponding angle of the transmitter and the receiver is less than 15° .

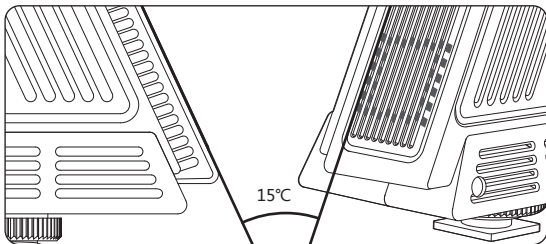

3. When the distance between the transmitter and the receiver is about 38M, the signal will be automatically disconnected because of the blind transmission, then you can make it connected automatically by increasing or decreasing the distance.
4. This product supports mini USB firmware upgrading, you can update firmware according to the direction on our official updating website: <http://www.aputure.com/array-trans/update>

Specifications

Working Voltage	DC5-16.8V	
Working Current	RX:0.35A~0.45A (DC-5V),TX:0.35A~0.45A(DC-5V);	
Battery Type	SONY Li-ion Battery NP-FM500H	
Battery Voltage	7.4V	
Battery Capacity	1500mAh	
Battery Duration	>4H	
Signal Compatibility	Compatible with 1080p@23.98/24/50/59.94/60Hz, 1080i@50/59.94/60Hz, 720p@50/59.94/60Hz, 576p@50Hz, 576i@50Hz, 480p@59.94/60Hz, 480i@59.94Hz.	
Temperature	Operation	-10°C~50°C
	Storage	-20°C~60°C
Humidity	<85%	
Transmission Frequency	60GHz	
Interface	HDMI Interface (A type), Mini USB firmware upgrade interface, DC power interface	
Transmission Range	Barrier-free environment 80M	
Transmission Delay	Zero latency (<1ms)	
Product Dimension	92.4*96.75*49.8mm	

Trademarks:

Sony is a trademark or registered trademark of Sony Corporation in the P.R.C. and other countries. All other corporate and product names and trademarks mentioned in this manual are the property of their.